



User Manual

## **Hilite Chair Knock Down**

# COMFORT AND EASE

KA582KD

Updated: April 2024

[helpis@alliedmedical.co.nz](mailto:helpis@alliedmedical.co.nz) | [www.alliedmedical.co.nz](http://www.alliedmedical.co.nz) | 0800 31 61 81



# Hilite Chair Knock Down

This chair features a Knock Down design that allows for adjustable width, ensuring a perfect fit.

It is equipped with full-length padded armrests for maximum comfort and a contoured backrest that enhances lumbar support. The fabric used is both anti-fungal and anti-bacterial, ensuring cleanliness and hygiene. Additionally, it has been tested for fire resistance and wear resistance, providing durability and safety. The seat height is adjustable, allowing for a customized seating experience. The new transit wheels make it easy to move around the house.



**New transit wheel**



**Knocks Down for easy transport**

## 2 Colours Available



Champagne

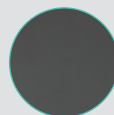

Greystone

## Features

- Width adjustable design
- Very sturdy and durable
- Anti fungal & anti bacterial fabric
- Tool-less assembly
- Easy transit wheels

Specifications	Max Seat Width	Min Seat Width	Max Seat Height	Min Seat Height	Max Seat Depth	Min Seat Depth	Max User Weight
<b>Hilite Chair Standard Knock Down Greystone</b> KA582KDG05-200kg	550mm	490mm	580mm	430mm	500mm	480mm	200kg
<b>Hilite Chair Standard Knock Down Champagne</b> KA582KDV03-200kg	550mm	490mm	580mm	430mm	500mm	480mm	200kg

# Safety Precautions

## Safety Warnings

1. Do not exceed the maximum user weight.
2. Ensure that the leg adjusting pins are fully engaged before use.  
(See image B). Failure to observe these warnings may result in serious injury.
3. Periodically inspect the assembly fasteners to ensure that they are tight.

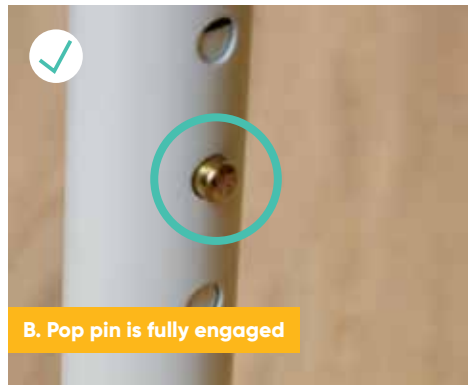
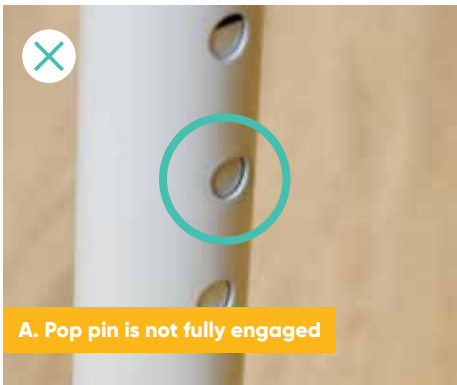

# Assembly

## Step 01

Unpack the contents of the box and check there are no missing parts.  
The box should contain.



If there are any parts missing, please contact the K Care Customer Service Team on: 1300 783 783.

### Step 02

Flip the seat and armrest upside down and insert each armrest into the tubing on the underside of the seat.



### Step 03

Make sure the hole in each armrest lines up with the corresponding hole on the tube located beneath the seat. Secure it by screwing in the thumbscrew. Avoid over-tightening.

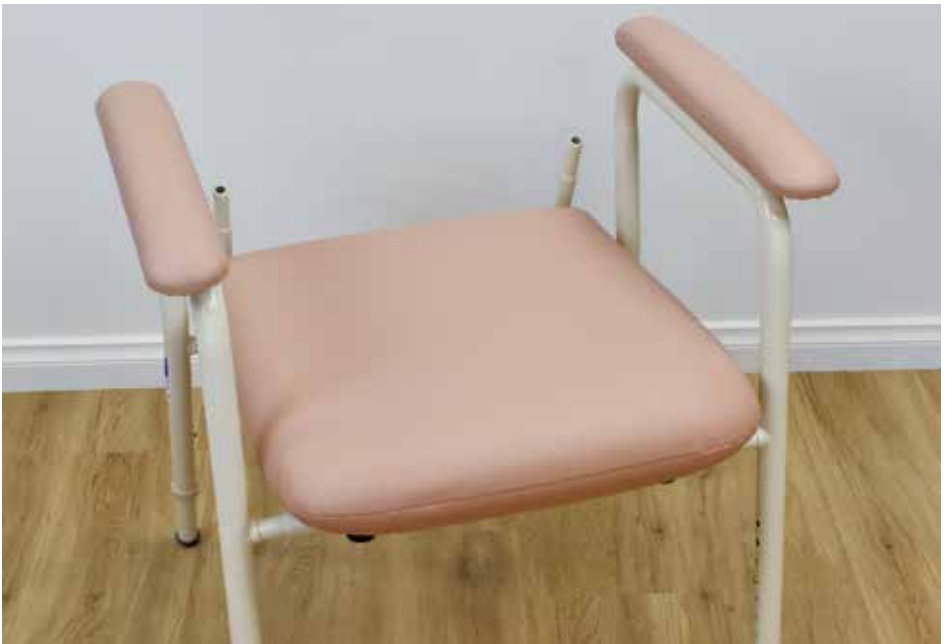

# Adjusting Seat Width

## Step 01

In order to adjust the seat width, slide each spacer over the two ends of both armrests.



## Step 02

Insert both armrests by sliding the ends through the tubing located on the underside of the seat.



## Step 03

Ensure the thread hole in each armrest lines up with the holes on the tube located on the underside of the seat. Screw in the thumbscrew. Do not over tighten.



## Insert Backrest

### Step 01

There are two holes at the end of the backrest, line up with the tubing ends on the seat.



### Step 02

Press down firmly to slide into place.





# Adjusting Height

## Step 01

To adjust the height, press down on the pin and slide the inner tubing to the preferred height.



**Check that all safety pins are engaged, failure to do so may result in serious injury.**



## **Cleaning and Maintenance**

The Hilite Chair can be cleaned with a low strength detergent, warm water and a soft textured cloth.