

Seating System Armrests IPB, International

Illustrated Parts Breakdown

USA - Quantum Rehab

401 York Avenue
Duryea, Pa 18642
www.quantumrehab.com

USA - Pride Mobility Products Corp.

182 Susquehanna Avenue
Exeter, Pa 18643
www.pridemobility.com

Canada

5096 South Service Road
Beamsville, Ontario L0R 1B3
www.pridemobility.ca
www.quantumrehab.com

Australia

20-24 Apollo Drive
Hallam, Victoria 3803
www.pridemobility.com.au
www.quantumrehab.com.au

New Zealand

38 Lansford Crescent
Avondale, Auckland 0600
www.pridemobility.co.nz

UK

32 Wedgwood Road
Bicester, Oxfordshire OX26 4UL
www.pride-mobility.co.uk
www.quantumrehab.co.uk

Netherlands

(Authorised EU Representative)

De Zwaan 3
1601 MS Enkhuizen
www.pridemobility.eu
www.quantumrehab.eu

Italy

Via del Progresso, ang. Via del Lavoro
Loc. Prato della Corte
00065 Fiano Romano (RM)
www.pride-italia.it
www.quantumrehab-italia.it

France

26 Rue Monseigneur Ancel
69800 Saint-Priest
www.pridemobility.fr
www.quantumrehab.fr

Spain

Calle Las Minas Número 67
Polígono Industrial Urtinsa II, de Alcorcón
28923 Madrid

Germany

Hövelrieger Str. 28
33161 Hövelhof

China

Room 508, Building #4
TianNa Business Zone
No. 500 Jianyun Road
Pudong New Area
Shanghai 201318



1.1. Version 3 Flip-back Armrest and Pads

Version 3 Flip-back Armrests	1
Armpads and Mounting Options, Version 3 Flip-back Arms	3
Down Post Assemblies - Version 3 Flip-back Arms	5
Appendix A:Pages Index	7
Appendix B:Parts Index	8

1.1. Version 3 Flip-back Armrest and Pads

Complete Assy
12"-22"W x 8"-16"H

A1a	Right
A1b	Left

Includes all mounting hardware

Complete Assy
22"-26"W x 8"-16"H

B1a	Right
B1b	Left

Includes all mounting hardware

Complete Assy
26"-32"W x 8"-16"H

C1a	Right
C1b	Left

Includes all mounting hardware

Armrest Only 12"-22"W

D1a	Right
D1b	Left

Does not include M1

Armrest Only 22"-26"W

E1a	Right
E1b	Left

Does not include M1

Armrest Only 26"-32"W

F1a	Right
F1b	Left

Does not include M1

Articulating Linkage

G1a	Right
G1b	Left

The articulating linkages are not width dependent and are used across all armrest assemblies.

Includes I1, J1, K1, & N1.
Does not include H1 or M1

Serviceable Components

The 2 Hole T-nut is included with the complete armrest assy's (A1a - C1b) and the articulating linkages (G1a / G1b). It is not available individually.

Wire Guide Mounting Location

Please note:
Only serviceable parts contain callouts. For all other parts the complete assembly must be selected.

Item	Part No.	Name	Qty
A1a	ARM1806663	ARMREST,ASSY,12"W-22"W,8"H-16"H,RIGHT,FLIP-BACK	1
A1b	ARM1806662	ARMREST,ASSY,12"W-22"W,8"H-16"H,LEFT,FLIP-BACK	1
B1a	ARM2004693	ARMREST,ASSY,22"W-26"W,8"H-16"H,RIGHT,FLIP-BACK	1
B1b	ARM2004694	ARMREST,ASSY,22"W-26"W,8"H-16"H,LEFT,FLIP-BACK	1
C1a	ARM2004695	ARMREST,ASSY,26"W-32"W,8"H-16"H,RIGHT,FLIP-BACK	1
C1b	ARM2004696	ARMREST,ASSY,26"W-32"W,8"H-16"H,LEFT,FLIP-BACK	1
D1a	MEC1610914	ARM ASSEMBLY, SYMPHONY, RIGHT	1
D1b	MEC166472	ARM ASSEMBLY, SYMPHONY, LEFT	1
E1a	MEC1807228	ARM ASSEMBLY, MEDIUM, SYMPHONY, RIGHT	1
E1b	MEC1807227	ARM ASSEMBLY, MEDIUM, SYMPHONY, LEFT	1
F1a	MEC1807230	ARM ASSEMBLY, LONG, SYMPHONY, RIGHT	1
F1b	MEC1807229	ARM ASSEMBLY, LONG, SYMPHONY, LEFT	1
G1a	MEC1612355	ARTICULATION LINKAGE, RIGHT, SYMPHONY	1
G1b	MEC1612354	ARTICULATION LINKAGE, LEFT, SYMPHONY	1
H1	HDW124866	SCREW, LOW SOCKET HEAD, M8X1.25 X 25, DIN 7984, CL 10.9, BZ, PVTP	1
I1	SCRHHCS1412	SCREW, HEX HEAD, M8X1.25 X 16, ISO 4014, CL 10.9, BZ, PVTP	2
J1	HDW133622	SCREW, LOW SOCKET HEAD, M8X1.25 X 20, DIN 7984, CL 8.8, BZ, PVTP	1
K1	NUT8120005	NUT,T-SLOT,BLACK,M8-1.25	1
L1	ARM1807658	WIRE ROUTING,FLIP-BACK ARMREST,W/HARDWARE	1
M1	HDW1700856	SCREW, SOCKET LOW HEAD, M12X1.75 X 35, CL 10.9, BZ, PVTP (DWG 1700856)	1
N1	HDW166689	SCREW, SOCKET LOW HEAD, M12X1.75 X 50, CL 10.9, BZ, PVTP	1

1.1. Version 3 Flip-back Armrest and Pads

<div>A1 - A4</div> <div>Complete 10" Armpad Assy</div>	<div>B1 - B4</div> <div>Complete 14" Armpad Assy</div>	<div>C1 - C4</div> <div>Complete 17" Armpad Assy</div>
<div>D1 - D3</div> <div>Complete 10" Gel Armpad Assy</div>	<div>E1 - E3</div> <div>Complete 14" Gel Armpad Assy</div>	<div>10" Waterfall Armpad w/ Tube Mount</div>
<div>14" Waterfall Armpad w/ Tube Mount</div>	<div>Tube Mount Assembly Breakdown</div> <p>*Please note: The tube support assemblies (F1) & (G1) may need to be reassembled for the left and right sides as shown.</p> <p>**The gel armpads (D1) & (E1) can mount to the tube mount assemblies (F1) & (G1). Configuration is non-serviceable, please contact Technical Service for mounting options.</p> <div>Left</div> <div>Right</div>	

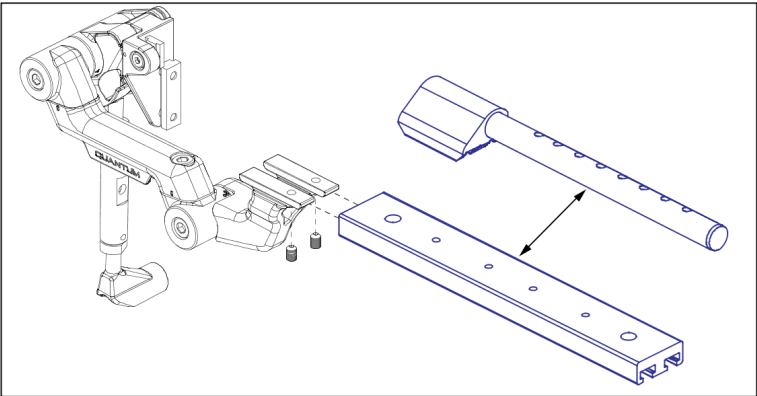



Item	Part No.	Name	Qty
A1 - A4	ARM1807650	ARM PAD,ASSY,10" EXTRUSION,LEFT/RIGHT,FLIP-BACK ARMREST	1
A1	DGN1801407	OVERMOLD ASSEMBLY, ARMREST, 10-INCH	1
A2	MEC1700306	ARM REST PAD EXTRUSON, 10 INCH, SYM	1
A3	SCRPPH1318	SCREW, PAN HEAD, TYPE H, M4X0.7 X 16, FT, ISO 7045, CL 4.8, BZ	2
A4	DGN168855	END CAP, ARMREST	1
B1 - B4	ARM1807652	ARM PAD,ASSY,14" EXTRUSION,LEFT/RIGHT,FLIP-BACK ARMREST	1
B1	DGN1801411	OVERMOLD ASSEMBLY, ARMREST, 14-INCH	1
B2	MEC163649	ARM REST PAD EXTRUSON, 14 INCH, SYM	1
B3	SCRPPH1318	SCREW, PAN HEAD, TYPE H, M4X0.7 X 16, FT, ISO 7045, CL 4.8, BZ	2
B4	DGN168855	END CAP, ARMREST	1
C1 - C4	ARM1807653	ARM PAD,ASSY,17" EXTRUSION,LEFT/RIGHT,FLIP-BACK ARMREST	1
C1	DGN1801530	OVER-MOLD ASSEMBLY, ARMREST, 17-INCH	1
C2	MEC1700307	ARM REST PAD EXTRUSON, 17 INCH, SYM	1
C3	SCRPPH1318	SCREW, PAN HEAD, TYPE H, M4X0.7 X 16, FT, ISO 7045, CL 4.8, BZ	2
C4	DGN168855	END CAP, ARMREST	1
D1 - D3	ARM1807656	ARM PAD,ASSY,10" GEL BLACK,LEFT/RIGHT,FLIP-BACK ARMREST	1
D1	ARM136409	ARMPAD,GEL,BLACK,10"L,DESK LENGTH,(310G)	1
D2	MEC1700306	ARM REST PAD EXTRUSON, 10 INCH, SYM	1
D3	SCRASBH1155	SCREW,BHSCS,BLACK ZINC,10-32 X 1.00",W/NYLON PATCH	2
E1 - E3	ARM1807657	ARM PAD,ASSY,14" GEL BLACK,LEFT/RIGHT,FLIP-BACK ARMREST	1
E1	ARM136408	ARMPAD,GEL,BLACK,14",FULL LENGTH,(314G)	1
E2	MEC163649	ARM REST PAD EXTRUSON, 14 INCH, SYM	1
E3	SCRASBH1155	SCREW,BHSCS,BLACK ZINC,10-32 X 1.00",W/NYLON PATCH	2
F1	ARM1807648	ARM PAD,ASSY,10" TUBE SUPPORT,LEFT/RIGHT,FLIP-BACK ARMREST	1
G1	ARM1807647	ARM PAD,ASSY,14" TUBE SUPPORT,LEFT/RIGHT,FLIP-BACK ARMREST	1
H1	SETLRAM1164	ARMPAD,ASSY,WATERFALL,BLACK,9", DESK LENGTH	1
I1	SETLRAM1165	ARMPAD,ASSY,WATERFALL,BLACK,14", FULL LENGTH	1
J1	SCRASBH1052	SCREW,BHSCS,BLACK ZINC,10-32 X 1.50"	2
K1	WASSAE1005	WASHER,FLAT,ZINC,#10,0.2812" ID X 0.50" OD X 0.0468" TH,SAE	2

1.1. Version 3 Flip-back Armrest and Pads

	Complete Assemblies		Receiver Block (included w/ the complete assy's)	
Height	Left	Right	Left	Right
8" – 10"H *	A1a	A1b	D1b	D1a
11" – 13"H	B1a	B1b	D1a	D1b
14" – 16"H	C1a	C1b	D1a	D1b

Right Side Complete Assemblies Shown

8"-10"H

11"-13"H

14"-16"H

***Note:** The receiver block configuration is reversed on the 8 – 10"H assemblies. Receiver "A" is installed on the right and receiver "B" is installed on the left. For 11" – 16" H assemblies the forward configuration is used. The complete assemblies come with the appropriate receiver.

Serviceable Components

Diagram illustrating the serviceable components and assembly configurations for the flip-back armrests. Components shown include H1, G1, F1, E1a, I1, and E1b. The diagram also shows the Receiver Block and its orientation for different heights.

Reverse Receiver "B" Front Back 8" – 10"H Receiver "A"

Forward Receiver "A" Front Back 11" – 16"H Receiver "B"



Item	Part No.	Name	Qty
A1a	MEC2004721	DOWN POST,ASSY,LEFT,SMALL,TRU-BALANCE 3 ARMREST	1
A1b	MEC2004722	DOWN POST,ASSY,RIGHT,SMALL,TRU-BALANCE 3 ARMREST	1
B1a	MEC2004724	DOWN POST,ASSY,LEFT,MEDIUM,TRU-BALANCE 3 ARMREST	1
B1b	MEC2004726	DOWN POST,ASSY,RIGHT,MEDIUM,TRU-BALANCE 3 ARMREST	1
C1a	MEC2004729	DOWN POST,ASSY,LEFT,LARGE,TRU-BALANCE 3 ARMREST	1
C1b	MEC2004728	DOWN POST,ASSY,RIGHT,LARGE,TRU-BALANCE 3 ARMREST	1
D1a	MEC1709470	LOCKING RECEIVER BLOCK ASSEMBLY A	1
D1b	MEC1900745	LOCKING RECEIVER BLOCK ASSEMBLY B	1
E1a	MEC1804224	UPPER HINGE ASSEMBLY, SUPPORT COLUMN	1
E1b	MEC1805503	LOWER HINGE ASSEMBLY, SUPPORT COLUMN	1
F1	MEC1713949-S	ADJUSTMENT ROD, SMALL, SUPPORT COLUMN (DWG 1713949)	1
G1	MEC1713949-M	ADJUSTMENT ROD, MEDIUM, SUPPORT COLUMN (DWG 1713949)	1
H1	MEC1713949-L	ADJUSTMENT ROD, LARGE, SUPPORT COLUMN (DWG 1713949)	1
I1	HDW1901907	SCREW, BUTTON HEAD, M6X1.0 X 22, ISO 7380-1, CL 10.9, BZ, PVTP	2

Appendix A:Pages Index

Armpads and Mounting Options, Version 3 Flip-back Arms	3
Down Post Assemblies - Version 3 Flip-back Arms	5
Version 3 Flip-back Armrests	1

Appendix B:Parts Index

ARM136408	4
ARM136409	4
ARM1806662	2
ARM1806663	2
ARM1807647	4
ARM1807648	4
ARM1807650	4
ARM1807652	4
ARM1807653	4
ARM1807656	4
ARM1807657	4
ARM1807658	2
ARM2004693	2
ARM2004694	2
ARM2004695	2
ARM2004696	2
DGN168855	4, 4, 4
DGN1801407	4
DGN1801411	4
DGN1801530	4
HDW124866	2
HDW133622	2
HDW166689	2
HDW1700856	2
HDW1901907	6
MEC1610914	2
MEC1612354	2
MEC1612355	2
MEC163649	4, 4
MEC166472	2
MEC1700306	4, 4
MEC1700307	4
MEC1709470	6
MEC1713949-L	6
MEC1713949-M	6
MEC1713949-S	6
MEC1804224	6
MEC1805503	6
MEC1807227	2
MEC1807228	2
MEC1807229	2
MEC1807230	2
MEC1900745	6
MEC2004721	6
MEC2004722	6
MEC2004724	6
MEC2004726	6
MEC2004728	6
MEC2004729	6
NUT8120005	2

SCRASBH1052	4
SCRASBH1155	4, 4
SCRHHCS1412	2
SCRPPH1318	4, 4, 4
SETLRAM1164	4
SETLRAM1165	4
WASSAE1005	4

Illustrated Parts Breakdown

USA - Quantum Rehab

401 York Avenue
Duryea, Pa 18642
www.quantumrehab.com

USA - Pride Mobility Products Corp.

182 Susquehanna Avenue
Exeter, Pa 18643
www.pridemobility.com

Canada

5096 South Service Road
Beamsville, Ontario L0R 1B3
www.pridemobility.ca
www.quantumrehab.com

Australia

20-24 Apollo Drive
Hallam, Victoria 3803
www.pridemobility.com.au
www.quantumrehab.com.au

New Zealand

38 Lansford Crescent
Avondale, Auckland 0600
www.pridemobility.co.nz

UK

32 Wedgwood Road
Bicester, Oxfordshire OX26 4UL
www.pride-mobility.co.uk
www.quantumrehab.co.uk

Netherlands

(Authorised EU Representative)

De Zwaan 3
1601 MS Enkhuizen
www.pridemobility.eu
www.quantumrehab.eu

Italy

Via del Progresso, ang. Via del Lavoro
Loc. Prato della Corte
00065 Fiano Romano (RM)
www.pride-italia.it
www.quantumrehab-italia.it

France

26 Rue Monseigneur Ancel
69800 Saint-Priest
www.pridemobility.fr
www.quantumrehab.fr

Spain

Calle Las Minas Número 67
Polígono Industrial Urtinsa II, de Alcorcón
28923 Madrid

Germany

Hövelrieger Str. 28
33161 Hövelhof
www.pridemobility.de

China

Room 508, Building #4
TianNa Business Zone
No. 500 Jianyun Road
Pudong New Area
Shanghai 201318

