

Only serviceable components contain callouts. For components without callouts the complete assembly must be selected.

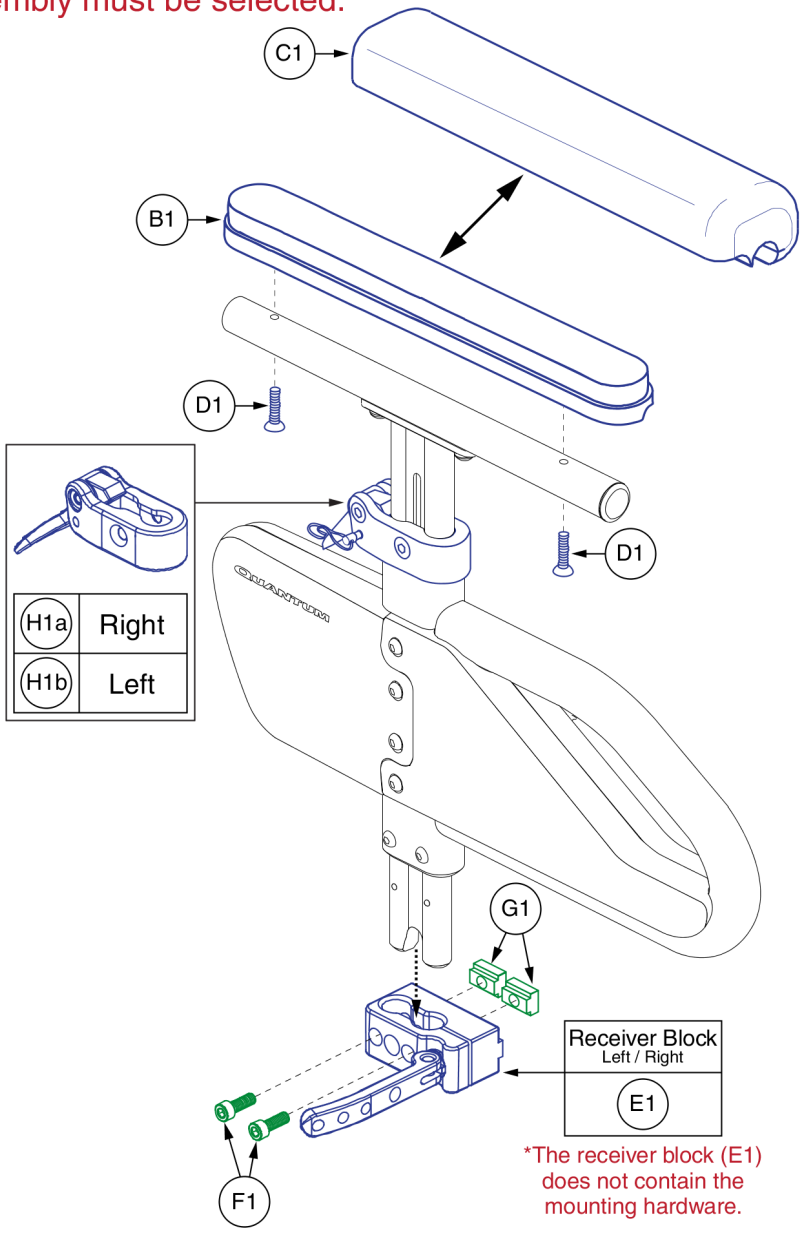
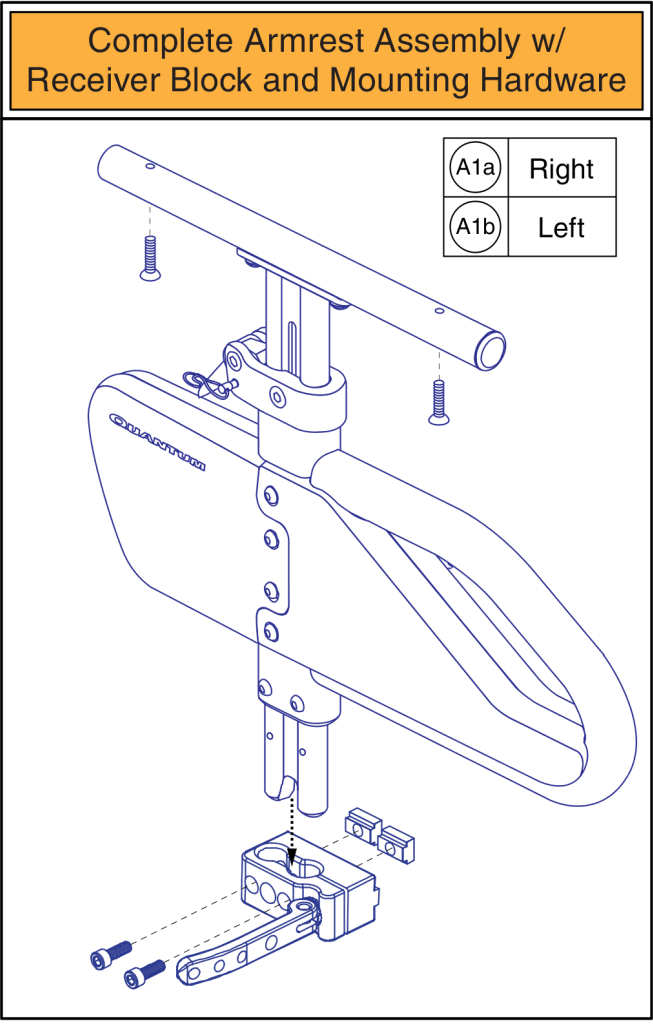

Item	Part No.	Name	Qty
A1a	FRMASMB8595	ARMREST,SINGLE POST HEIGHT ADJUSTABLE,FULL LENGTH,RIGHT	1
A1b	FRMASMB8594	ARMREST,SINGLE POST HEIGHT ADJUSTABLE,FULL LENGTH,LEFT	1
B1	SETLRAM1116	ARMREST,PAD,LONG,QUANTUM,V2	1
C1	SETLRAM1165	ARMPAD,ASSY,WATERFALL,BLACK,14", FULL LENGTH	1
D1	SCRSHFH1081	SCREW,SHFH,BLACK ZINC,10-32 X 0.75",GRADE 8,W/NYLON PATCH	2
E1	FRMASMB8586	ARMREST,ASSY,RECEIVER BLOCK,QUANTUM SINGLE POST HEIGHT ADJUSTABLE,D-1354-019	1
F1	SCRSHCS1005	SCREW, SHCS,BLACK ZINC,1/4-20 X 0.75"	2
G1	DWR1360A002	T-NUT,1/4-20 X 0.5625",A-1360-002	2
H1a	FRMASMB8831	LEVER,ASSY,MOLDED,QUAD RELEASE,RIGHT	1
H1b	FRMASMB8830	LEVER,ASSY,MOLDED,QUAD RELEASE,LEFT	1