

ottobock.

Kimba neo

Service manual



Table of contents

1	Introduction	4
1.1	Foreword	4
1.2	Support	4
1.3	Product Overview	5
2	Safety.....	8
2.1	Explanation of warning symbols	8
2.2	General safety instructions	8
3	Service Work	8
3.1	General Information	8
3.2	Instructions for Adjustment.....	9
3.3	Maintenance Schedule	9
3.4	Required Tools and Accessories.....	9
3.5	Outdoor Mobility Base.....	9
3.5.1	Rear Wheels	9
3.5.1.1	Replacing the Rear Wheel	9
3.5.1.2	Replacing the Casing	10
3.5.1.3	Replacing the Tube (Pneumatic Tyre)	10
3.5.2	Front Wheels.....	10
3.5.2.1	Replacing a "Fixed" Front Wheel	10
3.5.2.2	Replacing a "Swivelling" Front Wheel	10
3.5.2.3	Replacing the Caster Fork	10
3.5.2.4	Replacing the Swivel Lock	11
3.5.2.5	Replacing the Casing	11
3.5.2.6	Replacing the Tube (Pneumatic Tyre)	12
3.5.3	Seat Adapter	12
3.5.3.1	Replacing the Seat Adjustment Mechanism (Porter Cylinder)	12
3.5.3.2	Replacing the Seat Adapter (Tilt Activation on Standard Seat)	13
3.5.4	Suspension/Rear Wheel Linkage	14
3.5.4.1	Replacing the Suspension.....	14
3.5.4.2	Adjusting the suspension	14
3.5.4.3	Replacing the Complete Rear Wheel Linkage (incl. Wheel Lock)	15
3.5.4.4	Replacing the Rear Wheel Linkage (Individual)	15
3.5.5	Frame.....	16
3.5.5.1	Replacing the Front Frame.....	16
3.5.5.2	Replacing the Upper Front Frame	17
3.5.5.3	Replacing the Front Frame (Complete).....	18
3.5.5.4	Replacing the Folding Tube.....	18
3.5.5.5	Replacing the fixed tube head.....	19
3.5.6	Push Bar.....	21
3.5.6.1	Replacing the Ratchet Joints with Folding Fixture.....	21
3.5.6.2	Replacing the Push Bar	22
3.6	Multifunctional Seating Unit (Standard Seat)	22
3.6.1	Pads/Covers	22
3.6.1.1	Replacing the Seat Pad	22
3.6.1.2	Replacing the Backrest Pad	22
3.6.1.3	Replacing the Covers	23
3.6.1.4	Replacing the Grab Rail Cover (Option).....	24
3.6.1.5	Replacing the Frame Padding (Option).....	24
3.6.2	Back.....	25
3.6.2.1	Replacing the Back Insert	25
3.6.2.2	Replacing the Knob.....	26
3.6.2.3	Removing/Installing the Tilt Activation Mechanism.....	27
3.6.2.4	Replacing the Back Frame (Complete)	28
3.6.2.5	Installing/removing the seat depth reducer	29

3.6.3	Footplate/Knee Angle Assembly	30
3.6.3.1	Replacing the Foot Plate	30
3.6.3.2	Replacing Small Parts on the Footplate	30
3.6.3.3	Replacing the Knee Angle Assembly (Complete).....	31
3.6.3.4	Replacing the Footplate Adapter	31
3.6.3.5	Replacing the "Seat Adjuster"	32
3.6.4	Base Frame (Seat Frame)	32
3.6.4.1	Replacing the Base Frame (Tilt Activation Mechanism on Seat)	32
3.6.5	Supports.....	33
3.6.5.1	Replacing the Headrest Supports	33
3.6.5.2	Replacing the Thoracic Supports	34
3.6.5.3	Replacing the Hip Supports	34
3.6.5.4	Replacing the Lateral Supports.....	35
4	Installing other options/accessories.....	37
4.1	Safety belts	37
4.1.1	Strap guide	37
4.1.2	Lap belt	37
4.1.3	Four-point belt.....	39
4.1.4	Five-point belt.....	40
4.2	Positioning aids	42
4.2.1	Abductor.....	42
4.2.2	Pelvic band	42
4.2.3	Chest and shoulder support	43
4.2.4	Fixation vest	44
4.2.5	Groin strap.....	45
4.2.6	Neck support.....	46
4.2.7	Lumbar padding	46
4.2.8	Hook-and-loop foot straps	47
4.3	Armrests	47
4.4	Tip-assist	48
4.5	Tray.....	48
4.6	Storage bag	49
4.7	Platform for respirator	49
4.7.1	Installation with a seat facing opposite to direction of travel	51
4.7.2	Installation with a seat facing in the direction of travel	52
4.8	Canopy adapter	53
4.9	Canopy.....	54
4.10	Rain cover	55
4.11	Summer/winter slip sack.....	55
4.12	Footrest padding	55
4.13	Anti-slip lining.....	56
4.14	Foot block for shortening the lower leg length	56
4.15	Incontinence cover	56
5	Appendices	59
5.1	Technical data	59
5.2	Maintenance Schedule	60
5.2.1	Maintenance Schedule – Outdoor Mobility Base	60
5.2.2	Seating Unit Maintenance Schedule	61

1 Introduction

1.1 Foreword

- Regular maintenance is important – it improves safety and increases the lifespan of the product.
- All Mobility products should be inspected and serviced once a year.
- However, we recommend inspecting, readjusting, and if necessary servicing the product every **6 months** if the product is used frequently, by growing children or by users with changing clinical conditions.
- Only use original spare parts for all service and maintenance work. The service and maintenance tasks described here should only be completed by trained, qualified personnel and not by the user of the device.
- This service and maintenance manual refers to the respective spare parts catalogues and the instructions for use of the described products. Please use these documents together.
- Use the maintenance schedule (checklist) as a template for making copies. Retain completed maintenance schedules and provide the customer with a copy.

	Instructions for use	Instructions for use (qualified personnel)	Instructions for use (user)
Kimba Neo seating unit	---	647G893	647G892
Kimba Neo mobility base (with Kimba Cross; Kimba Inline)	647G891	---	---

1.2 Support

Your national Ottobock team will be happy to answer any technical questions. The contact addresses and telephone numbers can be found on the back inside cover of the service manual.

1.3 Product Overview



Kimba Neo – outdoor mobility base with multifunctional seating unit and "swiveling" front wheels option

1	Plug-on rear wheel	6	Angle adjustable backrest
2	"Swivelling" front wheel (option)	7	Adjustable push bar
3	Front lashing point	8	Release handle, folding mechanism
4	Adjustable footrest	9	Rear lashing point
5	Removable seat with lateral supports	10	Suspension



Kimba Neo – outdoor mobility base for alternative seating systems with "swivelling" front wheels option

1	Plug-on rear wheel	6	Adjustable push bar
2	"Swivelling" front wheel (option)	7	Release handle, folding mechanism
3	Swivel lock	8	Separate seat angle adjustment on frame
4	Front lashing point	9	Rear lashing point
5	Seat adapter	10	Suspension



Kimba Neo – outdoor mobility base with "fixed" front wheels

1	Plug-on rear wheel	5	Adjustable push bar
2	Plug-on "fixed" front wheel	6	Release handle, folding mechanism
3	Front lashing point	7	Suspension
4	Seat adapter	8	Rear lashing point

2 Safety

2.1 Explanation of warning symbols

⚠ WARNING	Warning regarding possible serious risks of accident or injury.
⚠ CAUTION	Warning regarding possible risks of accident or injury.
NOTICE	Warning regarding possible technical damage.

2.2 General safety instructions

⚠ CAUTION
Failure to observe installation instructions
Pinching, crushing due to installation errors

- ▶ Do not reach between force-actuated surfaces during installation work (e.g. when tightening screw connections).

⚠ CAUTION
Use of unsuitable tools
Pinching, crushing or damaging the product due to use of unsuitable tools

- ▶ When completing the tasks, only use tools that are suitable for the conditions at the place of work and for which safety and the protection of health are assured with proper use.
- ▶ Observe the specifications in the section "Required Tools".

⚠ CAUTION
Re-use of self-locking nuts
Tipping over, falling of the user due to unintended loosening of the screw connections

- ▶ Always replace self-locking nuts with new self-locking nuts after disassembly.

NOTICE
Tipping or falling of the product
Damage to product due to lack of attachment

- ▶ When you work on the product, secure it so that it cannot tip over or fall over.
- ▶ Use a clamping fixture to secure the product whenever you work on it at a workbench.

3 Service Work

3.1 General Information

INFORMATION
Read the service manual before starting work. Familiarise yourself with the functions of the product prior to inspection and use. In order to do so, you can request this service manual and other documentation from the manufacturer (see the overview of national Ottobock branches on the inside of the back cover) or download from our homepage www.ottobock.de or www.ottobock.com.

INFORMATION
Clean and disinfect the product before commencing service work.
Observe all care instructions and product-specific inspection instructions in the instructions for use.

INFORMATION
Many screw connections utilise screws and nuts equipped with thread lock. If you loosen screw connections, be sure to replace the respective nut or screw with one equipped with a new thread lock. If new screws or nuts with thread lock are not available, apply a medium-strength liquid thread locking compound (such as Loctite® 241 or Euro Lock A24.20) to the existing screws.

3.2 Instructions for Adjustment

⚠ WARNING

Failure to verify tipping resistance

Risk of the user falling or tipping over

- ▶ Changing the settings can lead to instability of the system as a whole. Verify tipping resistance after any changes to the settings.

The sections that follow describe the replacement and retrofitting of standard and option parts on the product shown on the cover.

All instructions concerning the adjustment of the parts installed are included in the Instructions for Use (qualified personnel) – see the section "Foreword" for the order number.

3.3 Maintenance Schedule

Maintenance schedule as a template for copying: see Page 60.

3.4 Required Tools and Accessories

The following tools are required in order to perform the service work:

- Reversible ratchet handle wrench and sockets (size: 8 – 24)
- Torque wrench (measurement range 5 - 50 Nm)
- Wrench (size: 8 – 24)¹⁾
- Allen wrench (size: 2.5 – 6)²⁾
- Screwdriver (blade width: 2.5/3.5/5 mm)
- Phillips head screwdriver (size: 2)
- Hammer (approx. 300 g); soft-faced hammer
- Pliers: cutting pliers, combination pliers, snap ring pliers
- Rivet gun (for rivets up to \varnothing 5 mm)
- Pin punch, \varnothing 3/4/5/6 mm
- Drill/twist drill \varnothing 3.2/5/5.2/6 mm
- Stanley knife with sickle hooked blade and standard blade
- Tyre mounting levers and inner tube repair kit*
- Workbench and vice with plastic jaws and rubber insert
- Measurement equipment: rule, spirit level
- Liquid thread locker, "medium" and "strong"

¹⁾ Included in 481C08=ST010 Tool Set

²⁾ Size 3 – 6 contained in the 481C08=ST010 Tool Set

3.5 Outdoor Mobility Base

3.5.1 Rear Wheels

3.5.1.1 Replacing the Rear Wheel

- 1) Release the wheel lock.
- 2) Press down the lock on the rear wheels (see fig. 4).
- 3) Replace and reinstall the wheel. The locking mechanism must engage audibly.

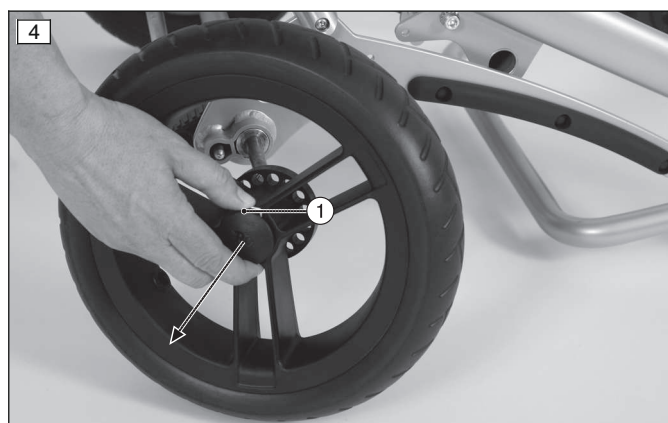

3.5.1.2 Replacing the Casing

Replacing the casing on the rear wheel (see fig. 6, Pos. 1) corresponds to replacing the casing on the caster wheel: see Page 11.

3.5.1.3 Replacing the Tube (Pneumatic Tyre)

Replacing the tube on the rear wheel (see fig. 6, Pos. 2) corresponds to replacing the tube on the caster wheel: see Page 12.

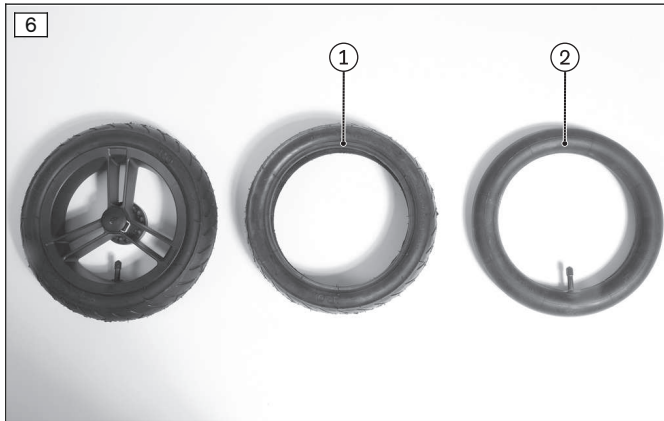

3.5.2 Front Wheels

3.5.2.1 Replacing a "Fixed" Front Wheel

- 1) After pushing down the locking mechanism, pull the front wheel off to the outside and replace it (not illustrated).
- 2) Slide on the front wheel. The locking mechanism must engage audibly.

3.5.2.2 Replacing a "Swivelling" Front Wheel

- 1) Put the frame on its side.
- 2) Remove the caster wheel axle in the caster fork (see fig. 7).
- 3) Remove and replace the caster wheel (see fig. 8).
- 4) Tighten the caster wheel axle to a torque of **9 Nm**.



3.5.2.3 Replacing the Caster Fork

- 1) Remove the caster wheel (see the preceding section).
- 2) Loosen the caster fork mounting screw (see fig. 9).
- 3) Remove and replace the caster fork (see fig. 10).
- 4) Install the caster fork with the supplied mounting materials.
- 5) Tighten the caster fork to a torque of **25 Nm**.



3.5.2.4 Replacing the Swivel Lock

- 1) Remove the caster wheel and caster fork (see the preceding sections; see fig. 11).
- 2) Slide the swivel lock off the front frame and replace it (see fig. 12).
- 3) Slide the swivel lock onto the front frame.
- 4) Install the caster fork and caster wheel (see the preceding section).

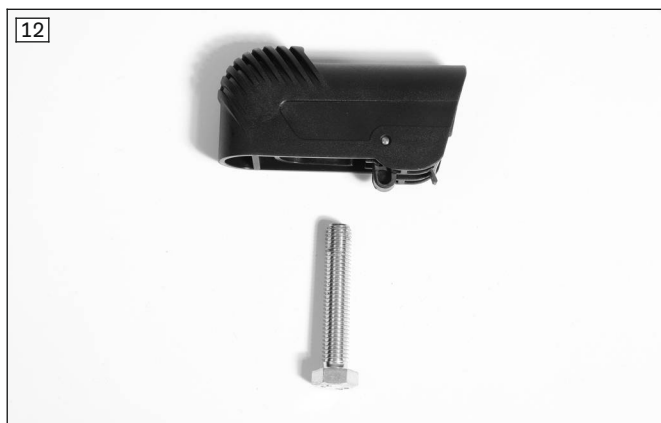

3.5.2.5 Replacing the Casing

- 1) Remove the wheel (see Page 10) and let out the air if required.
- 2) Using a tyre lever, remove the casing from the rim (see fig. 13).
- 3) Remove the tube.
- 4) Replace the casing (see fig. 14, Pos. 1).
- 5) Fill the inner tube with a small amount of air before mounting in order to avoid damage and pinching.
- 6) Install the casing on the rim with a tyre lever.
- 7) Reinstall the wheel (see Page 10).

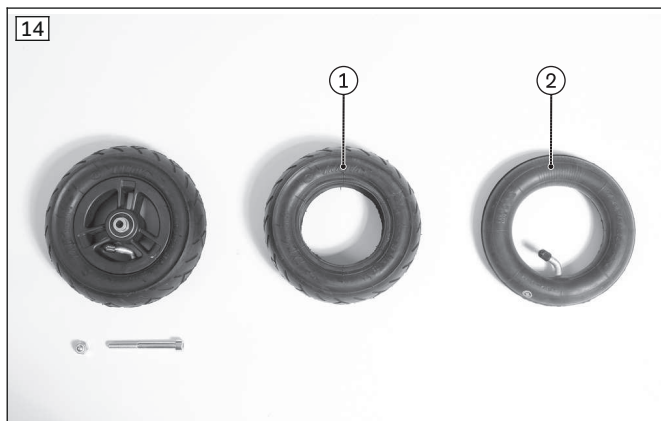

3.5.2.6 Replacing the Tube (Pneumatic Tyre)

- 1) Remove the wheel (see Page 10) and let out the air if required.
- 2) Using a tyre lever, remove the casing from the rim (see Page 11).
- 3) Replace or repair the tube (see fig. 14, Pos. 2; see fig. 15).
- 4) Fill the inner tube with a small amount of air before mounting in order to avoid damage and pinching.
- 5) Install the casing on the rim with a tyre lever.
- 6) Reinstall the wheel (see Page 10).



3.5.3 Seat Adapter

3.5.3.1 Replacing the Seat Adjustment Mechanism (Porter Cylinder)

- 1) Remove the Bowden cable from the porter cylinder:
 - Cut off the cable end sleeve (see fig. 16, Pos. 1).
 - Loosen the screw die.
 - Remove the spring and Bowden cable guide (see fig. 16, Pos. 2/3).
 - Unthread the Bowden cable on the Porter cylinder.
- 2) Unlock and remove the spring folding bolt on the Porter cylinder (see fig. 17, Pos. 1).
- 3) Remove the retaining ring (see fig. 17, Pos 2) and the bearing journal.
- 4) Remove and replace the Porter cylinder.
- 5) Install the Porter cylinder with the mounting materials provided (see fig. 18). Note the following:
 - Apply oil/grease to the bearing journal prior to installation (see fig. 18, Pos 1).
 - The piston rod of the Porter cylinder must not be lubricated (see fig. 18, Pos 2).
 - Note the Bowden cable guide between the seat adjustment mechanism and the Porter cylinder (see fig. 19, Pos. 1).
- 6) Conduct a functional test. Pay particular attention to the functionality of the seat tilt feature and the seat tilt mechanism in the tilted position.

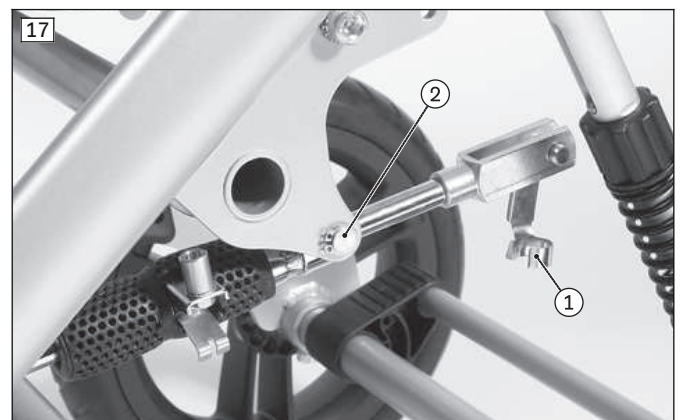
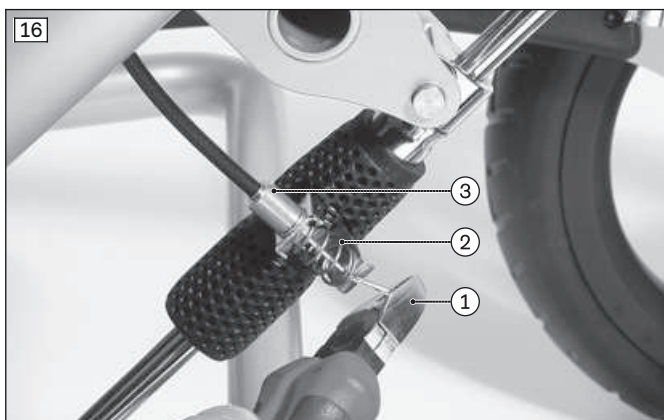

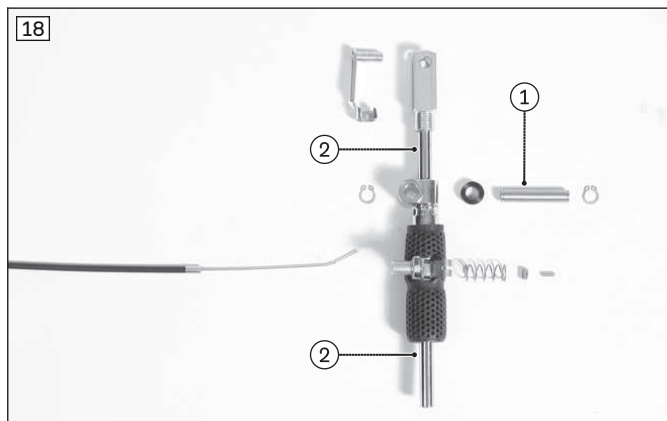

3.5.3.2 Replacing the Seat Adapter (Tilt Activation on Standard Seat)

INFORMATION

When replacing the seat adapter, the Bowden cable also has to be replaced. It is included with the mounting materials provided with the seat adapter (see fig. 23).

- 1) Remove the Bowden cable on the Porter cylinder (see Page 12).
- 2) Unlock and remove the spring folding bolt on the porter cylinder (see Page 12).
- 3) Remove the Bowden cable on the seat adapter (see fig. 20, Pos. 1).
- 4) Loosen the mounting screw on one side of the seat adapter (see fig. 21, Pos. 1).
- 5) Remove the screw; insert a mounting aid (M8 screw with counter nut) in place of the screw that was removed and install the counter nut (see fig. 22, Pos. 1).
- 6) Loosen the mounting screw on the other side.
- 7) Remove the disassembly aid.
- 8) Remove and replace the seat adapter.
- 9) Install the seat adapter with the mounting materials provided (see fig. 23). Tighten the seat adapter mounting screws to a torque of **20 Nm**:
- 10) Conduct a functional test. Pay particular attention to the functionality of the seat tilt feature and the seat tilt mechanism in the tilted position.

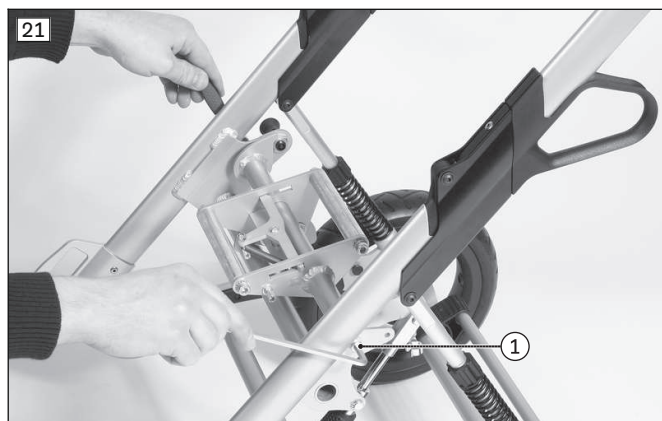

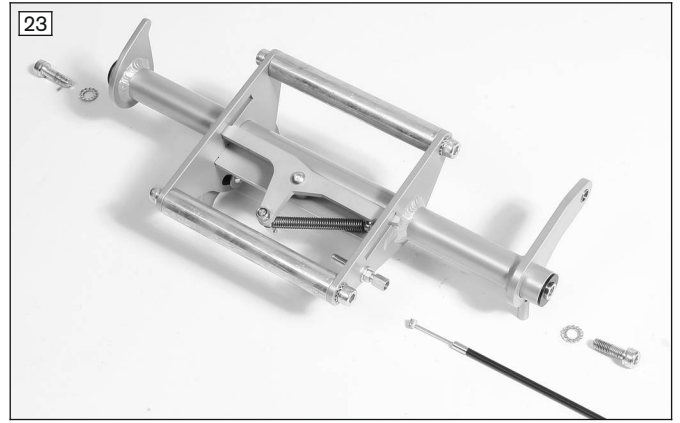
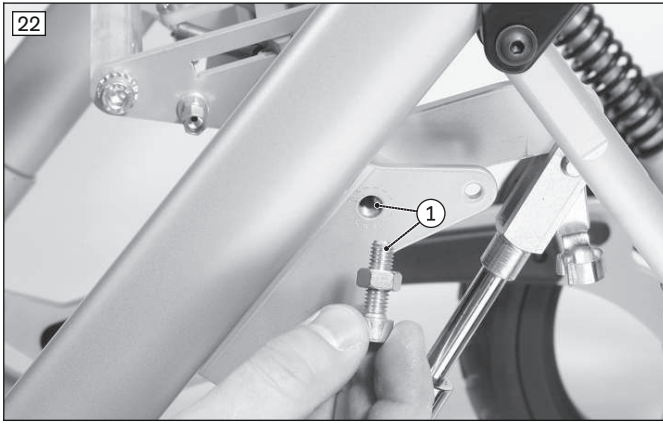

3.5.4 Suspension/Rear Wheel Linkage

3.5.4.1 Replacing the Suspension

- 1) Remove the plug-on rear wheel.
- 2) Put the frame on its side.
- 3) Loosen the suspension mounting screws (see fig. 24, Pos. 1).
- 4) Remove and replace the suspension.
- 5) Install the suspension with the mounting materials provided (see fig. 25). Tighten the mounting screws.
- 6) To adjust the spring force, see the following section.

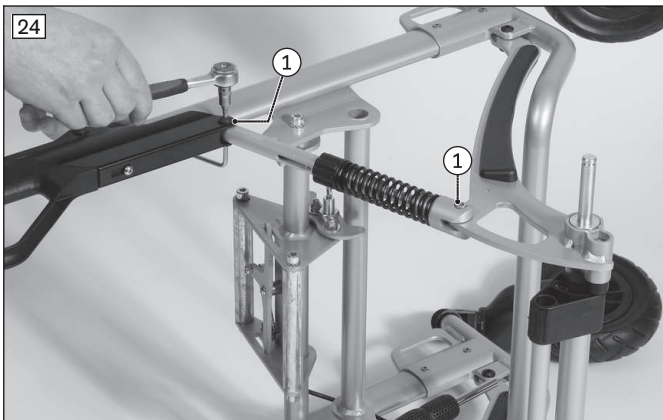

3.5.4.2 Adjusting the suspension

The suspension can be adjusted continuously according to the user's weight and the conditions of the road/surface:

- 1) Twist the adjustment rings on both sides of the frame equally (see fig. 26, item 1).
 - Clockwise: the suspension becomes tighter.
 - Counterclockwise: the suspension becomes softer.
- 2) Check that the adjustment rings are positioned the same on both sides. The 4 marks can be used for orientation (see fig. 26, item 2; see fig. 27, item 1).

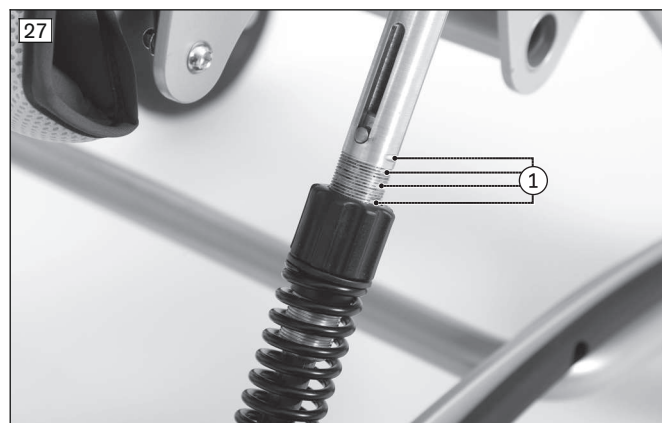
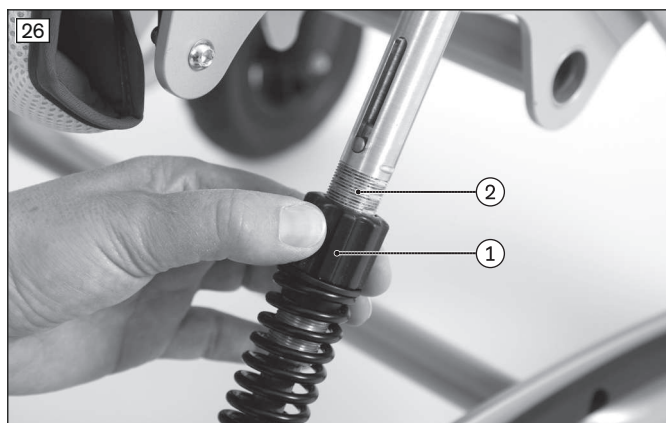

We recommend the following setting for the spring tension:

User weight	Marking*
up to 10 kg	up to 1st marking from the top
up to 20 kg	up to 2nd marking from the top
up to 30 kg	up to 3rd marking from the top
up to 40 kg	up to 4th marking from the top

* Reference point: upper edge of the plastic adjustment nut

3.5.4.3 Replacing the Complete Rear Wheel Linkage (incl. Wheel Lock)

- 1) Remove the plug-on rear wheel.
- 2) Put the frame on its side.
- 3) Loosen the mounting screws between the rear wheel linkage and suspension (see fig. 28, Pos. 1).
- 4) Loosen the mounting screws between the rear wheel linkage and lower front frame (see fig. 28, Pos. 2).
- 5) Remove and replace the assembly "rear wheel linkage with wheel lock" (see fig. 29).
- 6) Install the complete rear wheel linkage using the mounting materials provided (see fig. 29). Tighten the mounting screws.

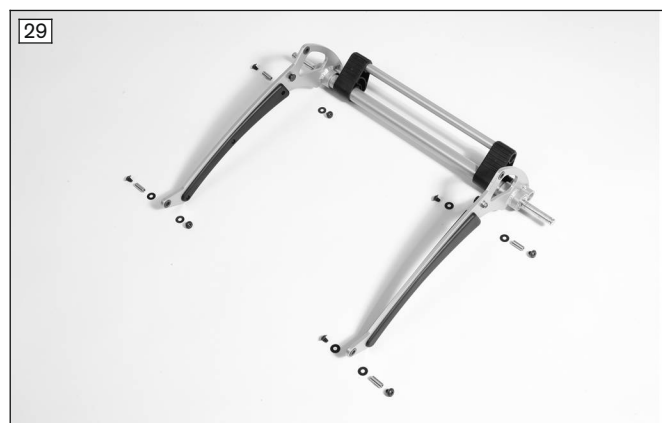

3.5.4.4 Replacing the Rear Wheel Linkage (Individual)

- 1) Remove the plug-on rear wheel.
- 2) Put the frame on its side.
- 3) Loosen the mounting screw between the rear wheel linkage and suspension (see fig. 30, Pos. 1).
- 4) Loosen the mounting screw between the rear wheel linkage and lower front frame (see fig. 30, Pos. 2).
- 5) Loosen the mounting screw on the axle stub (see fig. 30, Pos. 3).
- 6) Disengage and replace the rear wheel linkage (see fig. 31, Pos. 1). Ensure that the spring and lock bush of the wheel lock are not ejected (see fig. 31, Pos. 2).
- 7) Install the new rear wheel linkage with the mounting materials provided (see fig. 32). Ensure that the bore hole of the axle stub (see fig. 31, Pos. 3) fits flush with the mounting bore of the rear wheel linkage (see fig. 31, Pos. 4).
- 8) Tighten the mounting screws: see fig. 30, Pos. 1 – 3.

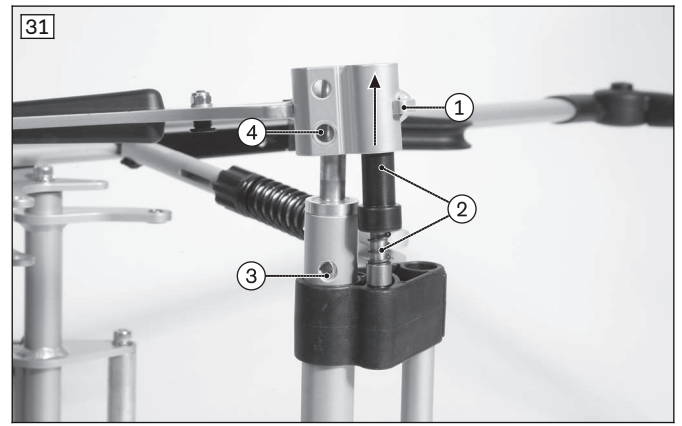
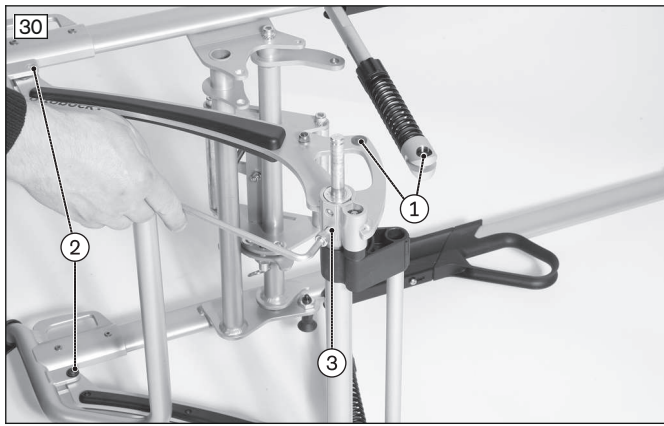

3.5.5 Frame

3.5.5.1 Replacing the Front Frame

- 1) Remove the plug-on rear wheel.
- 2) Put the frame on its side.
- 3) Remove the caster wheels ("swivelling" front wheels: see fig. 33; item 1; "fixed" front wheels: see fig. 35).
- 4) Loosen the mounting screws between the rear wheel linkages and lower front frame (see fig. 33, item 2; see fig. 35, item 2).
- 5) Using a spiral bit (\varnothing 5 mm), bore out 8 rivets between the lower/upper front frame (see fig. 33, item 3; see fig. 35, item 3). Tap out the rivets with a pin punch (\varnothing 3 mm).
- 6) Remove and replace the front frame.
 - Front frame for swivelling front wheels (see fig. 34)
 - Front frame for fixed front wheels (see fig. 36)
- 7) Rivet/install the front frame with the mounting materials provided.
- 8) Tighten the mounting screws between the rear wheel linkages and lower front frame (see fig. 33, item 2; see fig. 35, item 2).
- 9) Install the caster wheels (see Page 10 ff.).

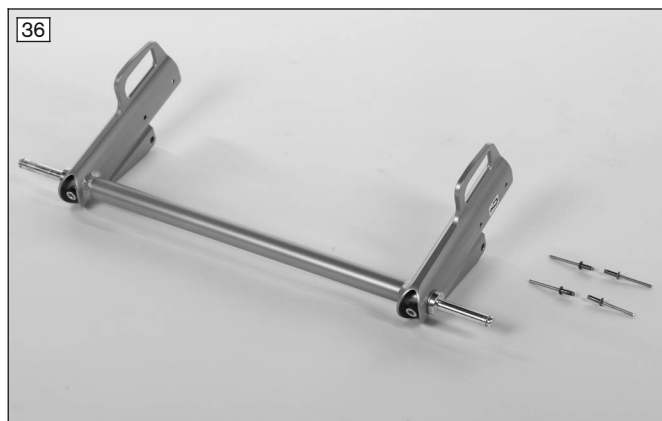
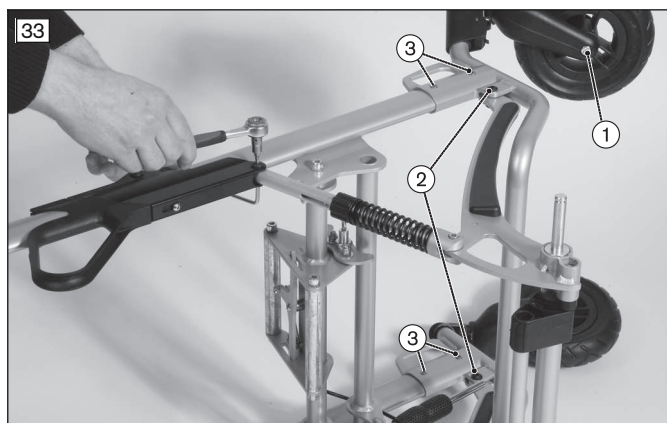

3.5.5.2 Replacing the Upper Front Frame

INFORMATION

The front frame is offered complete (see fig. 37) and alternatively in a version without seat adapter.

- 1) Remove the plug-on rear wheel.
- 2) Put the frame on its side.
- 3) Remove the caster wheels ("swivelling" front wheels: see fig. 39; item 1; "fixed" front wheels: not illustrated).
- 4) Loosen the mounting screws on the suspension (see fig. 24, item 1).
- 5) **Only for front frame with seat adapter** (see Page 13):
 - Remove the Bowden cable from the seat adapter (see fig. 20).
 - Unlock and remove the spring folding bolt on the Porter cylinder (see fig. 17, item 1).
- 6) Loosen the mounting screws between the folding tubes and fixed tube heads (see fig. 38, item 1) and remove the unit consisting of the folding tubes and push bar.
- 7) Using a spiral bit (Ø 5 mm), bore out 8 rivets between the lower/upper front frame (see fig. 33, item 3) and tap them out with a pin punch (Ø 3 mm).
- 8) Remove and replace the upper front frame (see fig. 37).
- 9) Install/rivet the front frame.
- 10) Tighten the mounting screws.
 - see fig. 38, item 1
 - see fig. 24, item 1
- 11) **Only for front frame with seat adapter:** Reconnect the seat adapter-Bowden cable and the seat adapter-Porter cylinder (see Page 13).
- 12) Install the caster wheels (see Page 10 ff.).

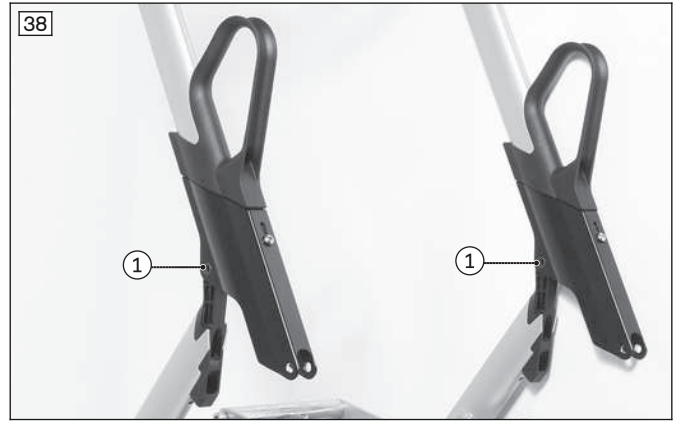

3.5.5.3 Replacing the Front Frame (Complete)

- 1) Remove the plug-on rear wheel.
- 2) Put the frame on its side.
- 3) Remove the caster wheels ("swivelling" front wheels: see fig. 39; item 1; "fixed" front wheels: not illustrated).
- 4) Loosen the mounting screws between the rear wheel linkages and lower front frame (see fig. 39, item 2).
- 5) Loosen the mounting screws on the suspension (see fig. 39, item 3).
- 6) Disconnect the front frame from the seat adjustment mechanism (see Page 13):
 - Remove the Bowden cable from the seat adapter (see fig. 20).
 - Unlock and remove the spring folding bolt on the Porter cylinder (see fig. 17, item 1).
- 7) Loosen the mounting screws between the folding tubes and fixed tube heads (see fig. 38, item 1) and remove the unit consisting of the folding tubes and push bar.
- 8) Remove and replace the front frame (see fig. 40).
- 9) Install the front frame with the mounting materials provided.
- 10) Tighten the mounting screws.
 - see fig. 38, item 1
 - see fig. 39, item 2/3
- 11) Reconnect the seat adapter-Bowden cable and the seat adapter-Porter cylinder (see Page 13).
- 12) Install the caster wheels (see Page 10 ff.).

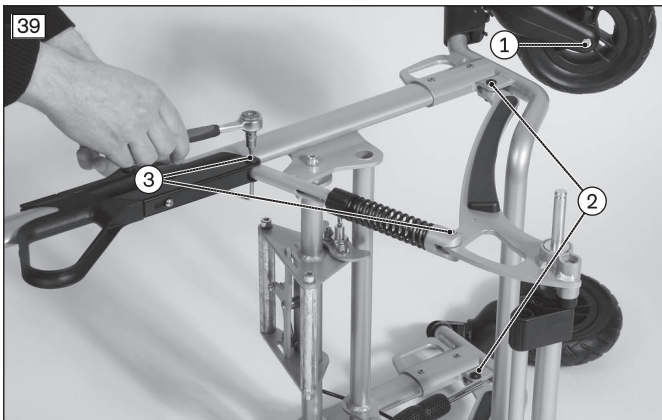

3.5.5.4 Replacing the Folding Tube

- 1) Bore out the rivet between the folding tube and ratchet joint (see fig. 41, Pos. 1) and remove the ratchet joint.
- 2) Loosen the mounting screws on the suspension (see fig. 41, Pos. 2).
- 3) Loosen the mounting screws between the folding tube and fixed tube head (see fig. 41, Pos. 3).
- 4) Replace the folding tube.
- 5) Install the folding tube with the mounting materials provided (see fig. 42). Tighten the mounting screws: see fig. 41, Pos. 2/3.
- 6) Rivet the ratchet joint to the folding tube (see fig. 41, Pos. 1).
- 7) Attach the sticker to the folding tube.



3.5.5 Replacing the fixed tube head

Removing the folding tubes and push bar unit

1. Loosen the respective mounting screws between the folding tube and fixed tube head using a size 4 Allen key (see fig. 43). Remove the threaded bushings (see fig. 44, item 1) and save them for later installation.
2. Pull the release handles up and remove the folding tubes and push bar unit (see fig. 45)
3. Remove the flange bushings from the bores on the folding tube and save them for later installation (see fig. 46).

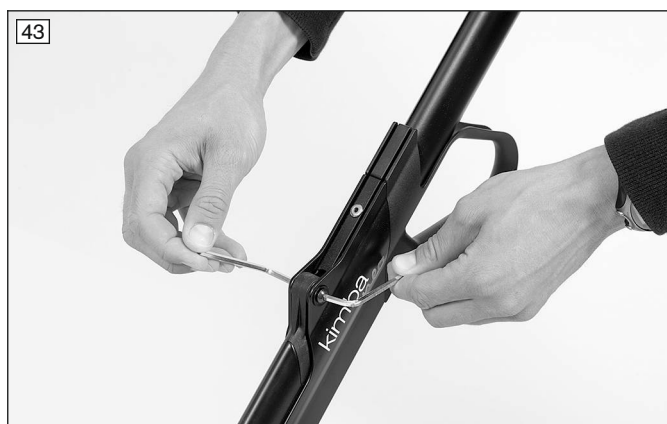

Removing the fixed tube head

- 1) Using a spiral bit (\varnothing 5 mm), bore out the rivet on the fixed tube head and tap the rivet pin into the frame with a pin punch (\varnothing 3 mm) (see fig. 47).
- 2) Tap out the fixed tube head from the upper front frame (see fig. 48).
- 3) Rotate the front frame 180° so the rivet pin falls out.



Inserting the new fixed tube head

- 1) Set the new fixed tube head onto the upper front frame (see fig. 49)

NOTICE

Damage to the fixed tube head by direct tapping with a hammer

To tap in the fixed tube head, always use an auxiliary tool which ensures that the tapping force is distributed over a defined surface ((see fig. 50), item 1).

- 2) Insert an auxiliary tool in the fixed tube head (see fig. 51).
- 3) Tap the auxiliary tool with the soft-faced hammer (see fig. 51) until the fixed tube head is flush (see fig. 52).

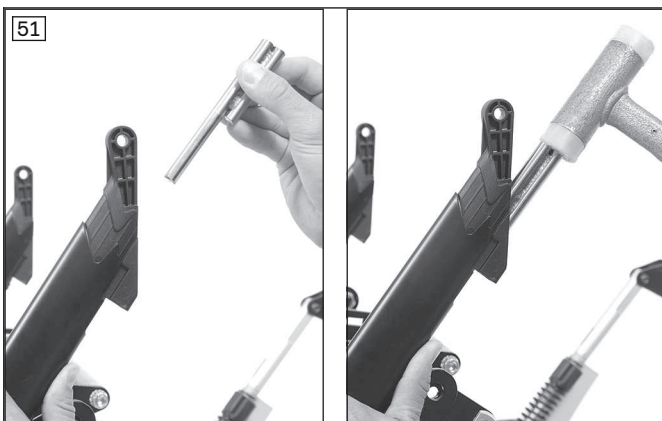

Installing the folding tubes and push bar unit

- 1) Rivet the fixed tube head in place with a new rivet (size 5x12, see fig. 53, item 1).
- 2) Insert the flange bushings into the bores on the folding tubes (see fig. 46).

INFORMATION

A second person as an installation assistant is recommended.

- Person 1: Raise and position the upper front frame.
 - Person 2: Guide the folding tubes and push bar unit to the upper front frame (see fig. 54). Pull the release handles up and let them engage in the squares of the fixed tube heads (see fig. 55).
- 3) Insert the threaded bushings respectively between the folding tube and fixed tube head. Screw in the mounting screws (see fig. 53, item 2) including one polyamide washer each and tighten them.

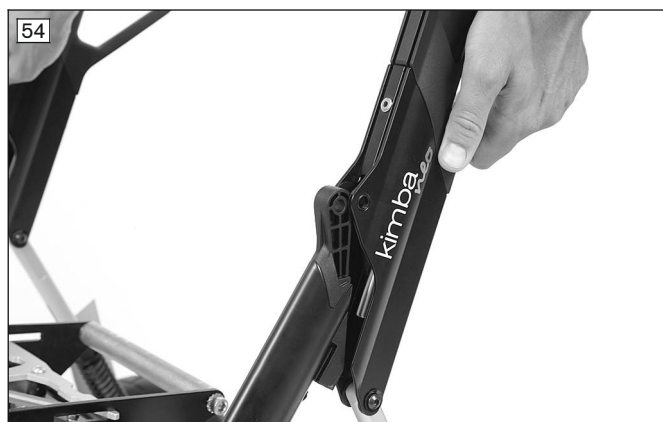
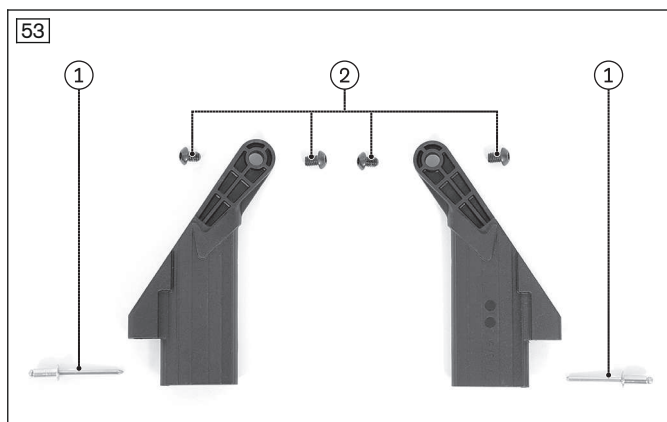

3.5.6 Push Bar

3.5.6.1 Replacing the Ratchet Joints with Folding Fixture

- 1) Using a spiral bit (\varnothing 5 mm), bore out 4 rivets on each ratchet joint and tap them out with a pin punch (\varnothing 3 mm) (see fig. 56, Pos. 1/2).
- 2) Remove and replace the ratchet joints (see fig. 57).
- 3) Rivet the ratchet joint with the folding fixture on the correct side (see fig. 58).

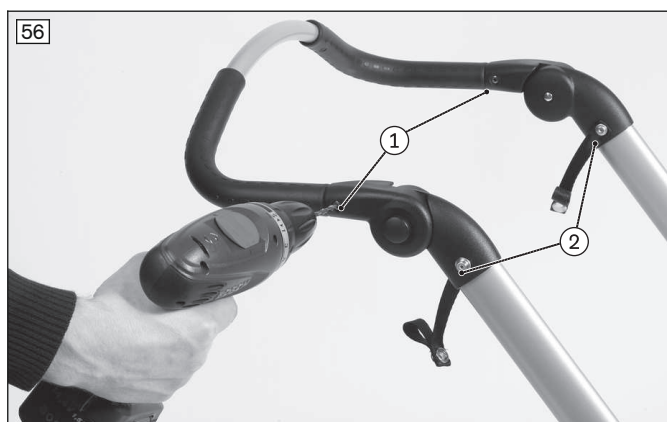



3.5.6.2 Replacing the Push Bar

- 1) Using a spiral bit (Ø 5 mm), bore out 2 rivets on each ratchet joint and tap them out with a pin punch (Ø 3 mm) (see fig. 56, Pos. 1).
- 2) Remove and replace the push bar (see fig. 59).
- 3) Rivet the push bar onto the ratchet joint.

3.6 Multifunctional Seating Unit (Standard Seat)

3.6.1 Pads/Covers

INFORMATION

The manufacturer offers two versions of the pads and covers with identical mounting:

- ▶ Pads/covers (standard)
- ▶ Pads/covers (microfibre)

3.6.1.1 Replacing the Seat Pad

- 1) Lift the seat pad and remove it from the hook-and-loop fastener on the seat plate (see fig. 60).
- 2) Replace the seat pad.
- 3) Fit the seat pad onto the hook-and-loop fastener.
- 4) Push the seat pad under the hip supports (see fig. 61).

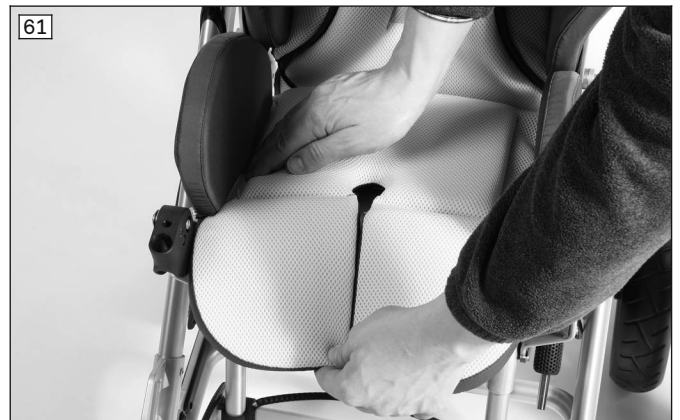

3.6.1.2 Replacing the Backrest Pad

INFORMATION

The manufacturer offers two versions of the backrest pad:

- ▶ Back pad for standard back insert (see fig. 62)
- ▶ Back pad for back insert with head supports (see fig. 63; to adjust the clearance of the integrated head support: see Page 25)

- 1) Release the twist lock of the backrest pad behind the seat bottom (see fig. 64).
- 2) Unzip the backrest pad zipper (see fig. 65) and remove/replace the backrest pad.

- 3) Put the backrest pad in place and pull it through between the back and seat bottom.
- 4) Close the twist lock (see fig. 64).
- 5) Slide the backrest pad under the lateral supports (no illustration).



3.6.1.3 Replacing the Covers

INFORMATION

The manufacturer offers the covers in the following versions:

- ▶ Covers for headrest supports (see fig. 66, Pos. 1)
- ▶ Covers for lateral supports (see fig. 66, Pos. 2)
- ▶ Covers for thoracic supports (no illustration)
- ▶ Cover for the grab rail (see fig. 66, Pos. 3; see the following section for replacement)
- ▶ Covers for hip supports (see fig. 66, Pos. 4)
- ▶ Cover for the abductor (see fig. 66, Pos. 5)

- 1) Remove the seat pad or backrest pad if required.
- 2) Open the hook-and-loop closure on the cover.
- 3) Remove the cover from the support or abductor and replace it.
- 4) Slide the cover over the support with proper alignment. Note the following:
 - If present: position the side reinforced with foam material on the **outside** (over the screw heads) (see fig. 67, Pos. 1).
 - Pull the cover over the support starting with the side that does not have a lug (see fig. 68, Pos. 1).
 - Pull the cover over the support with the help of the lug (see fig. 68, Pos. 2).
 - Before fastening the hook-and-loop closure, push and fold down the lug (see fig. 69).
- 5) Put the seat pad or backrest pad back into place.

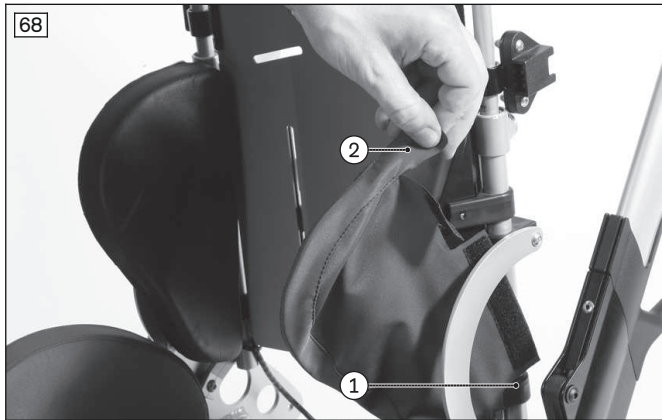
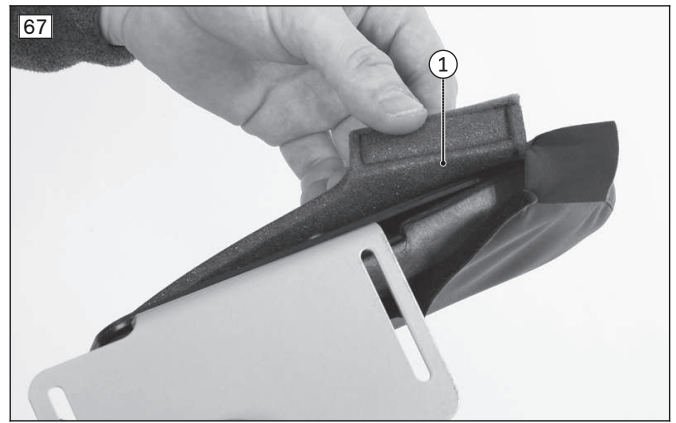
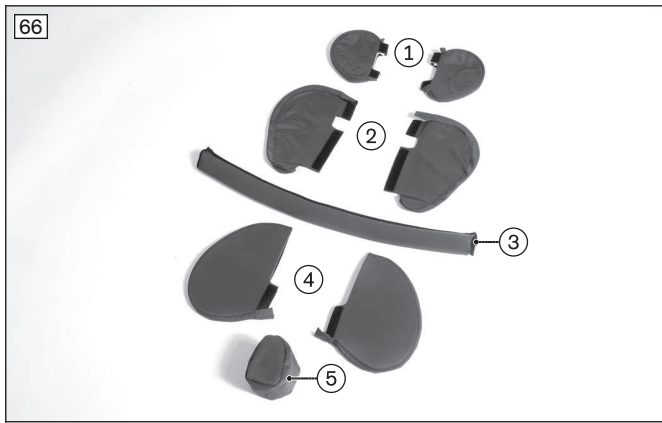

3.6.1.4 Replacing the Grab Rail Cover (Option)

- 1) Push in the tripod spring and remove the grab rail (see fig. 150, Pos. 1).
- 2) Pull the grab rail pad (see fig. 66, Pos. 3) off the grab rail and replace it.
- 3) Slide the grab rail pad onto the grab rail (see fig. 150).
- 4) Reattach the grab rail.

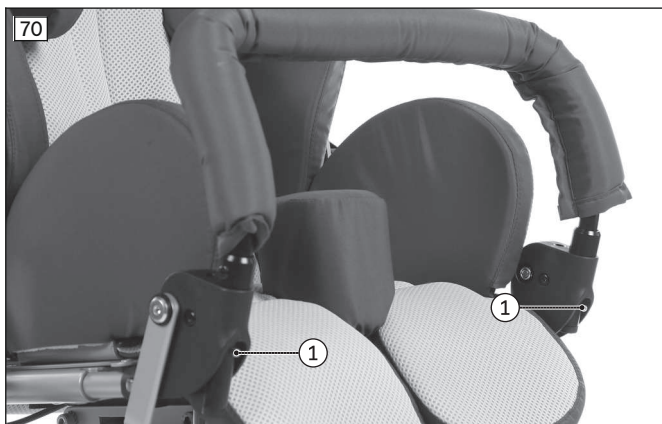

3.6.1.5 Replacing the Frame Padding (Option)

- 1) Open the hook-and-loop closure on the frame padding.
- 2) Remove and replace the frame padding.
- 3) Fit the frame padding around the push bar and close the hook-and-loop strap.
- 4) Twist the hook-and-loop strap down and push the frame padding over the folding mechanism all the way to the release handles (see fig. 71).



3.6.2 Back

3.6.2.1 Replacing the Back Insert

INFORMATION

The manufacturer offers two versions of the back insert:

- ▶ Standard back insert: see fig. 73
- ▶ Back insert with head supports: see fig. 74

- 1) Remove the backrest pad (see Page 22).
- 2) Loosen the 2 x set screws on the backrest tubes (see fig. 72, Pos. 1).
- 3) Remove and replace the standard back insert (see fig. 73) or the back insert with head supports (see fig. 74).
- 4) Slide the new back insert into the back frame and adjust it to the desired height.
- 5) Tighten the set screws (see fig. 72, Pos. 1).

INFORMATION: You can achieve a greater back height by additionally shifting the top back plate at the back insert. To do so, loosen/remove the knurled nuts, shift the back plate and hand-tighten the knurled nuts again.

- 6) Put the backrest pad in place (see Page 22).

Adapting the Back Insert with Integrated Head Supports

To adjust the clearance in the area of the head, up to 3 foam pads with a thickness of 1 cm each can be glued onto the head supports (see fig. 75, Pos. 1). They are included with the backrest pad.

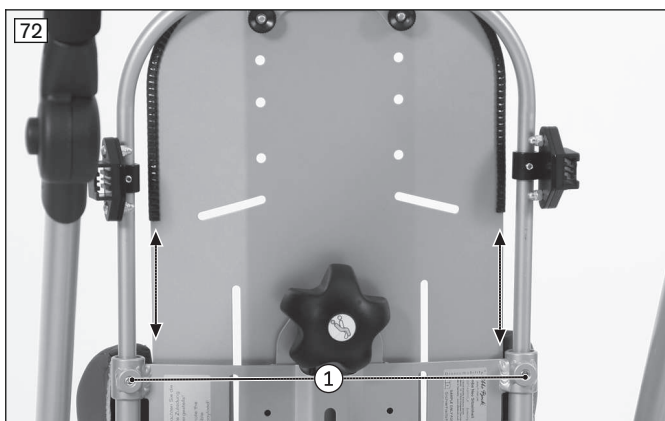

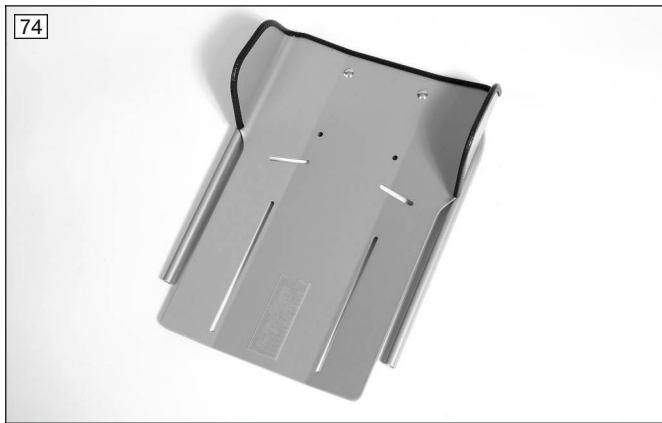

3.6.2.2 Replacing the Knob

INFORMATION

The manufacturer offers the knob and cover cap in the following single components:

- ▶ Seat angle adjustment knob: see fig. 76, item 1
- ▶ Seat angle adjustment cover cap: see fig. 77, item 1
- ▶ Back angle adjustment knob: see fig. 76, item 2
- ▶ Back angle adjustment cover cap: see fig. 77, item 2

Replacing the Seat Angle Adjustment Knob and Cover Cap

- 1) Using a screwdriver, carefully pry up the cover cap, remove and replace it (see fig. 78).
- 2) Remove and replace the circlip (see fig. 79).
- 3) Pull the knob off the centring pivot and replace it.
- 4) Install the knob using the mounting materials provided (see fig. 76, item 1).
- 5) Tap the cover cap (see fig. 77, item 1) into the knob.

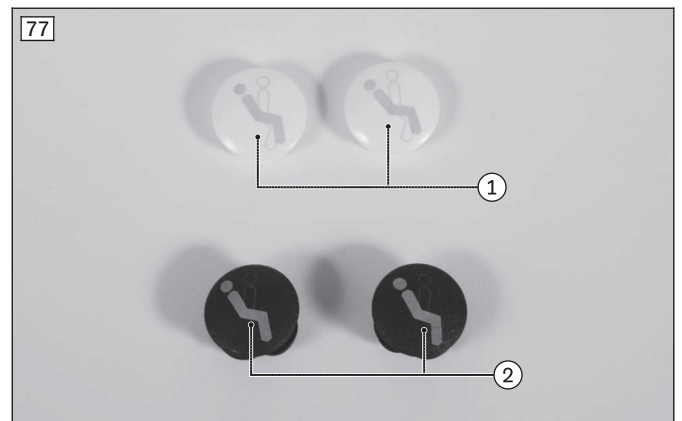
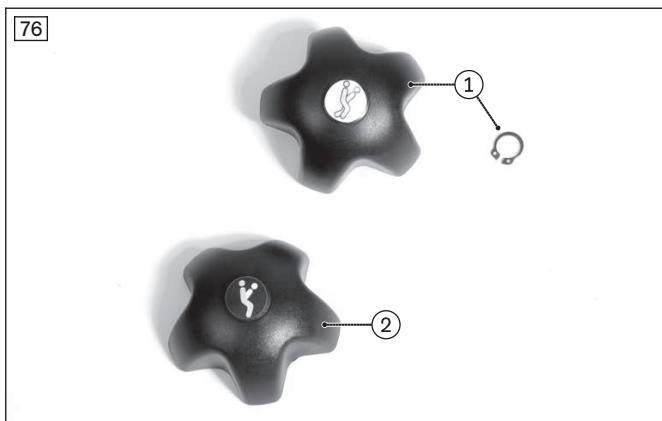



Replacing the Back Angle Adjustment Knob and Cover Cap

- 1) Using a screwdriver, carefully pry up the cover cap, remove and replace it (not illustrated).
- 2) Unscrew the knob from the mounting screw on the clamp tie-bar and replace it (see fig. 114, item 1 – 3).
- 3) Reinstall the knob (see fig. 76, item 2).
- 4) Using a rubber hammer, tap the cover cap (see fig. 77, item 2) into the knob.

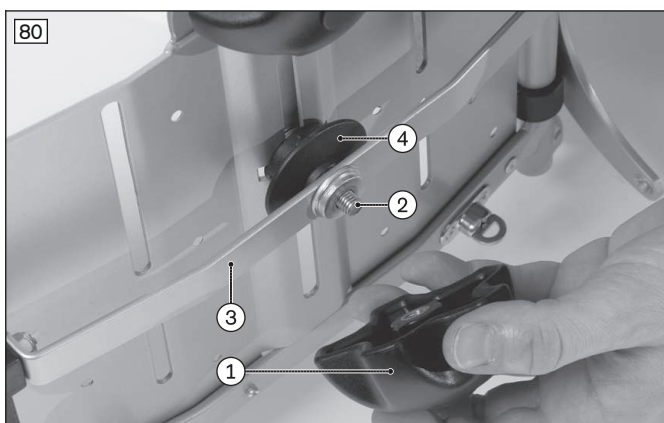

3.6.2.3 Removing/Installing the Tilt Activation Mechanism

INFORMATION

The tilt activation mechanism must be removed/installed when replacing the back frame and base frame (seat frame).

Removing the Tilt Activation Mechanism

- 1) Remove the backrest pad (see Page 22).
 - 2) Remove the back insert (see Page 25).
 - 3) Remove the cover cap and knob (see preceding section).
 - 4) Pry the back of the Bowden cable adapter (see fig. 81, item 1) off the adapter on the back plate (see fig. 81, item 2).
 - 5) Remove the plastic ring from the Bowden cable adapter (see fig. 82, item 1).
 - 6) If required, disconnect the Bowden cable from the plastic ring (see fig. 82, item 2).
 - 7) Cut open and remove the cable ties on the back frame (see fig. 83, item 1).
 - 8) Pull the Bowden cable down through the back frame (see fig. 84, item 1).
- Now the back frame and base frame (seat frame) can be replaced.

Installing the tilt activation mechanism

- 1) After installing the back frame or base frame (seat frame), reinstall the tilt activation mechanism.
- 2) Note the following:
 - With the help of cable ties, install the Bowden cable so that it cannot be pinched/damaged (see fig. 83/see fig. 84).

- During assembly, firmly press the Bowden cable adapter into the adapter on the back plate (see fig. 81, item 1/2).
- Note the proper setting of the adjusting screw at the Bowden cable adapter on the seat frame (see fig. 85, item 1). The adjusting screw must **not** be tightened all the way to the stop. The proper setting of the adjusting screw has been found as soon as the sliding block starts moving somewhat towards the trigger of the seat tilt (see fig. 86, item 2) upon unscrewing the adjusting screw (see fig. 86, item 1).

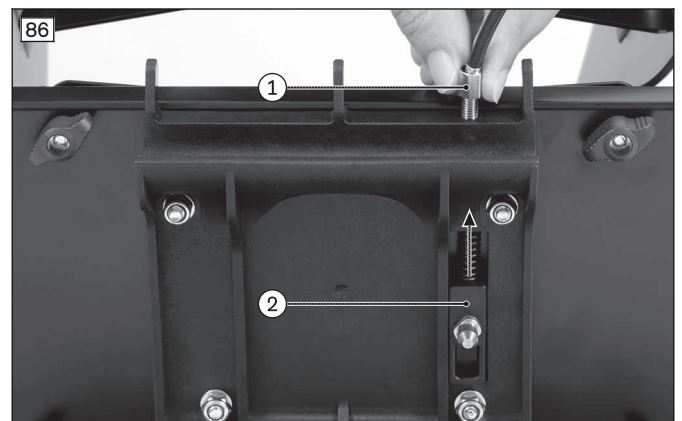
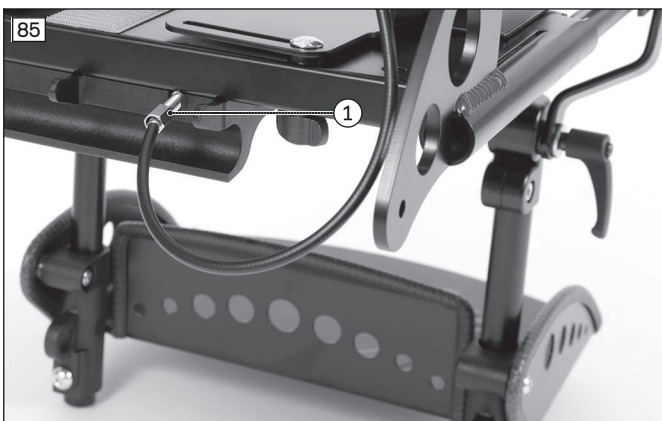
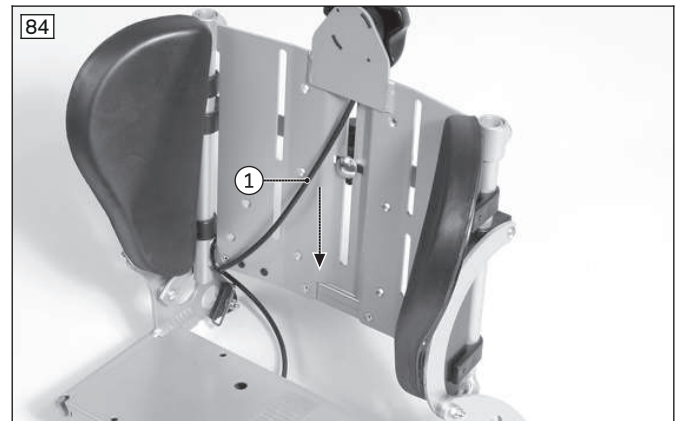
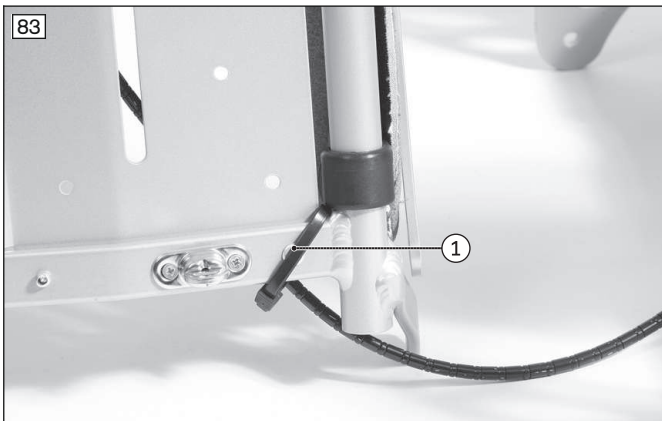
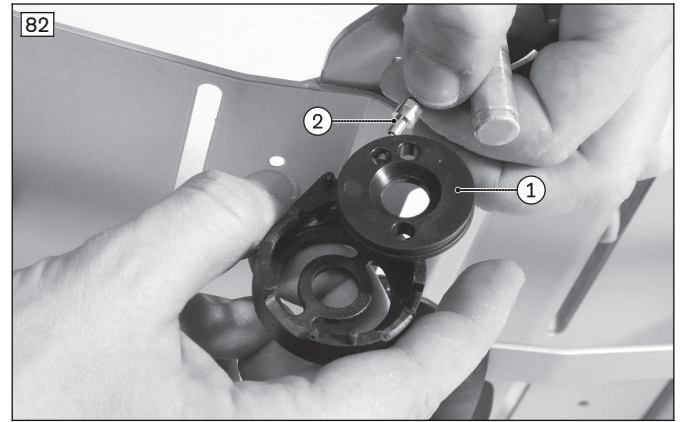
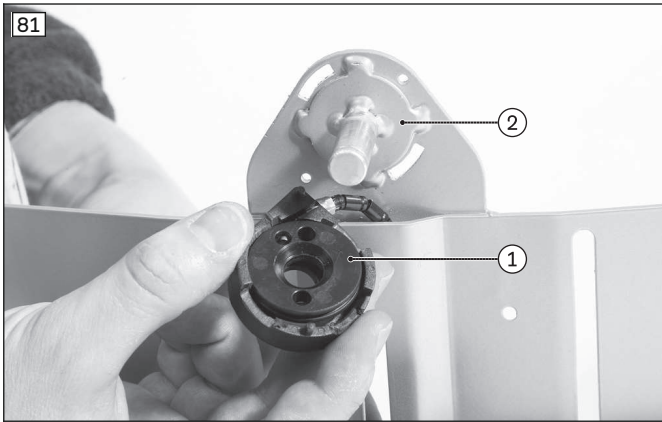

3.6.2.4 Replacing the Back Frame (Complete)

- 1) Remove the backrest pad (see Page 22).
- 2) Remove the back insert (see Page 25).
- 3) Remove the tilt activation mechanism (see Page 27).
- 4) Loosen the 4 x mounting screws on the back frame-base frame connection (see fig. 87, Pos. 1/2).
- 5) Remove the 4 x bearing bushings (see fig. 87, Pos. 3).
- 6) Separate the back frame from the base frame and replace it.
- 7) Install the back frame using the mounting materials provided (see fig. 88).

- 8) Tighten the mounting screws.
INFORMATION: Tighten the screw connections so that there is no play between the mounting elements. Take care, however, not to deform any components. Then check the movability of the connected frame components and readjust the tightness of the screw connections as necessary.
- 9) Reinstall the tilt activation mechanism (see Page 27) and the back insert (see Page 25).
- 10) Reinstall the backrest pad (see Page 22).

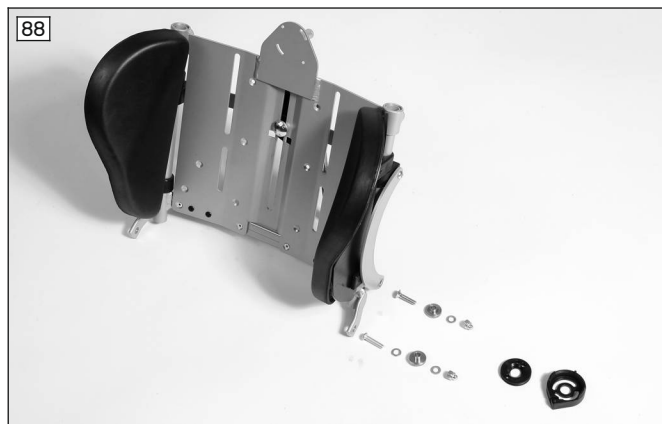
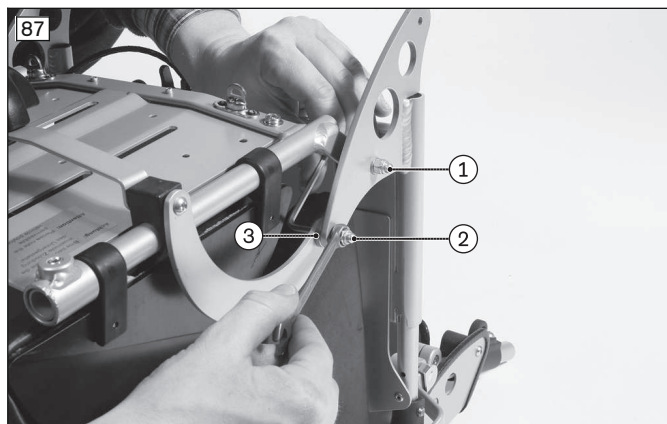

3.6.2.5 Installing/removing the seat depth reducer

INFORMATION

The seat depth of the multifunctional seating unit in size 1 can be reduced by 5 cm to 14 cm with the seat depth reducer.

Installing the seat depth reducer

- 1) Remove the covers.
- 2) Remove the hip pads (see Page 34).
- 3) Remove the back frame. In order to do so, loosen the four mounting screws on the back frame – base frame connection (see fig. 87, item 1/2) and remove the four bearing bushings (see fig. 87, item 3).
- 4) Attach the seat depth reducer with two mounting screws and two bearing bushings to the base frame (see fig. 89, item 1; see fig. 90, item 1).
INFORMATION: In doing so, secure the mounting screws with a medium-strength liquid thread lock compound (see fig. 91).
- 5) Install the back frame with two mounting screws and two bearing bushings to the seat depth reducers (see fig. 89, item 2; see fig. 90, item 2).
INFORMATION: In doing so, secure the mounting screws with a medium-strength liquid thread lock compound (see fig. 91).
- 6) Attach the hip pads and pull over the covers.

Removing the seat depth reducer

- 1) Remove the covers.
- 2) Remove the hip pads (see Page 34).
- 3) Loosen and remove the four mounting screws on each seat depth reducer (see fig. 89, item 1/2). Remove the bearing bushings.
 → The back frame is now separated from the base frame.
- 4) Attach the back frame with the bearing bushings inserted (see fig. 87, item 3) to the base frame (see fig. 92, item 1) using two mounting screws (see fig. 87, item 1/2).
- 5) Attach the hip pads and pull over the covers.

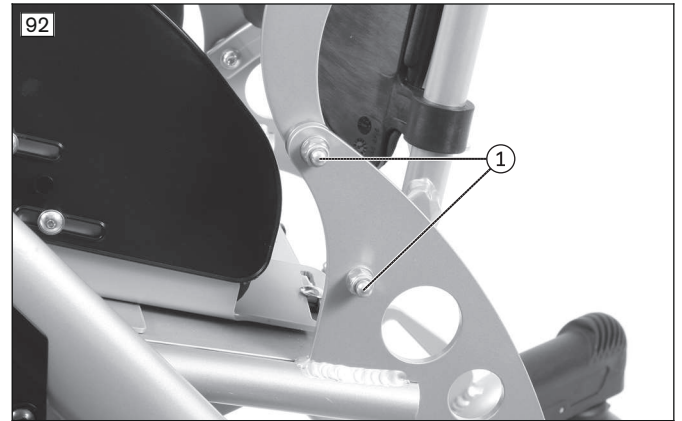
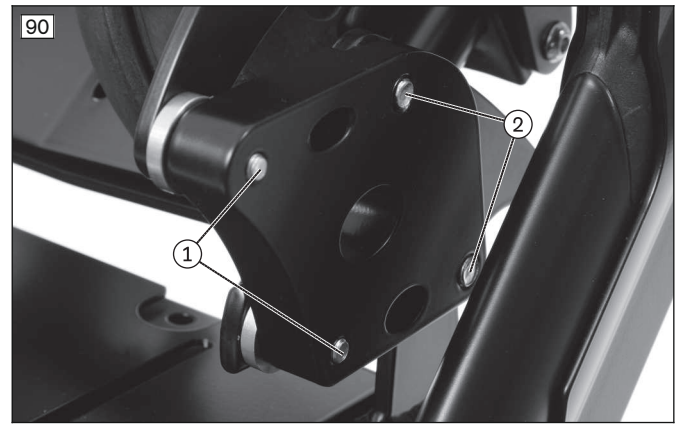
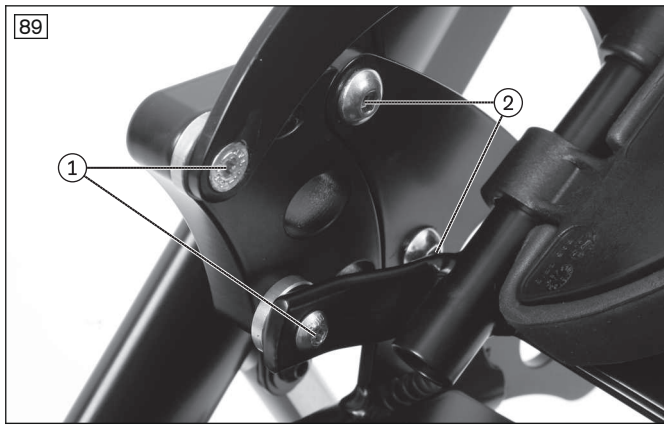

3.6.3 Footplate/Knee Angle Assembly

3.6.3.1 Replacing the Foot Plate

- 1) **Recommendation:** Set the knee angle assembly horizontal.
- 2) Loosen the mounting screws in the slides (see fig. 93). Ensure that the inserted flange nuts (see fig. 94, Pos. 2) do not fall out of the slides in the process.
- 3) Remove the footplate from the footplate adapter (see fig. 93, Pos. 2) and replace it.
- 4) Slide the footplate onto the footplate adapter.
- 5) Tighten the mounting screws in the sliders to a torque of **5 Nm**.

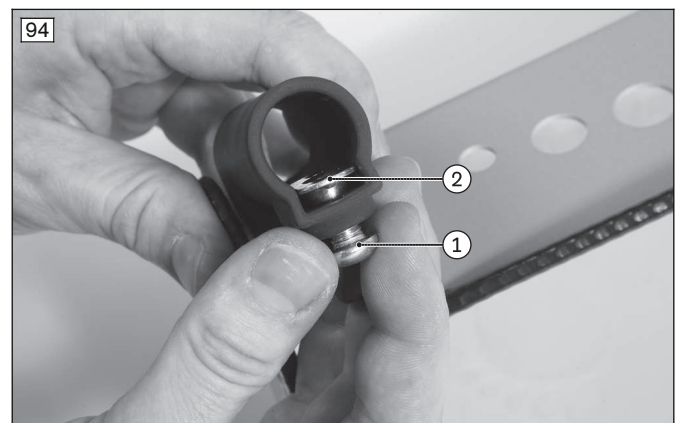
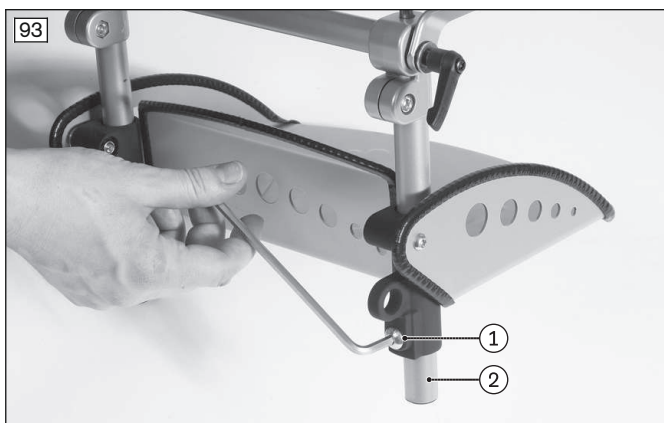

3.6.3.2 Replacing Small Parts on the Footplate

Replacing the Sliders

- 1) Remove the footplate.
- 2) Loosen the mounting screws on the sliders (see fig. 95).
- 3) Remove and replace the sliders.
- 4) Tighten the mounting screws on the sliders to a torque of **5 Nm**.

Replacing the Flange Nut on a Slider

- 1) Loosen the mounting screws in the sliders (see fig. 94, Pos. 1).
- 2) Remove the inserted flange nuts (see fig. 94, Pos. 2) from the sliders and replace them.
- 3) Secure the flange nuts with the mounting screws.



3.6.3.3 Replacing the Knee Angle Assembly (Complete)

- 1) Remove the seating unit from the outdoor mobility base.
- 2) Loosen the 2 x knurled nuts on the underside of the base frame (see fig. 96, Pos. 1).
- 3) **If required:** Loosen the 2 x knurled nuts on the rear mounting screws on the hip supports (see fig. 108).
- 4) Pull the knee angle assembly (complete) out of the base frame and replace it (see fig. 97).
- 5) Remove the footplate from the footplate adapter (see Page 30).
- 6) Slide the knee angle assembly (complete) back into the base frame and mount it.
- 7) Slide the footplate onto the footplate adapter (see Page 30).
- 8) Hand-tighten the knurled nuts.

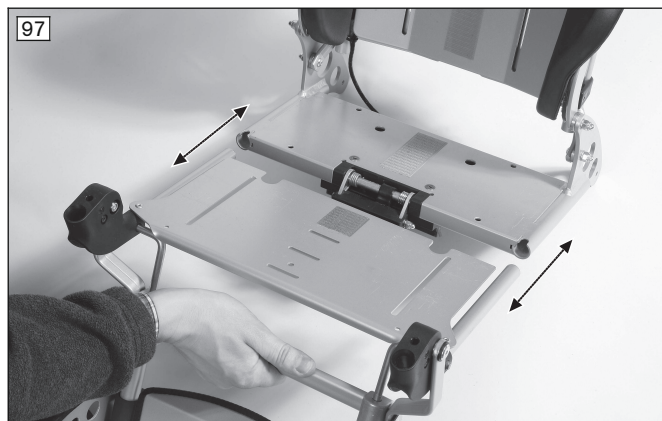
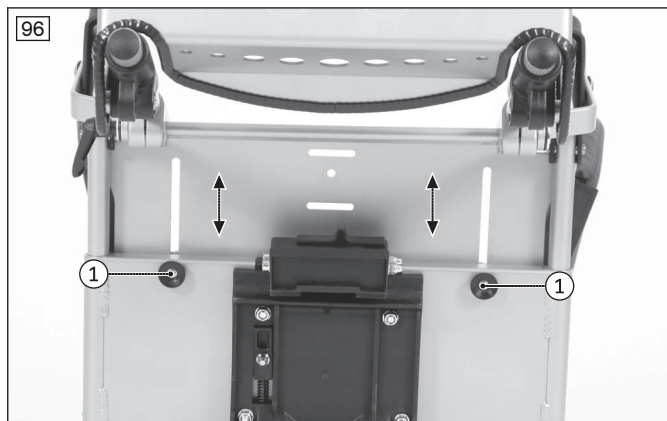

3.6.3.4 Replacing the Footplate Adapter

- 1) Remove the footplate (see Page 30).
- 2) Remove the knee angle assembly from the base frame (see Page 31).
- 3) Loosen the pivoted levers (see fig. 98, Pos. 1) from the end pieces of the "seat adjuster" (see fig. 98, Pos. 2).
- 4) Open the clamping lever (see fig. 98, Pos. 3) and pull the footplate adapter (see fig. 98, Pos. 4) from the struts (see fig. 98, Pos. 5).
- 5) Pull the struts from the end pieces of the "seat adjuster" (see fig. 98, Pos. 5/2).
- 6) Prepare the new footplate adapter (see fig. 99).
- 7) Insert the struts into the end pieces of the "seat adjuster" (see fig. 99, Pos. 1).
- 8) Slide the footplate adapter onto the struts (see fig. 99, Pos. 2).
- 9) Engage the clamping lever (see fig. 99, Pos. 3).
- 10) Mount the pivoted levers (see fig. 99, Pos. 4) on the end pieces of the "seat adjuster" with the mounting screws (see fig. 98, Pos. 1/2).
- 11) Mount the footplate (see Page 30).

12) Mount the knee angle assembly on the base frame (see Page 31).

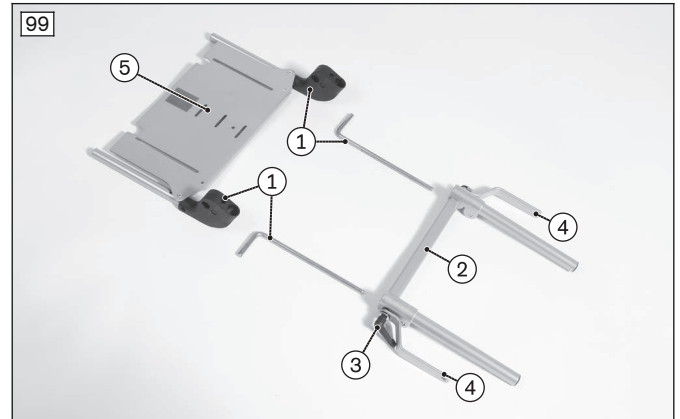
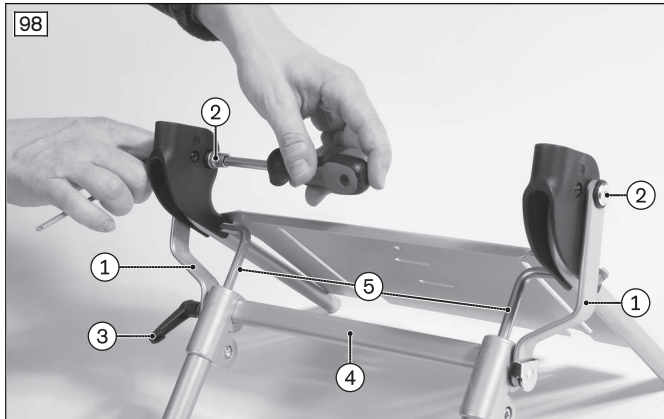

3.6.3.5 Replacing the "Seat Adjuster"

- 1) Remove the footplate (see Page 30).
- 2) Remove the knee angle assembly from the base frame (see Page 31).
- 3) Loosen the footplate adapter with struts from the end pieces of the "seat adjuster" (see Page 31).
- 4) Replace the "seat adjuster" (see fig. 99, Pos. 5).
- 5) Insert the struts into the end pieces of the "seat adjuster" (see fig. 99, Pos. 1).
- 6) Slide the footplate adapter onto the struts (see fig. 99, Pos. 2).
- 7) Engage the clamping lever (see fig. 99, Pos. 3)
- 8) Mount the pivoted levers (see fig. 99, Pos. 4) on the end pieces of the "seat adjuster" with the mounting screws (see fig. 98, Pos. 1/2).
- 9) Mount the footplate (see Page 30).
- 10) Mount the knee angle assembly on the base frame (see Page 31).

3.6.4 Base Frame (Seat Frame)

3.6.4.1 Replacing the Base Frame (Tilt Activation Mechanism on Seat)

INFORMATION

The tilt activation mechanism must be removed prior to replacement (see Page 27).

- 1) Remove the seat pad (see fig. 65).
- 2) Remove the seating unit.
- 3) Loosen the 4 x knurled nuts on the underside of the seat (see fig. 100, Pos. 1) and remove the hip supports.
- 4) Pull the knee angle assembly out of the base frame (see fig. 101).
- 5) Remove the back insert (see Page 25).
- 6) Remove the Bowden cable of the tilt activation mechanism from the back frame (see Page 27).
- 7) Loosen the 4 x mounting screws on the back frame-base frame connection (see fig. 101, Pos. 1/2).
- 8) Remove and replace the base frame (see fig. 102).
- 9) Mount the back frame on the base frame (see fig. 101, Pos. 1/2; see Page 28).
- 10) Reinstall the Bowden cable of the tilt activation mechanism (see Page 27).
- 11) Reinstall the back insert (see Page 25).
- 12) Reinstall the backrest pad (see Page 22).

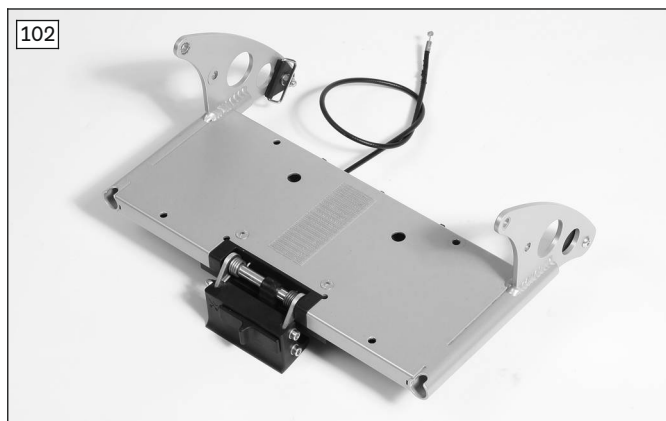
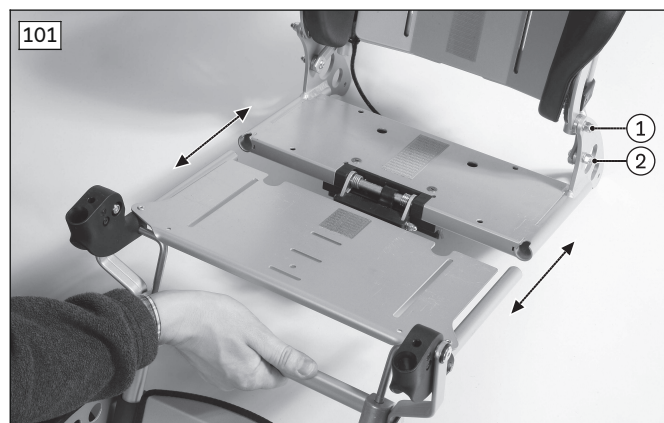
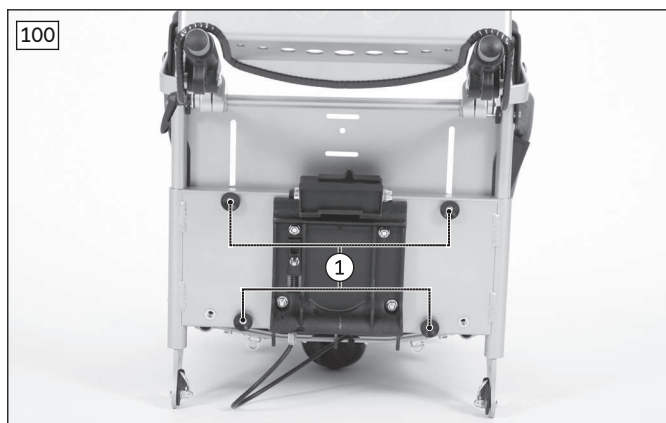

3.6.5 Supports

3.6.5.1 Replacing the Headrest Supports

- 1) **With a standard pad:** Open the zipper at the top of the pad (see fig. 65) and fold the backrest pad forward.
With a microfibre pad: Open the zipper. Do **not** fold down the pad; the supports must be threaded through the slits in the pad for installation.
- 2) Loosen the knurled nuts on the back of the back plate (see fig. 103).
- 3) Remove the mounting screws and supports.
- 4) Remove the covers from the supports (see Page 23) and replace the supports.
- 5) Pull the covers over the new supports with proper alignment (see Page 23).
- 6) Preinstall the supports on the correct sides with the mounting materials provided (see fig. 104).
INFORMATION: With a microfibre pad, the supports first have to be threaded through the slits in the backrest pad.
- 7) Put the mounting screws through the slotted hole in the support and the bore hole in the back insert, respectively (see fig. 105).
INFORMATION: If the headrest supports are to be mounted to the top holes (= mounting points of the back plate), the longer mounting screws, which come with the device, will have to be used instead of the regular mounting screws.
- 8) Fasten the headrest supports on the back of the back plate using the knurled nuts (see fig. 103). Adjust the width in the slotted holes if required.
- 9) Hand-tighten the knurled nuts.
- 10) **With a standard pad:** Fold the backrest pad back over the supports and close the zipper.
With a microfibre pad: Close the zipper.

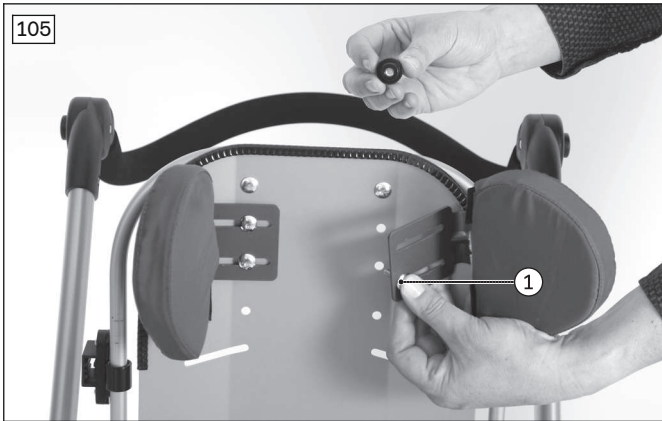

3.6.5.2 Replacing the Thoracic Supports

- 1) Open the zipper at the top of the pad (see fig. 65) and fold the backrest pad forward.
- 2) Loosen the knurled nuts on the back of the back plate (no illustration).
- 3) Remove the mounting screws and supports.
- 4) Remove the covers from the supports (see Page 23) and replace the supports.
- 5) Pull the covers over the new supports with proper alignment (see Page 23).
- 6) Preinstall the supports on the correct sides with the mounting materials provided (see fig. 106).
- 7) Put the mounting screws through the slotted holes in the support and the slotted holes in the back frame/back insert, respectively (see fig. 107, Pos. 1).
- 8) Fasten the thoracic supports on the back of the back insert using knurled nuts. If necessary, adjust the width/height.
- 9) Hand-tighten the knurled nuts.
- 10) Fold the backrest pad back over the supports and close the zipper.

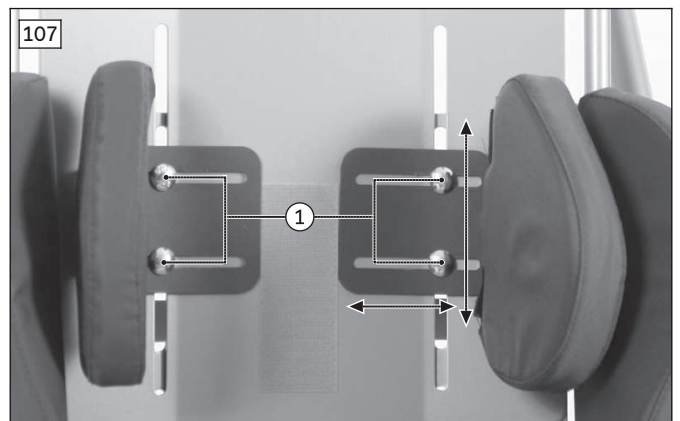

3.6.5.3 Replacing the Hip Supports

- 1) Remove the seat pad (see fig. 65).

- 2) Remove the covers from the supports (see Page 23).
- 3) Loosen the 4 x knurled nuts on the underside of the seat (see fig. 100, Pos. 1).
- 4) Remove the mounting screws and supports.
- 5) Preinstall the supports on the correct sides with the mounting materials provided (see fig. 109).
- 6) Put the mounting screws through the slotted holes in the support and the slotted holes in the base frame (seat frame) and the front seat plate, respectively (see fig. 110).
- 7) Mount the hip supports on the underside of the seat using knurled nuts (see fig. 100, Pos. 1).
- 8) Adjust the seat width by moving the hip supports (see fig. 110). This also allows for abducted settings. Hand-tighten the knurled nuts.
- 9) Adjust the depth of the supports if required (see fig. 111). Tighten the mounting screws.
- 10) Pull the covers over the supports with proper alignment (see Page 23).
- 11) Replace the seat pad and secure it with the hook-and-loop fastener (see fig. 65).

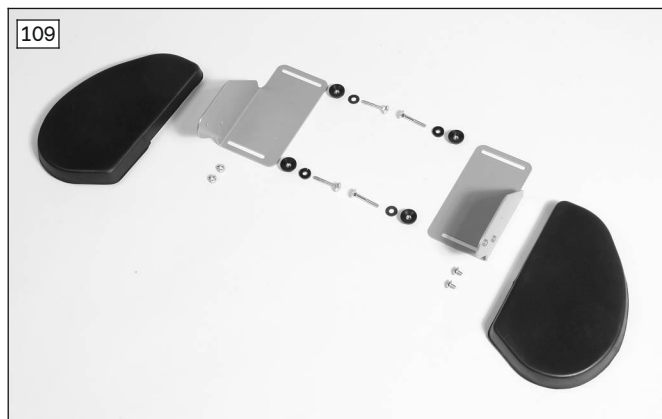
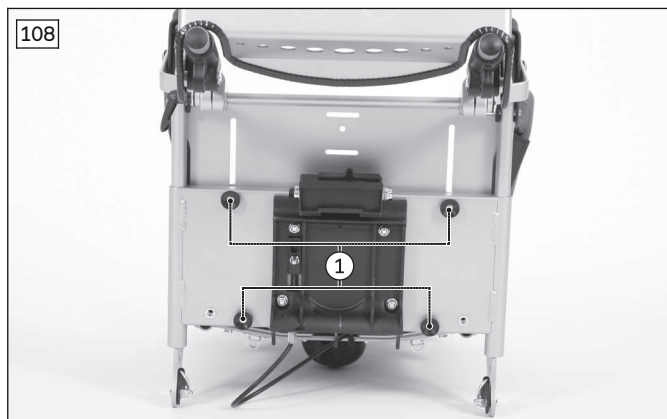

3.6.5.4 Replacing the Lateral Supports

- 1) Open the zipper at the top of the pad (see fig. 65) and remove the backrest pad (see Page 22).
- 2) Remove the covers from the supports (see Page 23).
- 3) Remove the back insert (see Page 25).
- 4) Remove and set aside the back frame (see Page 28).
- 5) Remove the back plate from the back frame:
 - Using a spiral bit (Ø 5 mm), bore out 4 rivets between the back frame and back plate (see fig. 112, Pos. 1) and tap them out with a pin punch (Ø 3 mm).
 - Remove the 4 x Phillips screws between the back frame and back plate (see fig. 112, Pos. 2)
 - Remove the 2 x set screws from the tube clamp (see fig. 113, Pos. 1).
 - Remove the knob (see fig. 80, Pos. 1) and the mounting screw (see fig. 80, Pos. 2) from the clamp tie-bar (see fig. 80, Pos. 3).
 - Pull the back plate off the back frame.
- 6) Pull the tubes of the back frame (see fig. 113, Pos. 2) from the lateral pads (see fig. 113, Pos. 3) and the plastic slides of the clamp tie-bar (see fig. 113, Pos. 4).
- 7) Replace the lateral supports (see fig. 115).

- 8) Push the tubes of the back frame (see fig. 113, Pos. 2) through the lateral supports (see fig. 113, Pos. 3) and the plastic slides of the clamp tie-bar (see fig. 113, Pos. 4) on the back plate.
- 9) Rivet and screw the back plate in place.
- 10) Use the mounting screw to install the knob (including back securing bolt: see fig. 80, Pos. 4) on the clamp tie-bar.
- 11) Reinstall the back frame (see Page 28).
- 12) Install the back insert (see Page 25).
- 13) Pull the covers over the supports with proper alignment (see Page 23).
- 14) Reattach and close the backrest pad (see Page 22).

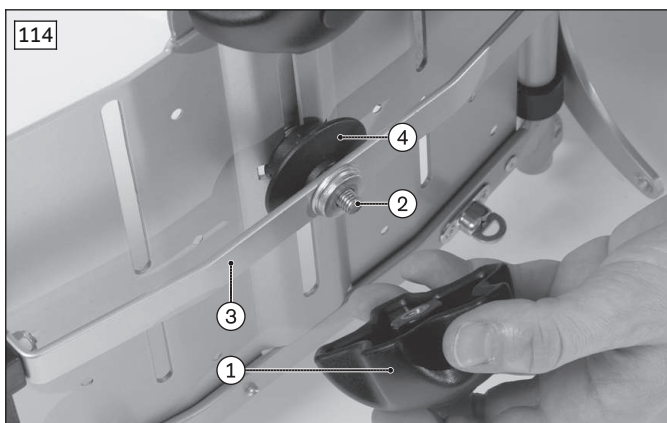
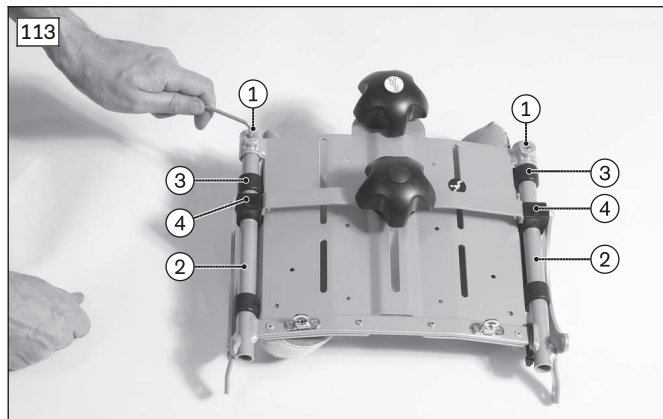
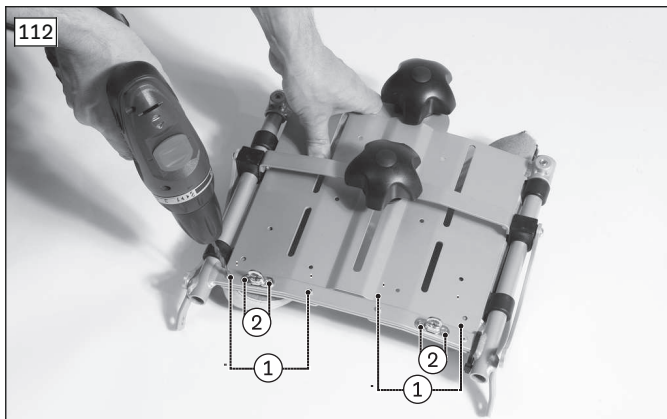

4 Installing other options/accessories

4.1 Safety belts

4.1.1 Strap guide

For improved belt guidance in the pelvic area, strap guides must be installed in the following cases:

- Lap belt; lap-belt part of the four/five-point belt: installation position see fig. 116, item 1
 - Bottom attachment straps of the chest and shoulder support: installation position see fig. 116, item 2
- 1) Put on the strap guide from the inside, connecting the flat side to the fastening point of the seating unit (see fig. 117, item 1).
 - 2) Put the mounting screw through the fastening point from the outside (see fig. 117, item 2) and screw it into the strap guide.
 - 3) Pre-mount the strap guide with the washer/cap nut.
 - 4) Twist the strap guide in the direction of use and finish assembly (see fig. 116).

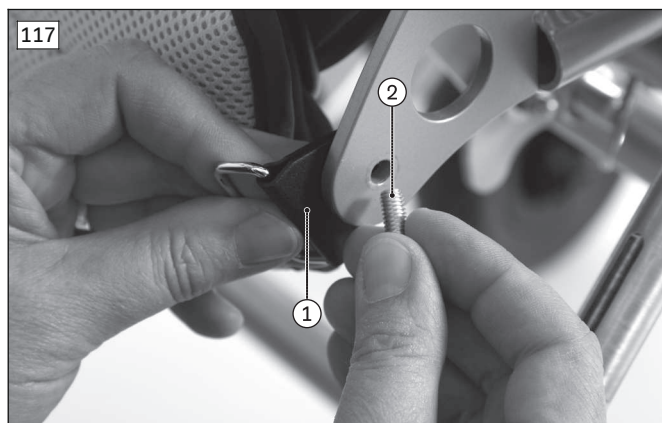
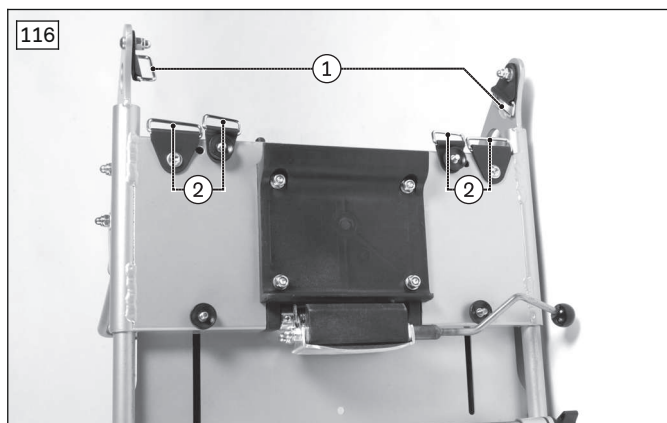

4.1.2 Lap belt

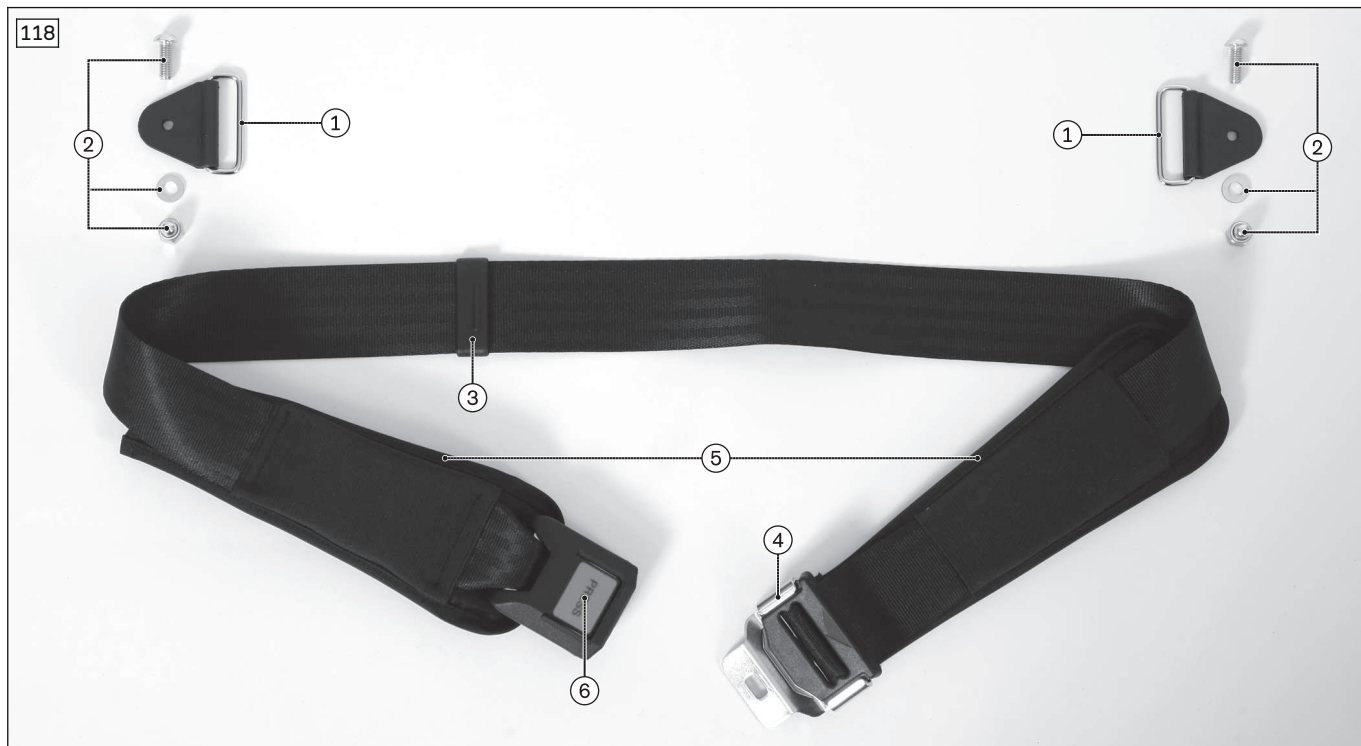

1	Strap guide	4	Adjustment buckle
2	Attachment fittings	5	Belt pads
3	Belt restraint	6	Release button/belt buckle

Mounting the lap belt

- 1) Mount the strap guide according to the chapter "Strap guide" (Strap guide).
 - 2) Pull the belt out of the belt restraint (3) (see fig. 119, item 1).
 - 3) Press the adjustment buckle (4) together and pull out the belt (see fig. 119, item 2).
INFORMATION: Make sure not to push the plastic part beyond the guidance in the metal part.
 - 4) Pull out a belt pad (5).
 - 5) Run the belt between the seat and the back through the half-moon-shaped connecting piece to the back and through the first strap guide (see fig. 121, item 1).
 - 6) Run the belt behind the back and through the second strap guide (see fig. 122, item 1).
INFORMATION: If necessary, you can run the belt inside the seat cushion (no illustration).
 - 7) Run the belt between the backrest and seat to the front (see fig. 122, item 2).
 - 8) String up the belt pad (5).
 - 9) Run the end of the belt through the adjustment buckle (4) and, to complete, through the belt restraint (3) (see fig. 119, item 1/2).
- If the belt buckle (6) can be closed while being in the centre of the seat, the lap belt has been installed properly.

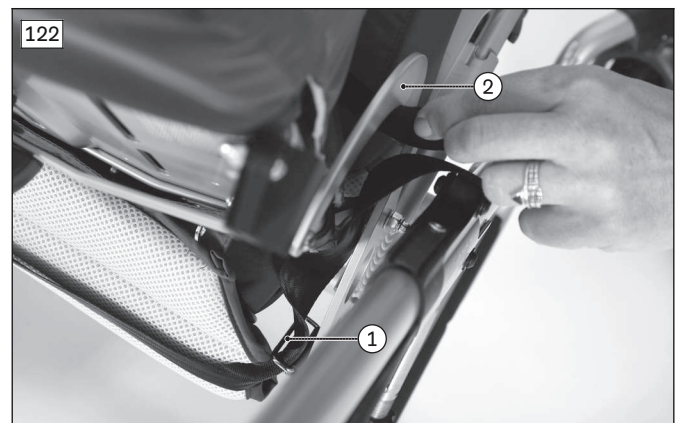
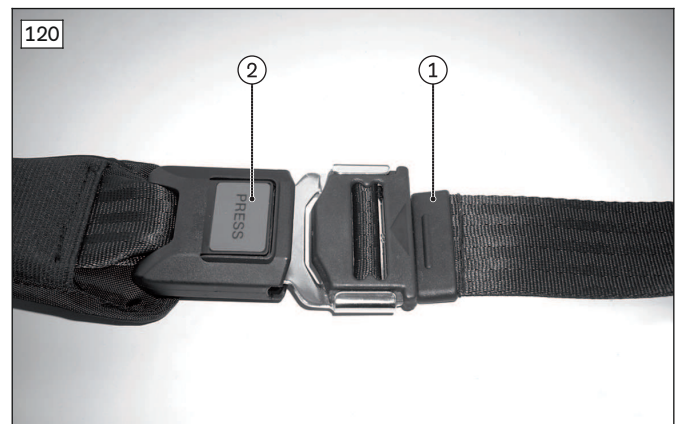
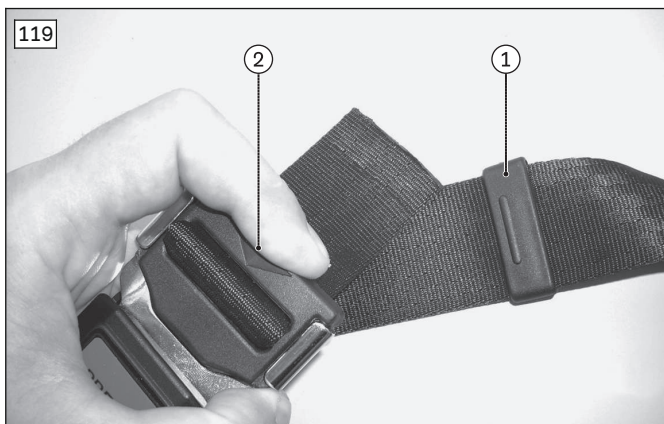

4.1.3 Four-point belt



1	Clip with rivet	5	Lap-belt part
2	Shoulder belt, left/right	6	Belt restraint
3	Belt pads	7	Adjustment buckle
4	Strap guide with attachment fitting	8	Belt buckle with release button

Installing the four-point belt

- 1) Mount the strap guide (4) according to the chapter "Strap guide" (Strap guide; see fig. 124, item 1).
 - 2) Rivet 2 clips (1) to the holes of the bottom back plate (see fig. 124, item 2).
 - 3) Run the shoulder belts (2) through the padding/back plate (see fig. 125) and secure them in the clips (see fig. 124, item 3).
 - 4) If necessary, cut off protruding belt ends of the shoulder belts and melt the free ends by applying heat (such as from a lighter).
 - 5) Mount the lap-belt part (5) according to the chapter "Lap belt" (Lap belt).
- The four-point belt is installed properly if the latches can be clipped into the buckle (8).

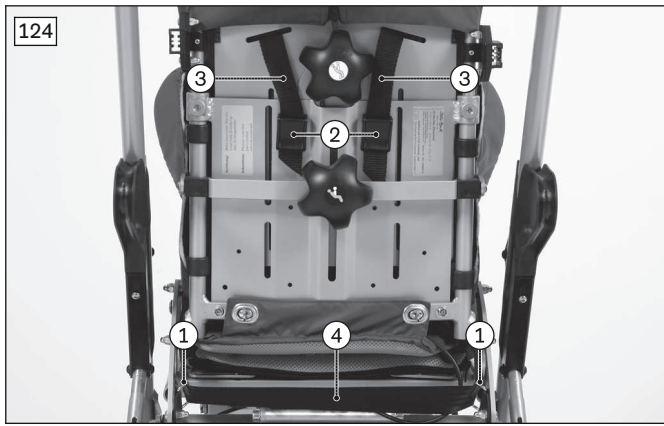

4.1.4 Five-point belt



1	Clip with rivet	6	Strap guide, fixed
2	Shoulder belt, left/right	7	Belt restraint
3	Belt pads	8	Adjustment buckle
4	Strap guide with attachment fitting	9	Crotch belt with buckle and adjustment buckle
5	Lap-belt part, left/right	10	Stop plate

Installation start

- 1) Mount the loose strap guide on the right (4) according to the chapter "Strap guide" (Strap guide).
- 2) Rivet 2 clips (1) to the holes of the bottom back plate (see fig. 124, item 2).
- 3) Run the shoulder belts (2) through the padding/back plate (see fig. 125) and secure them in the clips (see fig. 124, item 3).

Mounting the lap-belt part (5)

- 1) Run the lap belt on the right (5) between the seat and the backrest through the half-moon-shaped connecting piece to the back, through the strap guide and let it hang (see fig. 127).
- 2) Mount the fixed strap guide (6) according to the chapter "Strap guide" (Strap guide).
- 3) Run the lap belt on the left (5) between the seat and the backrest through the half-moon-shaped connecting piece to the back (see fig. 121).
- 4) String up the belt restraint (7).
- 5) Run the lap belt on the right (5) behind the seat through the adjustment buckle (8) and, to complete, through the belt restraint (7) (see fig. 128 - see fig. 130).

For pressing together/threading through the adjustment buckle: Lap belt.

**Mounting the crotch belt (9)**

- 1) Thread the crotch belt, with the proper side, through the front slot of the seat plate (see fig. 131, item 1).
- 2) Thread the crotch belt twice through the stop plate (10) and back up through the seat plate (see fig. 131, item 2).
- 3) Thread the crotch belt a second time below the crossbar of the adjustment buckle (see fig. 132, item 1).

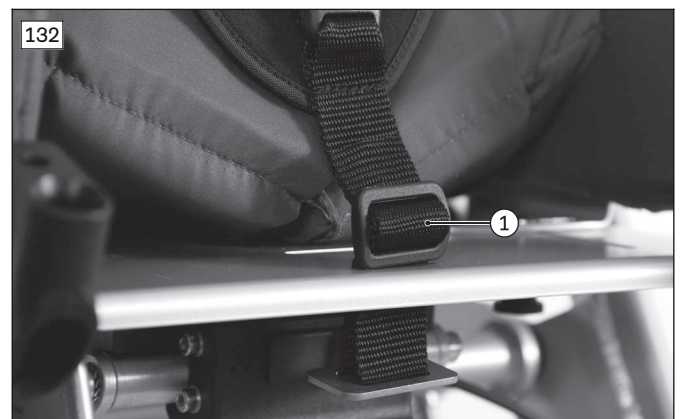
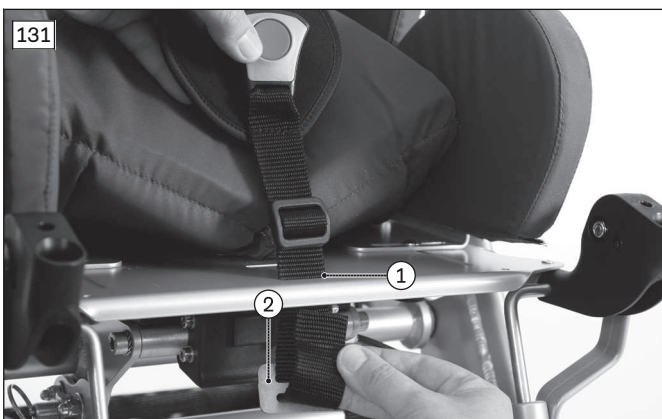

Completing the installation

- ▶ If necessary, cut off protruding belt ends of the shoulder belts and melt the free ends by applying heat (such as from a lighter).
- The five-point belt is installed properly if the latches can be clipped into the buckle (9).

4.2 Positioning aids

4.2.1 Abductor

- 1) Place the abductor in the desired position on the seat plate (see fig. 133, item 1) and fasten it with screws from below loosely (see fig. 134, item 1).

INFORMATION: When using a slip sack, make a cut in it in the specified spot, insert the slip sack and fasten the abductor with screws loosely.

- 2) Adjust the depth of the abductor in the slotted hole if necessary.
- 3) Now fasten the abductor with screws tightly.

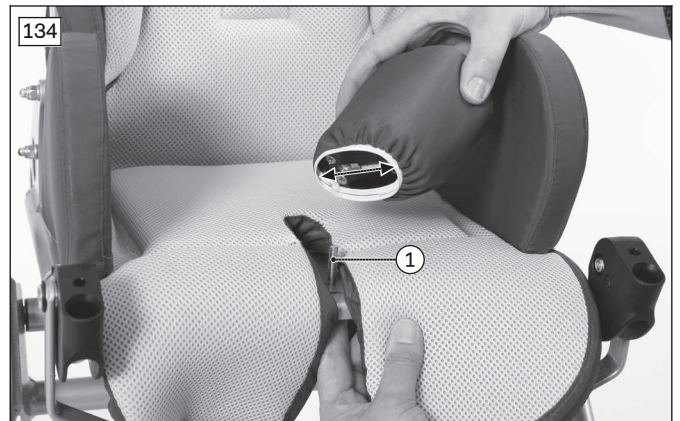
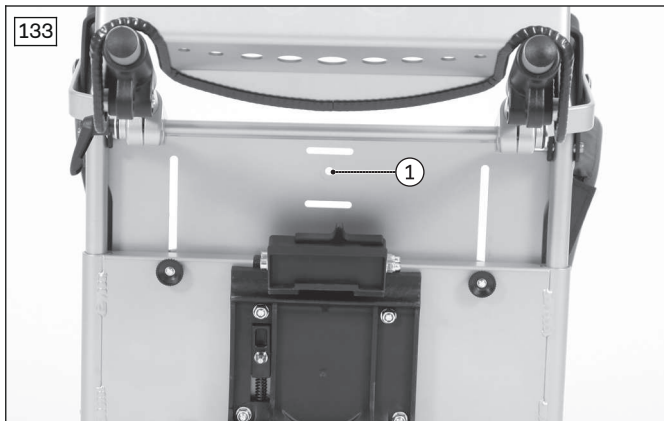

4.2.2 Pelvic band

For installation information, consult the instructions that come with the product.

4.2.3 Chest and shoulder support

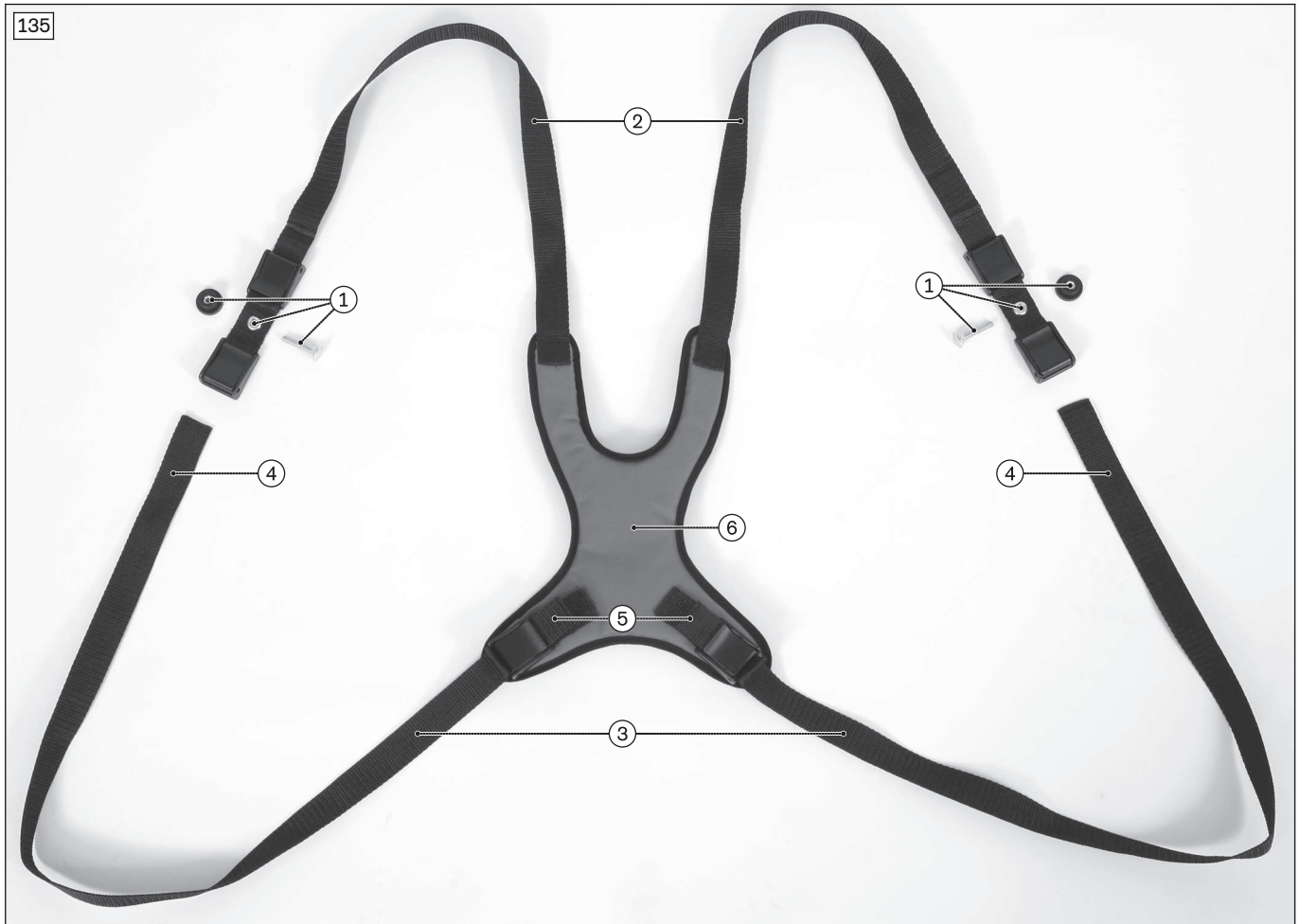

1	Pair of clips with attachment fitting	4	Belt end of bottom attachment strap
2	Shoulder belt	5	Sewn-on clip
3	Bottom attachment strap	6	Support

Mounting the chest and shoulder support

- 1) Mount the strap guide according to the chapter "Strap guide" (Strap guide).
- 2) Mount the pairs of clips (1) using mounting screws/knurled nuts in the slotted holes of the bottom back plate (see fig. 136, item 1/see fig. 137, item 1).
- 3) Place the chest and shoulder support on the seat bottom – the sewn-on clips (5) must point towards the seat bottom.
- 4) Run the shoulder belt (2) through the padding/back plate (see fig. 125) and secure it in the top clips (see fig. 137, item 2).
- 5) Run the bottom attachment straps (4) between the seat bottom and backrest to the back through the strap guide and secure them in the bottom clips (see fig. 137, item 3).
- 6) If necessary, cut off protruding belt ends of the attachment straps and melt the free ends by applying heat (such as from a lighter).

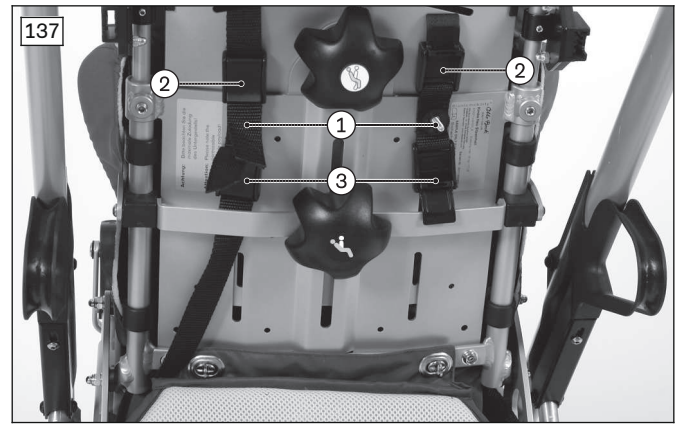
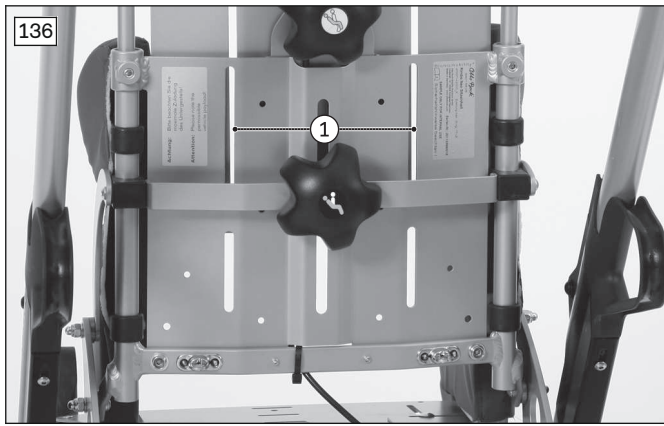

4.2.4 Fixation vest

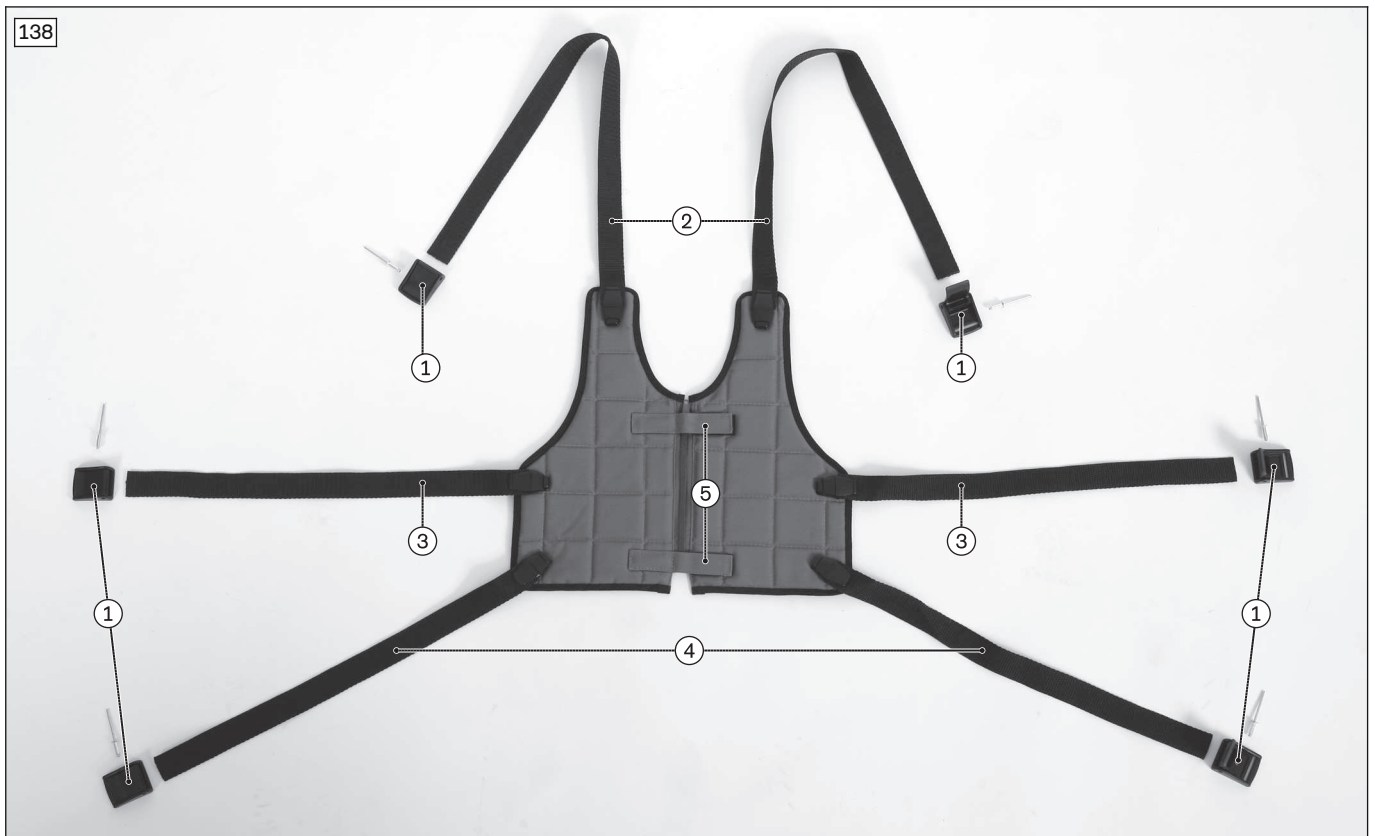

1	Clip with rivet	4	Bottom attachment strap
2	Shoulder belt	5	Buckle
3	Middle attachment strap		

Mounting the fixation vest

- 1) Rivet 6 clips (1) to the holes of the bottom back plate (see fig. 139, item 1/see fig. 140, item 1).
 - 2) Place the fixation vest on the seat bottom - the buckles (5) must point towards the seat bottom.
 - 3) Run the shoulder belts (2) through the padding/back plate (see fig. 125) and secure them in the clips (see fig. 140, item 2).
 - 4) Run the middle/bottom attachment straps (3/4) around the backrest tubes to the back and secure them in the clips (1) (see fig. 140, item 3).
- INFORMATION: For improved guidance of the middle/bottom attachment straps (3/4), you can additionally install strap guides.**
- 5) If necessary, cut off protruding belt ends of the attachment straps and melt the free ends by applying heat (such as from a lighter).

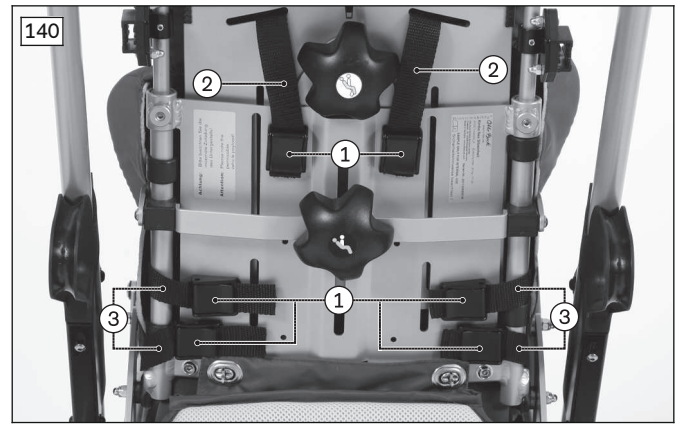
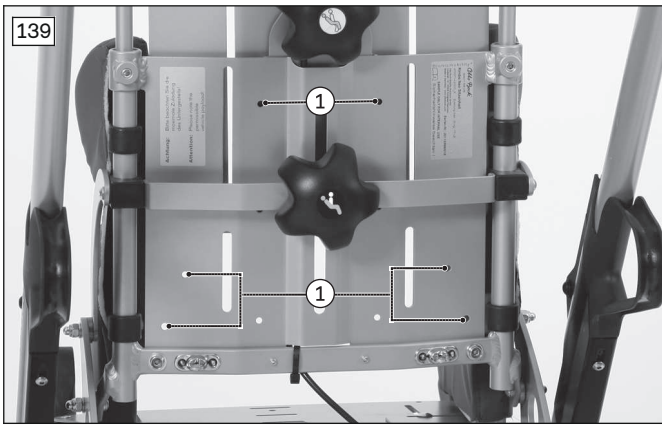

4.2.5 Groin strap

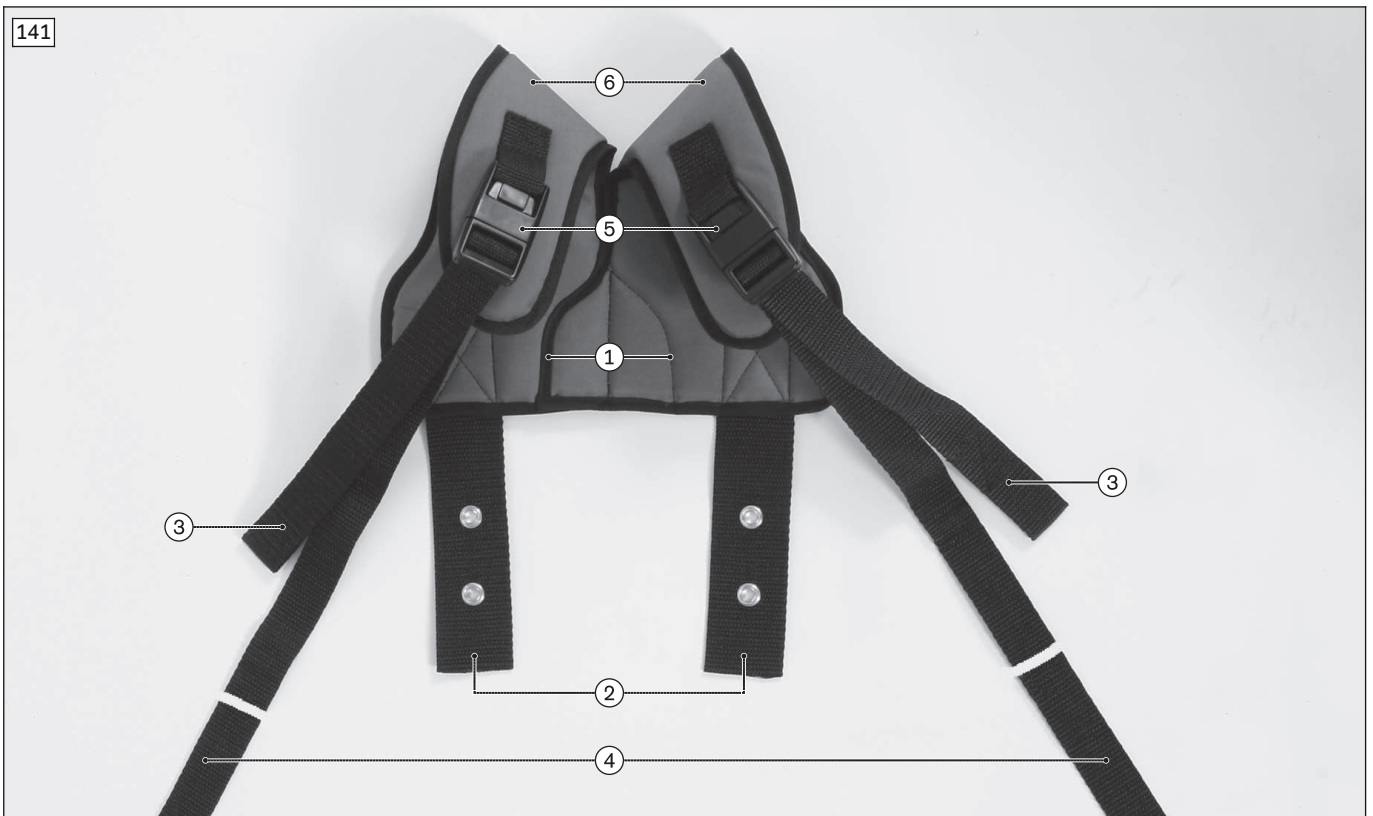

1	Underside groin strap	4	Long attachment strap
2	Attachment strap with loop	5	Strap adjustment/plug connection
3	Free belt end for length adjustment	6	Leg strap

Mounting the groin strap

- 1) Place the groin strap, underside (1) down, on the seat cushion; the attachment strap with the loop (2) must face backwards.
- 2) Run the attachment strap with the loop (2) between the back support and seat bottom and secure it under the seat bottom (see fig. 143). Use the screws/knurled nuts to adjust the depth/width of the seat (see fig. 143, item 1).
- 3) Rivet the clips to the holes of the bottom back plate (see fig. 142, item 1; see fig. 143, item 2).
- 4) Run the belt ends of the long attachment strap (4) around the back support and secure them in the clips (see fig. 143, item 3).
- 5) If necessary, cut off protruding belt ends of the long attachment strap (4) and melt the free ends by applying heat (such as from a lighter).

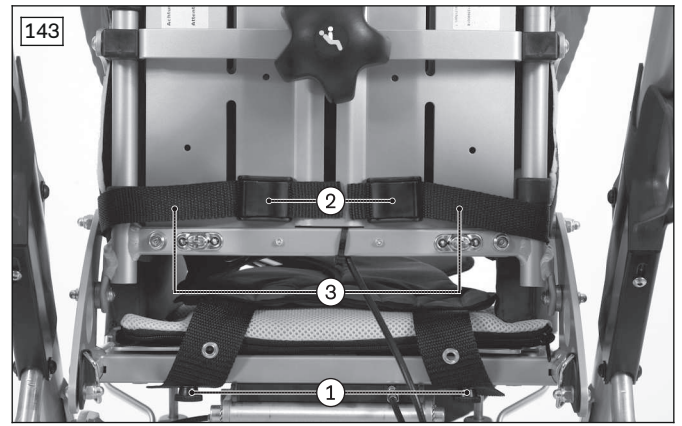
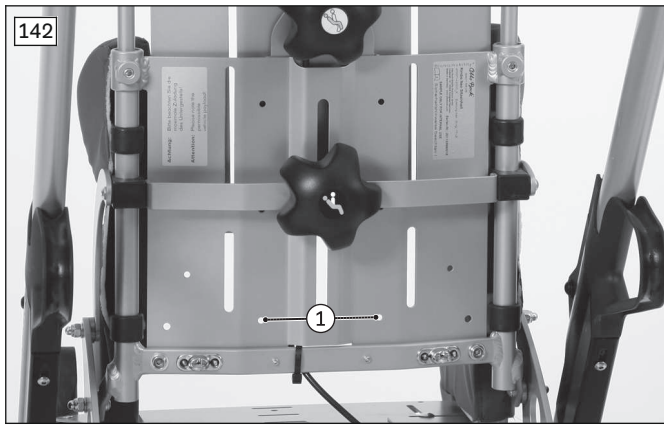

4.2.6 Neck support

- 1) Determine the medically required position of the neck support.
- 2) Thread the neck support through the back padding and the back plate.
- 3) Adhere the two hook-and-loop straps for securing the neck support to the back plate. Do this flexibly, according to the installation situation.
- 4) Secure the neck support firmly.

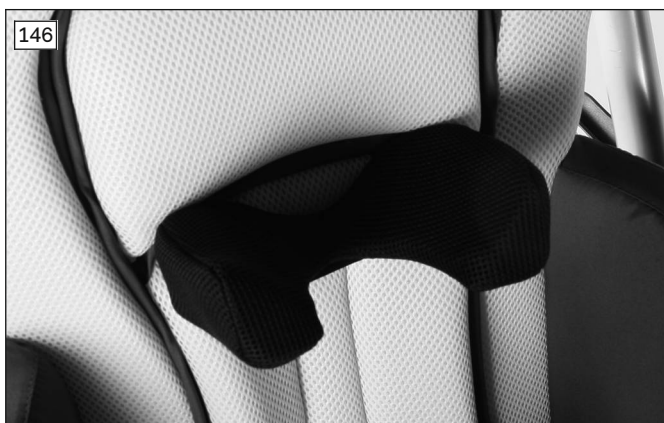
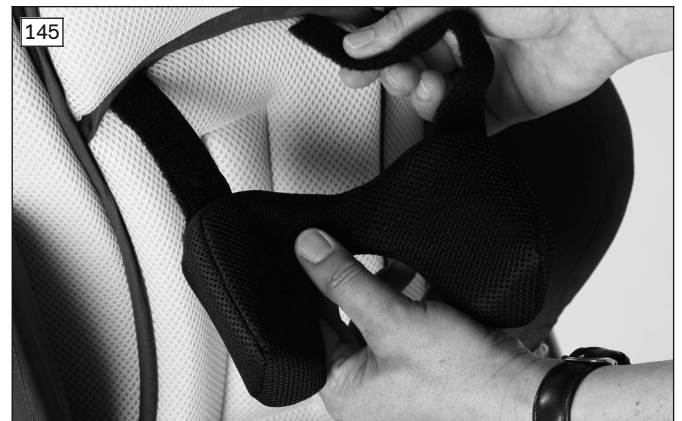

4.2.7 Lumbar padding

- 1) Open the zipper on the backrest padding and fold the backrest pad forward.
- 2) Determine the medically required position of the lumbar padding.
- 3) Adhere the supplied hook-and-loop straps for securing the lumbar padding to the back plate (see fig. 148) or use the existing hook-and-loop straps.
- 4) Secure the lumbar padding.
- 5) Pull the back padding with its cap over the back insert and close the zipper.



4.2.8 Hook-and-loop foot straps

Attach the hook-and-loop foot straps to the heel part of the footplate with two rivets or screws positioned beside one another. The holes must be inserted in the footplate accordingly.

In addition, hook-and-loop foot straps can also be used for the forefoot area.



4.3 Armrests

⚠ CAUTION

Improper lifting by attendants

User may fall or tip over

- ▶ The armrests must not be used to lift the seating unit or the entire rehab buggy.

INFORMATION

Please note that the armrests cannot be combined with the options "grab rail" or "tray", as the same mounts are used.

Removing/mounting the armrests

- 1) Press in the tripod spring (see fig. 151).
- 2) Pull the armrest up and out or insert the armrest into the adapter.

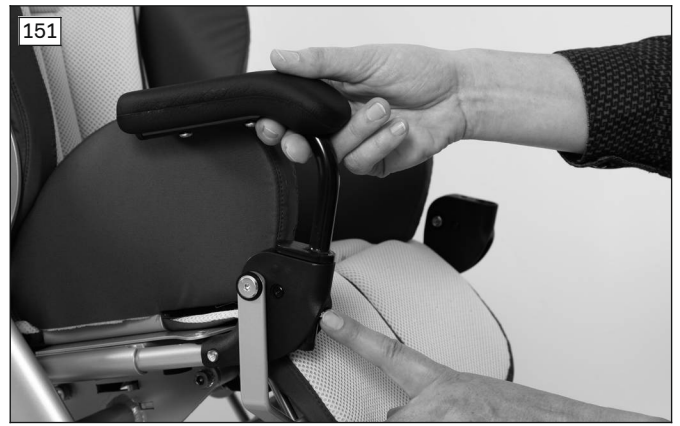
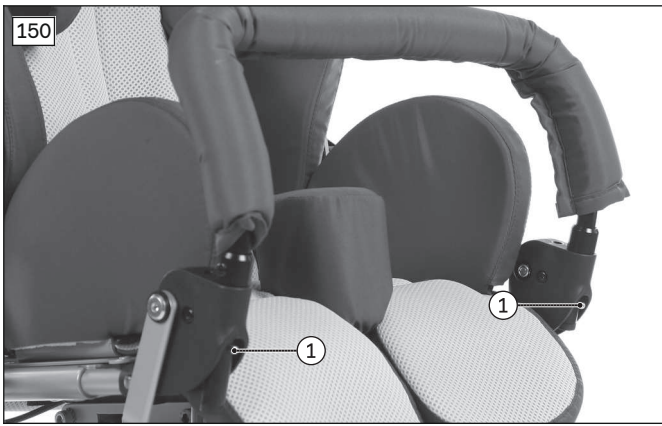

4.4 Tip-assist

- 1) Install the tip-assist on the lashing point at the rear with 2 mounting screws (see fig. 152, item 1).
- 2) Firmly tighten the cap nuts (see fig. 153, item 1).

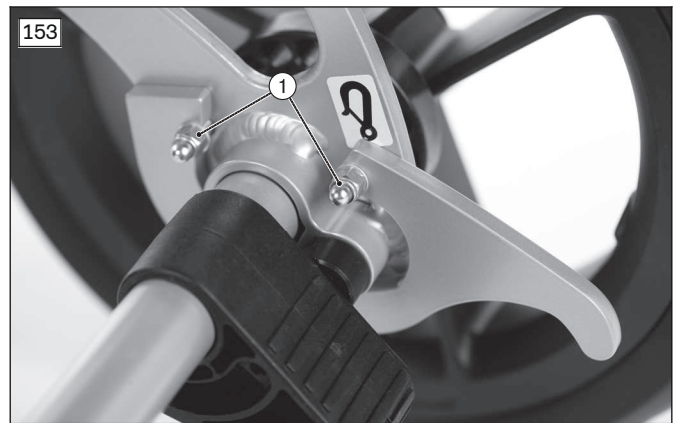

4.5 Tray

⚠ CAUTION

Improper lifting by attendants

Falling, tipping over of the user due to lifting by removable components

- ▶ The product must not be lifted by the tray.

NOTICE

Overloading

Damage to the product through user error

- ▶ Trays must not be loaded with heavy objects.

INFORMATION

- ▶ Please note that the tray cannot be combined with the options "armrests" or "grab rail", as the same mounts are used.
- ▶ Please note that the tray can be used only when the seat is facing forward.

The seating unit can be equipped with a tray on which objects can be placed directly next to the seat. The tray is mounted on the seating unit and secured against rotation.

Mounting the tray

- 1) Plug the tray into the adapters.
- 2) Push in the tripod spring (see fig. 154, item 1).
- 3) Press down the tray until the tripod springs lock into place.

Removing the tray

- 1) Push in the tripod spring (see fig. 154, item 1).
- 2) Pull the tray out and up.

Adjusting the tray position

- 1) **Adjust height:** loosen the Allen screws on the frame with a size 4 Allen wrench (see fig. 154, item 2) and adjust the frame in parallel on both sides. Retighten the Allen head screws.
- 2) **Adjust depth:** release the adjustment lever under the tray and set the depth by moving the tray (see fig. 155, item 1). Then firmly close the adjustment lever.
- 3) **Adjust the angle:** release the adjustment lever under the tray and set the tray angle by turning the tray at the joint (see fig. 155, item 2). Then firmly close the adjustment lever.

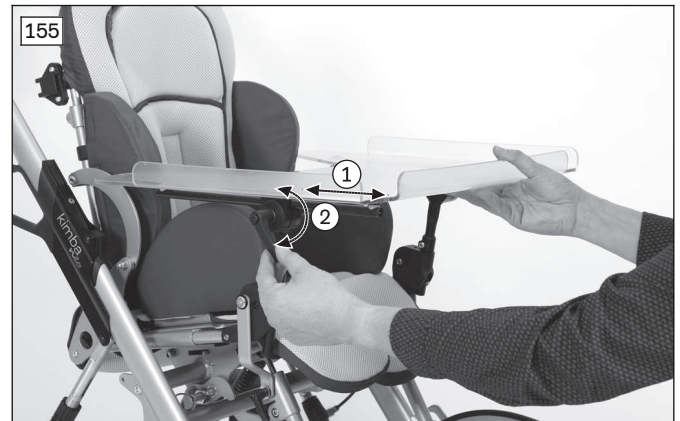
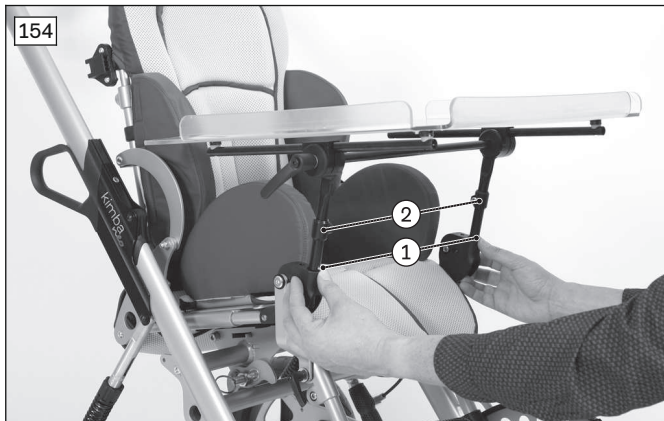
**4.6 Storage bag****NOTICE****Incorrect attachment**

Damage to the product

- ▶ During the attachment, make sure that the product cannot grind against the wheels.
- ▶ Mount the storage basket, with the proper side, to the frame using the snap fasteners and the hook-and-loop strap (see fig. 156, item 1/see fig. 157, item 1).

**4.7 Platform for respirator****⚠ WARNING****Improper use in vehicles for transporting persons with reduced mobility**

Severe accidental injuries caused by use with untested product combinations

- ▶ Use of the product in vehicles for transporting persons with reduced mobility in combination with the artificial respiration platform option is **not** permitted.

INFORMATION

The respirator platform cannot be installed on a product with fixed front wheels.

The respirator platform can be installed as follows:

- Installation of the large T1 respirator platform over the front wheels (see fig. 158) – the user sits in the seat facing away from the direction of travel
- Installation of the large T1 respirator platform over the rear wheels (see fig. 159) – the user sits in the seat facing in the direction of travel

The respirator is attached to the respirator platform using straps through the slots.

Using an anti-slip mat is recommended.

The seating unit can only be turned around if the respirator platform is moved.



Respirator platform mounting kit overview

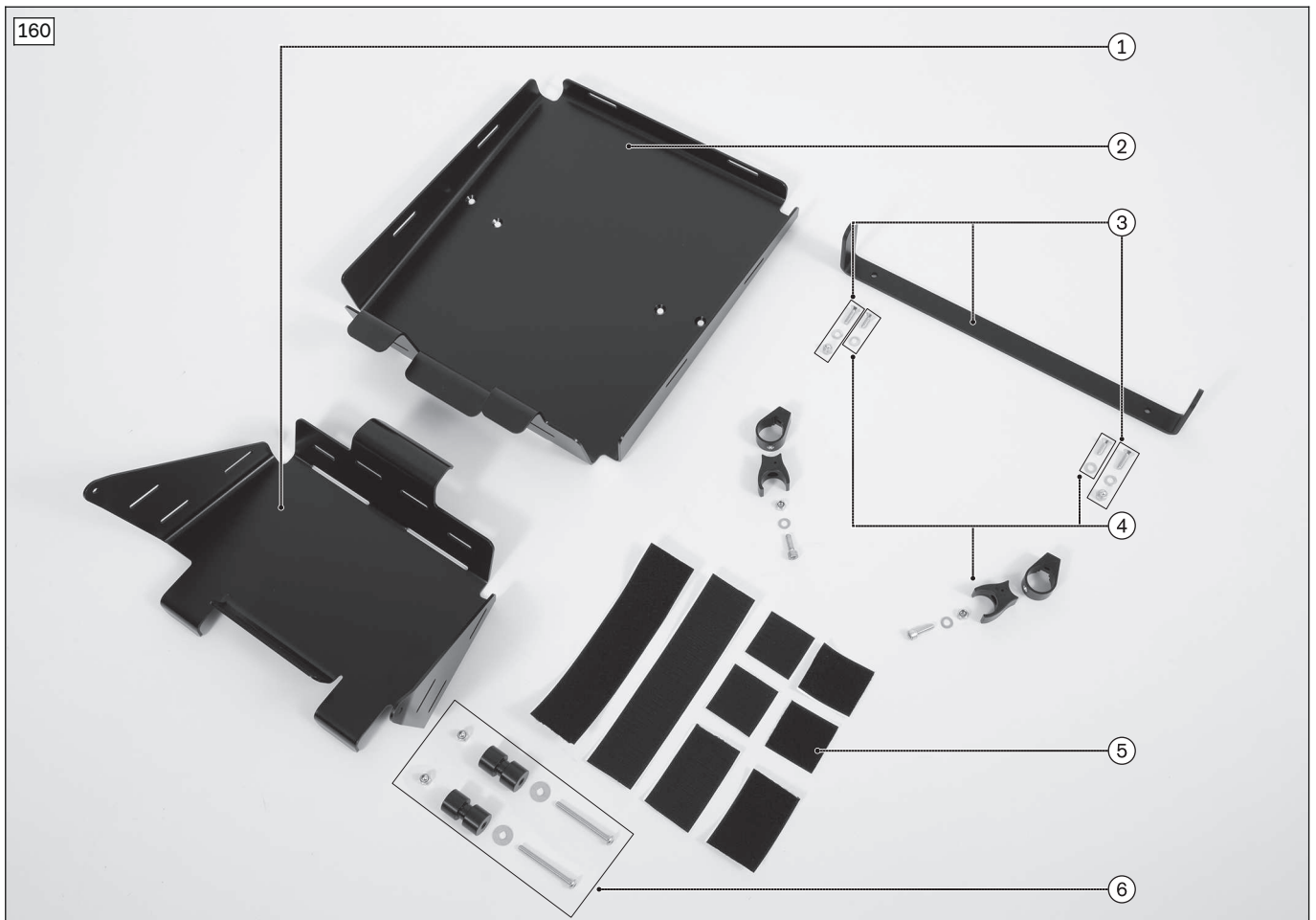

1	T2 respirator platform	4	Bottom supports (with mounting materials)
2	T1 respirator platform	5	Hook-and-loop straps
3	Retaining bracket with mounting materials	6	Side supports (with mounting materials)

4.7.1 Installation with a seat facing opposite to direction of travel

Installing the T2 respirator platform

- 1) Glue the loop strap onto the centre of the front frame tube (see fig. 161).
INFORMATION: Trim the length to approx. 210 mm for size 1 and approx. 290 mm for size 2.
 - 2) As shown in the image, glue the hook strap onto the angle tabs of the T2 respirator platform (see fig. 162).
 - 3) Set the T2 respirator platform onto the front frame tube and axle tube (see fig. 163).
 - 4) Lift up the T2 respirator platform on the axle tube. Under the angle tabs, glue 2x loop strap in the size 50 x 50 mm onto the axle tube (see fig. 164).
 - 5) Press the T2 respirator platform into place.
- The T2 respirator platform is installed (see fig. 163).

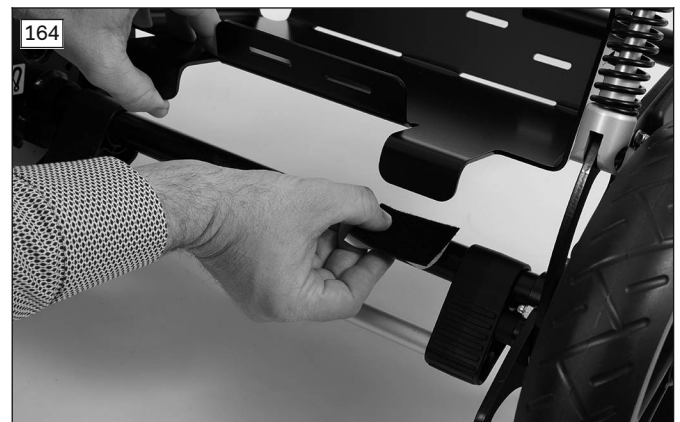
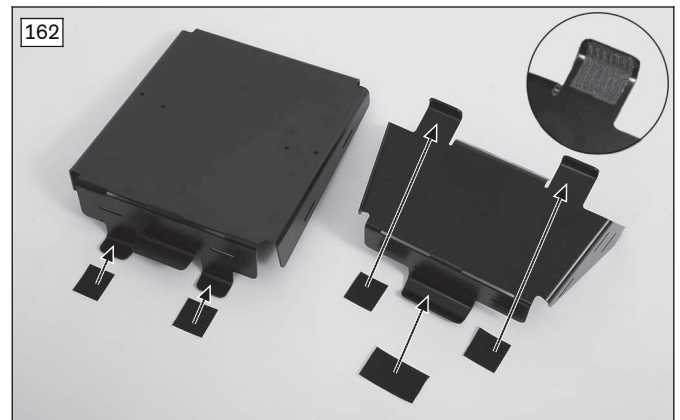

Installing the T1 respirator platform

- 1) As shown in the image, glue the hook strap onto the angle tabs of the T1 respirator platform (see fig. 162).
 - 2) Screw the retaining bracket onto the T1 respirator platform (see fig. 165, item 1; see fig. 166, item 1).
 - 3) Screw the supports onto the retaining bracket (see fig. 165, item 2).
INFORMATION: Only installing one support on the retaining bracket initially is recommended. The second support is installed on the retaining bracket when the T1 respirator platform is mounted on the front frame.
 - 4) Set the T1 respirator platform onto the front frame tube (see fig. 167, item 1).
 - 5) Engage the supports of the T1 respirator platform in the lashing points and install (see fig. 168; see fig. 167 item 2).
- The T1 respirator platform is installed (see fig. 167).

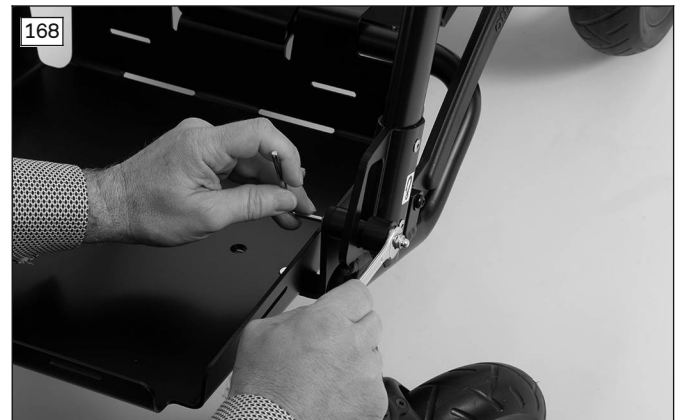
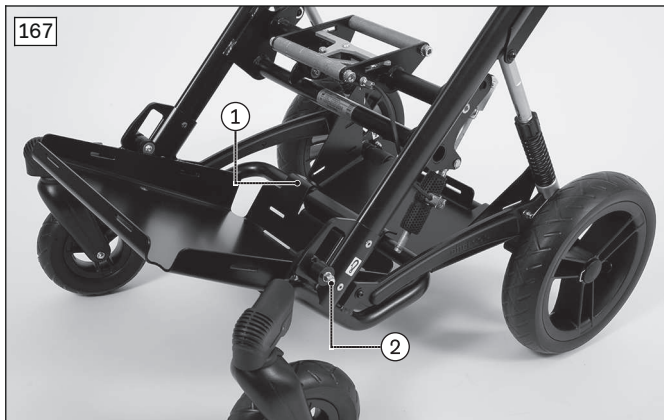
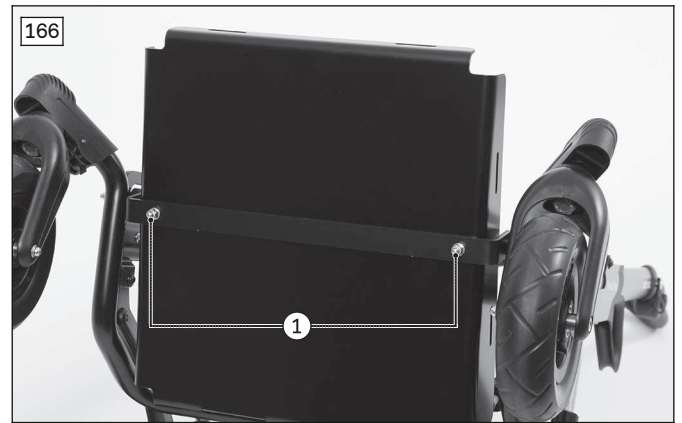
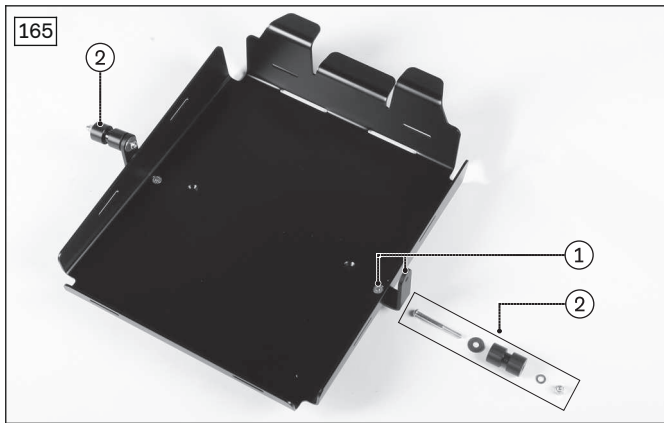

4.7.2 Installation with a seat facing in the direction of travel

Installing the T2 respirator platform

- 1) Glue the loop strap onto the front frame tube (see fig. 161).
INFORMATION: Trim the length to approx. 210 mm for size 1 and approx. 290 mm for size 2.
 - 2) As shown in the image, glue the hook strap onto the angle tabs of the T2 respirator platform (see fig. 162).
 - 3) Screw the supports onto the T2 respirator platform (see fig. 169, item 1).
INFORMATION: Only installing one support on the retaining bracket initially is recommended. The second support is installed on the retaining bracket when the T2 respirator platform is mounted on the front frame.
 - 4) Set the T2 respirator platform onto the front frame tube (see fig. 170, item 1).
 - 5) Engage the supports of the respirator platform in the lashing points and install (see fig. 171; see fig. 170 item 2).
- The T2 respirator platform is installed (see fig. 170).

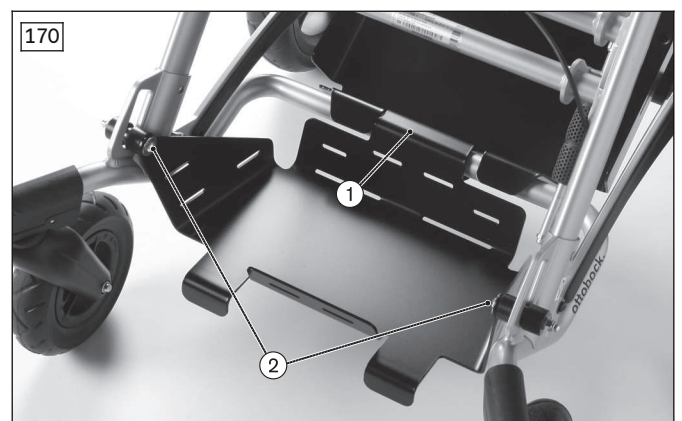
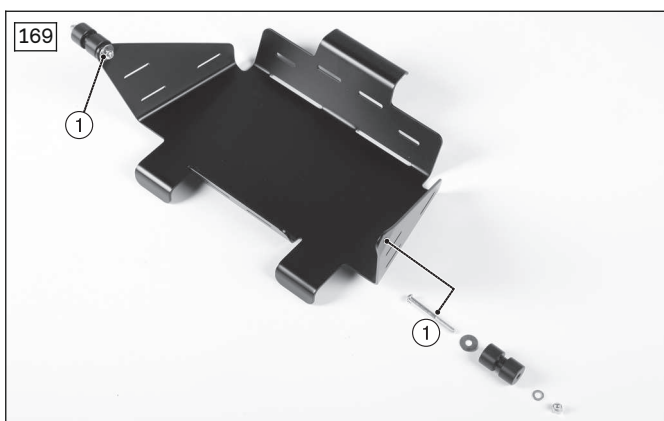



Installing the T1 respirator platform

- 1) As shown in the image, glue the hook strap onto the angle tabs of the T1 respirator platform (see fig. 162).
 - 2) Screw the supports in place under the T1 respirator platform (see fig. 172, see fig. 173).
 - 3) Set the T1 respirator platform onto the front frame tube (see fig. 174, item 1).
 - 4) Carefully press the clamp fittings of the supports onto the axle tube until they engage (see fig. 174, item 2/3).
- The T1 respirator platform is installed (see fig. 175).

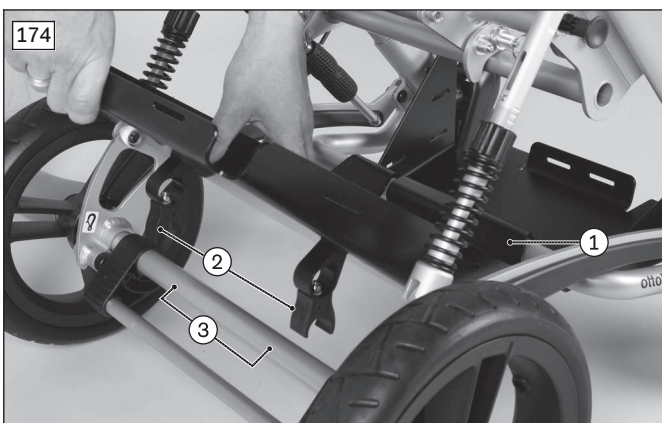

4.8 Canopy adapter

INFORMATION

The canopy adapter is used for the subsequent installation of the canopy to a multifunctional seating unit. For information on this, see the Instructions for Use (User) - reference number 647G892.

- 1) Loosen the set screws at the back tube (see fig. 176, item 1) and pull the back insert up.
- 2) Slide the canopy adapter with the proper side onto the backrest bar (see fig. 177).
- 3) Pre-position the canopy adapter in a level manner (see fig. 177).

- 4) Tighten the set screws of the canopy adapter again.
- 5) Put on the back insert and tighten again the set screws at the back tube.

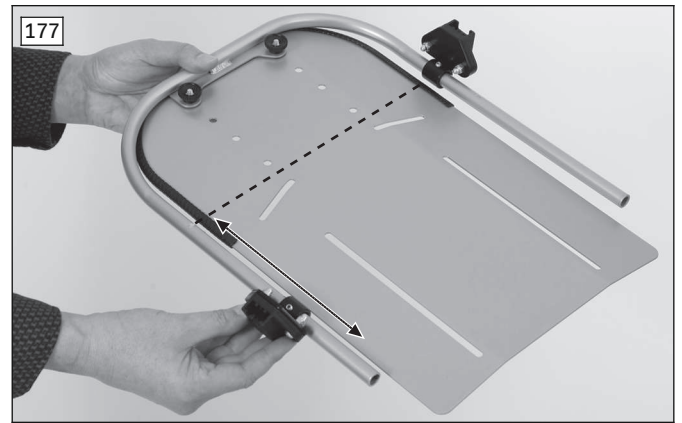
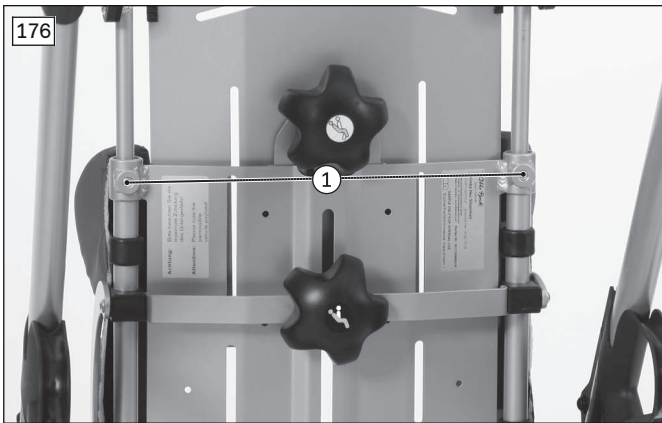

4.9 Canopy

⚠ CAUTION

Exposed pinch points

Crushing, pinching due to incorrect handling

- ▶ When folding out the backrest, only grip by the specified components.

The rehab buggy can be equipped with a canopy to protect the user from sun or rain (see fig. 178).

Mounting the canopy

- 1) Move the backrest to an upright position.
- 2) Move the locking tongues for the canopy into parallel mounting position (see fig. 179).
- 3) Press the locking tongues for the canopy into the buckles (see fig. 179, item 1) until they click into place audibly (see fig. 179, item 2).

Adjusting the canopy angle

- 1) Fold up the canopy.
- 2) Hold the canopy at the front support and change the angle by pressing or pulling on the support. The setting joint locks into place automatically (see fig. 179, item 3).

Removing the canopy

- 1) Move the backrest to an upright position.
- 2) Release the locking tongues for the canopy from the buckle by pressing lightly (see fig. 179, item 2).
- 3) Pull the locking tongues out and remove the canopy.

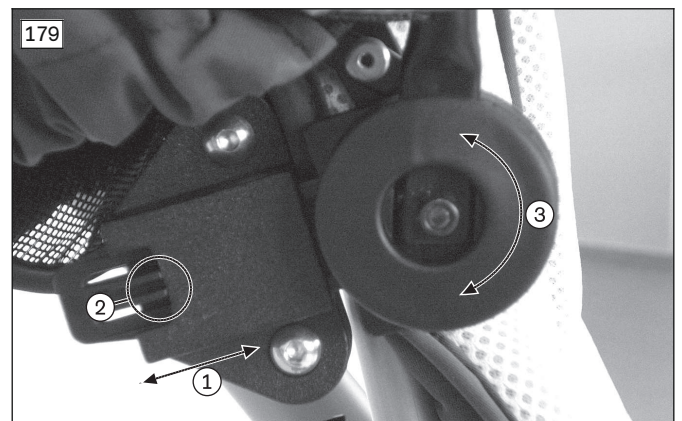

Special features of the canopy

- Opening the window allows for permanent visual contact with the child (see fig. 180).
- Removal of the back part allows for improved ventilation (e.g. in case of accumulating heat in summer; see fig. 181).
- The rain cover bag contains the rain cover.



4.10 Rain cover

For mounting information, see the Instructions for Use (User) - reference number 647G892.

4.11 Summer/winter slip sack

NOTICE

Incorrect attachment

Damage to the product

- ▶ During the attachment, make sure that the product cannot grind against the wheels.

- 1) When needed, make a cut in the slip sack for putting through the lap belt (see fig. 182, item 1), the abductor/five-point belt (see fig. 182, item 2) or the groin strap (see fig. 182, item 3).
- 2) Fasten the attachment cords depending on the attachment situation:
 - Back: e.g., at the seat plate (see fig. 183, item 1)
 - Front: e.g., at the footrest tube (see fig. 183, item 2)



4.12 Footrest padding

- 1) Cut the self-adhesive hook-and-loop straps to length and secure them to the outer sides of the footrest.
- 2) Secure the padding to the hook-and-loop straps on the footrest.



4.13 Anti-slip lining

- 1) Clean the supporting surface of the footrest.
- 2) Adhere the self-adhesive anti-slip lining to the footrest, covering the whole surface.



4.14 Foot block for shortening the lower leg length

- 1) Clean the supporting surface of the footrest.
- 2) Glue on the self-adhesive hook-and-loop strap at the correct distance (see the underside of the foot block for the distance).
- 3) Press the foot block on to the hook-and-loop strap.



4.15 Incontinence cover

The incontinence cover (see fig. 189) protects the padding of the Kimba Neo seating unit. The incontinence cover can be removed for washing. Close the hook-and-loop straps before washing.



Attaching the incontinence cover

- 1) Remove the seat padding and the back padding from the seating unit (Detaching/attaching the padding for cleaning et seq.).
- 2) Lay out the incontinence cover ready for the seat and back padding. To do this, open all the hook-and-loop straps (see fig. 190).
- 3) Place the seat padding in the incontinence cover.
- 4) Secure the incontinence cover to the back padding:
 - Place the back padding on the incontinence cover (see fig. 191).
 - Guide the lower 3 hook-and-loop straps around the back padding and strap them together (see fig. 192, item 1).
 - Thread the vertical hook-and-loop straps through the back padding (see fig. 192, item 2).
- 5) Secure the back padding to the seating unit:
 - Pull the back padding with its cap over the back insert.
 - Guide the vertical hook-and-loop straps towards the rear over or through the back plate (see fig. 193, item 1).
 - Guide the upper horizontal hook-and-loop strap around the back plate and strap it together (see fig. 193, item 2). In doing so, the vertical hook-and-loop straps must be secured with the horizontal hook-and-loop strap (see fig. 193, item 3).
- 6) Push the back padding towards the rear and secure it to the back of the seating unit with the twist lock.



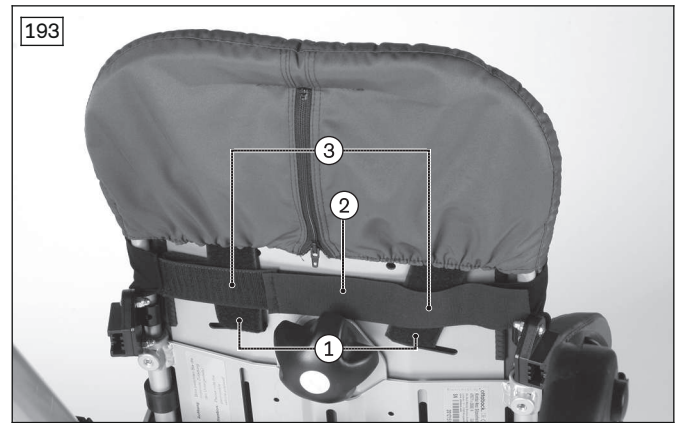

Removing and cleaning the incontinence cover

- 1) Remove the seat padding and the back padding from the seating unit (Detaching/attaching the padding for cleaning et seq.).
- 2) Remove the incontinence cover from the seat padding and lay it down.
- 3) Remove the incontinence cover from the back padding. To do this, open all the hook-and-loop straps and remove the incontinence cover from the back padding.
- 4) Wash the incontinence cover according to the washing symbols on the label with care instructions.

INFORMATION: Fully close the hook-and-loop straps before washing.

5 Appendices

5.1 Technical data

INFORMATION

- ▶ Much of the technical data below is given in mm. Please note that product settings – unless otherwise specified – cannot be adjusted in the mm range but only in increments of approx. **0.5 cm** or **1 cm**.
- ▶ Note that the values achieved during adjustment may deviate from the values specified below. The deviation can be **±10 mm** and **±2°**.

Outdoor mobility base	Size 1	Size 2 ¹⁾
Overall width [mm]	600	700
Front wheel diameter, "swivelling" front wheels [mm/inch]	170/6.7	170/6.7
Front wheel diameter, "fixed" front wheels [mm/inch]	280/11	---
Rear wheel diameter [mm/inch]	280/11	280/11
Push handle height (min./max.) [mm]	710/1160	710/1160
Seat tilt (seating unit angle (min./max.)) [°]	-40/+10 or -10/+40	-40/+10 or -10/+40
Max. load capacity ²⁾ [kg]	55	55
Max. load storage bag ²⁾ [kg]	7	7
Weight of mobility base [kg]	10.5	11.5
Folded size without seat (LxWxH) [mm]	790x600x470	790x700x470
Min. folded size with seat facing forwards; seat tilted backwards 10°, back angle 100° (LxWxH) [mm]	900x600x530 ³⁾	970x670x590

¹⁾ The outdoor mobility base with fixed front wheels in size 2 is available only as a custom fabrication.

²⁾ The load capacity differs between the outdoor mobility base and the seating unit:

- Seating unit (max. 40 kg) + own weight of the seating unit, size 1 (7.5 kg) = 47.5 kg
- Outdoor mobility base (max. 55 kg) – fully loaded seating unit (47.5 kg) = 7.5 kg for other accessories + weight in storage bag

³⁾ Folded dimensions of the outdoor mobility base with fixed front wheels: 970x600x530 mm.

Multifunctional seating unit	Size 1	Size 2
Seat width [mm]	200 – 300	260 – 350
Seat depth [mm]	190 ²⁾ – 310	240 – 400
Backrest height [mm]	410 – 610	560 – 700
Backrest angle [°]	80 – 180 ^{3) 5)}	80 – 180 ⁵⁾
Height of shoulder strap slots (min./max.) [mm]	300/450	300/450
Width of shoulder strap slots [mm]	50	50
Lower leg length [mm]	190 – 310	200 – 370
Max. load capacity ¹⁾ [kg]	40	40
Max. load capacity with use in vehicles for transporting persons with reduced mobility ⁴⁾ [kg]	40	40
Weight [kg]	7	8.5
Folded size with lateral supports (LxWxH) [mm]	580x370x420	590x430x580

¹⁾ The load capacity differs between the Kimba outdoor mobility base and the seating unit:

- Seating unit (max. 40 kg) + own weight of the seating unit, size 1 (7.5 kg) = 47.5 kg
- Outdoor mobility base (max. 55 kg) – fully loaded seating unit (47.5 kg) = 7.5 kg for other accessories + weight in storage bag

²⁾ Possible with seat depth reducer option from **140 mm**.

³⁾ With seat depth reducer option: **80° – 160°**

⁴⁾ Please see instructions in the section "Use in vehicles for transporting persons with reduced mobility".

⁵⁾ With back angle limiter size 1: **80° – 131°**, size 2: **80° – 135°**.

5.2 Maintenance Schedule

5.2.1 Maintenance Schedule – Outdoor Mobility Base

Maintenance Schedule		Kimba Neo (outdoor mobility base)	Customer:	
Item	Area	Inspection (checklist)		
Serial number:	Function/setting (depending on equipment)	Inspected for damage/deformation	Screw connections inspected*	
1	Caster wheels	Tyres (wear)	x	
		Air pressure (only with pneumatic tyres)	x	
		Fork/caster wheel axles	X	x
		Swivel lock mechanism	x	x
		Running behaviour of the wheels (concentricity)	x	
2	Rear wheels	Tyres (wear)	x	
		Air pressure (only with pneumatic tyres)	x	
		Bearings	x	x
		Quick-release lock	x	x
		Running behaviour of the wheels (concentricity)	x	
3	Seat adapter/seat adjustment	Ratchet mechanism	x	x
		Seat adapter	x	x
		Porter cylinder	x	x
		Porter cylinder ease of operation	x	
		Angle adjustment lock	x	x
		Bowden cable	x	x
4	Suspension/rear wheel linkage (with wheel lock)	Stability	x	x
		Spring tension	x	x
		Mounting points	x	x
		Wheel lock mechanism	x	x
		Wheel lock operation	x	
5	Frame	Rivet joints/screw connections	x	x
		Mounting points	x	x
		Folding tube/fixed tube head	x	x
		Folding mechanism	x	x
6	Push bar	Ratchet joints	x	x
		Angle adjustment	x	
		Push bar cover	x	
Accessories				
7	Storage bag		x	x
Do the wheelchair settings match the user's requirements?				
The maintenance service was performed by:				on:

* For some components: rivet joints or attachment checked

5.2.2 Seating Unit Maintenance Schedule

Maintenance Schedule		Kimba Neo (multifunctional seating unit)	Customer:	
Item	Area	Inspection (checklist)		
Serial number:		Function/setting (depending on equipment)	Inspected for damage/deformation	Screw connections inspected
1	Pads/covers	Surface (wear)	x	
		Closures	x	x
2	Back frame	Angle adjustment (clamping)	x	x
		Back insert	x	x
		Knob (attachment + function)	x	x
		Clamp tie-bar	x	x
		Tilt activation mechanism/Bowden cable	x	x
3	Footplate	Height setting	x	x
		Footplate lock	x	x
4	Knee angle assembly	Depth adjustment	x	x
		Angle adjustment	x	x
		Struts/clamping lever	x	x
5	Base frame (seat frame)	Clamping of the knee angle assembly	x	x
		Quick-release lock	x	x
		Seat angle adjustment activation mechanism	x	x
		Bowden cable	x	x
		Seat adapter (engages audibly)	x	
6	Standard supports	Width adjustment	x	x
		Padding	x	
Accessories				
7	Armrests	Tripod springs (locking mechanism)	x	x
8	Grab rail/padding for grab rail	Tripod springs (locking mechanism)	x	x
		Surface (wear)	x	
9	Pelvic band	Toothed belt (locking mechanism)	x	x
10	Canopy/canopy adapter	Angle adjustment	x	x
		Plug connection to the adapter	x	x
		Ratchet function	x	x
11	Tray	Tripod springs (locking mechanism)	x	x
		Angle adjustment	x	x
		Depth adjustment	x	x
12	Thoracic supports	Width adjustment	x	x
		Height adjustment	x	x
13	Chest and shoulder support	Attachment buckles	x	x
		Seams	x	
14	Fixation vest	Attachment straps	x	x
15	Belts (4/5-point)	Attachment and strap guide buckles	x	x
		Seams/belting	x	
		Buckle	x	
16	Abductor	Depth adjustment	x	x
Do the wheelchair settings match the user's requirements?				
The maintenance service was performed by:			on:	

Kundenservice/Customer Service

Europe

Otto Bock HealthCare Deutschland GmbH
Max-Näder-Str. 15 · 37115 Duderstadt · Germany
T +49 5527 848-3433 · F +49 5527 848-1460
healthcare@ottobock.de · www.ottobock.de

Otto Bock Healthcare Products GmbH
Brehmstraße 16 · 1110 Wien · Austria
F +43 1 5267985
service-admin.vienna@ottobock.com · www.ottobock.at

Otto Bock Adria d.o.o. Sarajevo
Ramiza Salčina 85
71000 Sarajevo · Bosnia-Herzegovina
T +387 33 255-405 · F +387 33 255-401
obadria@bih.net.ba · www.ottobockadria.com.ba

Otto Bock Bulgaria Ltd.
41 Tzar Boris III Blvd. · 1612 Sofia · Bulgaria
T +359 2 80 57 980 · F +359 2 80 57 982
info@ottobock.bg · www.ottobock.bg

Otto Bock Suisse AG
Luzerner Kantonsspital 10 · 6000 Luzern 16 · Suisse
T +41 41 455 61 71 · F +41 41 455 61 70
suisse@ottobock.com · www.ottobock.ch

Otto Bock ČR s.r.o.
Protetická 460 · 33008 Zruč-Senec · Czech Republic
T +420 377825044 · F +420 377825036
email@ottobock.cz · www.ottobock.cz

Otto Bock Iberica S.A.
C/Majada, 1 · 28760 Tres Cantos (Madrid) · Spain
T +34 91 8063000 · F +34 91 8060415
info@ottobock.es · www.ottobock.es

Otto Bock France SNC
4 rue de la Réunion · CS 90011
91978 Courtaboeuf Cedex · France
T +33 1 69188830 · F +33 1 69071802
information@ottobock.fr · www.ottobock.fr

Otto Bock Healthcare plc
32, Parsonage Road · Englefield Green
Egham, Surrey TW20 0LD · United Kingdom
T +44 1784 744900 · F +44 1784 744901
bockuk@ottobock.com · www.ottobock.co.uk

Otto Bock Hungária Kft.
Tatai út 74. · 1135 Budapest · Hungary
T +36 1 4511020 · F +36 1 4511021
info@ottobock.hu · www.ottobock.hu

Otto Bock Adria d.o.o.
Dr. Franje Tuđmana 14 · 10431 Sveta Nedelja · Croatia
T +385 1 3361 544 · F +385 1 3365 986
ottobockadria@ottobock.hr · www.ottobock.hr

Otto Bock Italia Srl Us
Via Filippo Turati 5/7 · 40054 Budrio (BO) · Italy
T +39 051 692-4711 · F +39 051 692-4720
info.italia@ottobock.com · www.ottobock.it

Otto Bock Benelux B.V.
Mandenmaker 14 · 5253 RC
Nieuwkuijk · The Netherlands
T +31 73 5186488 · F +31 73 5114960
info.benelux@ottobock.com · www.ottobock.nl

Industria Ortopédica Otto Bock Unip. Lda.
Av. Miguel Bombarda, 21 - 2º Esq.
1050-161 Lisboa · Portugal
T +351 21 3535587 · F +351 21 3535590
ottobockportugal@mail.telepac.pt

Otto Bock Polska Sp. z o. o.
Ulica Korolowa 3 · 61-029 Poznań · Poland
T +48 61 6538250 · F +48 61 6538031
ottobock@ottobock.pl · www.ottobock.pl

Otto Bock Romania srl
Șos de Centura Chitila - Mogoșoaia Nr. 3
077405 Chitila, Jud. Ilfov · Romania
T +40 21 4363110 · F +40 21 4363023
info@ottobock.ro · www.ottobock.ro

OOO Otto Bock Service
p/o Pultikovo, Business Park „Greenwood”,
Building 7, 69 km MKAD
143441 Moscow Region/Krasnogorskiy Rayon
Russian Federation
T +7 495 564 8360 · F +7 495 564 8363
info@ottobock.ru · www.ottobock.ru

Otto Bock Scandinavia AB
Koppargatan 3 · Box 623 · 60114 Norrköping · Sweden
T +46 11 280600 · F +46 11 312005
info@ottobock.se · www.ottobock.se

Otto Bock Slovakia s.r.o.
Röntgenova 26 · 851 01 Bratislava 5 · Slovak Republic
T +421 2 32 78 20 70 · F +421 2 32 78 20 89
info@ottobock.sk · www.ottobock.sk

Otto Bock Sava d.o.o.
Industrijska bb · 34000 Kragujevac · Republika Srbija
T +381 34 351 671 · F +381 34 351 671
info@ottobock.rs · www.ottobock.rs

Otto Bock Ortopedi ve
Rehabilitasyon Tekniği Ltd. Şti.
Mecidiyeköy Mah. Lati Lokum Sok.
Meriç Sitesi B Blok No: 30/B
34387 Mecidiyeköy-Istanbul · Turkey
T +90 212 3565040 · F +90 212 3566688
info@ottobock.com.tr · www.ottobock.com.tr

Africa

Otto Bock Algérie E.U.R.L.
32, rue Ahcène Outaleb - Coopérative les Mimosas
Mackle-Ben Aknoun · Alger · DZ Algérie
T +213 21 913863 · F +213 21 913863
information@ottobock.fr · www.ottobock.fr

Otto Bock Egypt S.A.E.
28 Soliman Abaza St. Mohandessein · Giza · Egypt
T +20 2 37606818 · F +20 2 37605734
info@ottobock.com.eg · www.ottobock.com.eg

Otto Bock South Africa (Pty) Ltd
Building 3 Thornhill Office Park · 94 Bekker Road
Midrand · Johannesburg · South Africa
T +27 11 564 9360
info-southafrica@ottobock.co.za
www.ottobock.co.za

Americas

Otto Bock Argentina S.A.
Av. Belgrano 1477 · CP 1093
Ciudad Autónoma de Buenos Aires · Argentina
T +54 11 5032-8201 / 5032-8202
atencionclientes@ottobock.com.ar
www.ottobock.com.ar

Otto Bock do Brasil Tecnica Ortopédica Ltda.
Alameda Maria Tereza, 4036, Bairro Dois Córregos
CEP: 13.278-181, Valinhos-São Paulo · Brasil
T +55 19 3729 3500 · F +55 19 3269 6061
ottobock@ottobock.com.br · www.ottobock.com.br

Otto Bock HealthCare Canada
5470 Harvester Road
Burlington, Ontario, L7L 5N5, Canada
T +1 289 288-4848 · F +1 289 288-4837
infocanada@ottobock.com · www.ottobock.ca

Otto Bock HealthCare Andina Ltda.
Calle 138 No 53-38 · Bogotá · Colombia
T +57 1 8619988 · F +57 1 8619977
info@ottobock.com.co · www.ottobock.com.co

Otto Bock de Mexico S.A. de C.V.
Prolongación Calle 18 No. 178-A
Col. San Pedro de los Pinos
C.P. 01180 México, D.F. · Mexico
T +52 55 5575 0290 · F +52 55 5575 0234
info@ottobock.com.mx · www.ottobock.com.mx

Otto Bock HealthCare LP
11501 Alterra Parkway Suite 600
Austin, TX 78758 · USA
T +1 800 328 4058 · F +1 800 655 4963
usa.customerservice@ottobockus.com
www.ottobockus.com

Asia/Pacific

Otto Bock Australia Pty. Ltd.
Suite 1.01, Century Corporate Centre
62 Norwest Boulevard
Baulkham Hills NSW 2153 · Australia
T +61 2 8818 2800 · F +61 2 8814 4500
healthcare@ottobock.com.au · www.ottobock.com.au

Beijing Otto Bock Orthopaedic Industries Co., Ltd.
B12E, Universal Business Park
10 Jiuxianqiao Road, Chao Yang District
Beijing, 100015, P.R. China
T +8610 8598 6880 · F +8610 8598 0040
news-service@ottobock.com.cn
www.ottobock.com.cn

Otto Bock Asia Pacific Ltd.
Unit 1004, 10/F, Greenfield Tower, Concordia Plaza
1 Science Museum Road, Tsim Sha Tsui
Kowloon, Hong Kong · China
T +852 2598 9772 · F +852 2598 7886
info@ottobock.com.hk · www.ottobock.com

Otto Bock HealthCare India Pvt. Ltd.
20th Floor, Express Towers
Nariman Point, Mumbai 400 021 · India
T +91 22 2274 5500 / 5501 / 5502
information@indiaottobock.com · www.ottobock.in

Otto Bock Japan K. K.
Yokogawa Building 8F, 4-4-44 Shibaura
Minato-ku, Tokyo, 108-0023 · Japan
T +81 3 3798-2111 · F +81 3 3798-2112
ottobock@ottobock.co.jp · www.ottobock.co.jp

Otto Bock Korea HealthCare Inc.
4F Agaworld Building · 1357-74, Seocho-dong
Seocho-ku, 137-070 Seoul · Korea
T +82 2 577-3831 · F +82 2 577-3828
info@ottobockkorea.com · www.ottobockkorea.com

Otto Bock South East Asia Co., Ltd.
1741 Phaholyothin Road
Kwaeng Chatuchark · Khet Chatuchark
Bangkok 10900 · Thailand
T +66 2 930 3030 · F +66 2 930 3311
obsea@ottobock.co.th · www.ottobock.co.th

Other countries

Otto Bock HealthCare GmbH
Max-Näder-Straße 15 · 37115 Duderstadt · Germany
T +49 5527 848-1590 · F +49 5527 848-1676
reha-export@ottobock.de · www.ottobock.com

Ihr Fachhändler | Your specialist dealer



Printed by:

Otto Bock Mobility Solutions GmbH
Lindenstraße 13 · 07426 Königsee-Rottenbach/Germany
www.ottobock.com

