

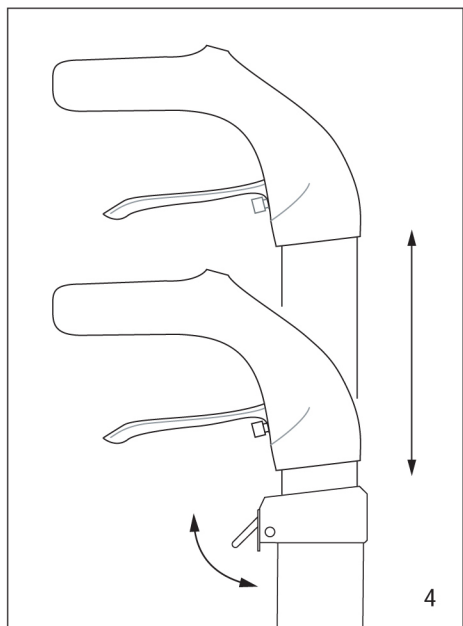

**LET'S FLY**

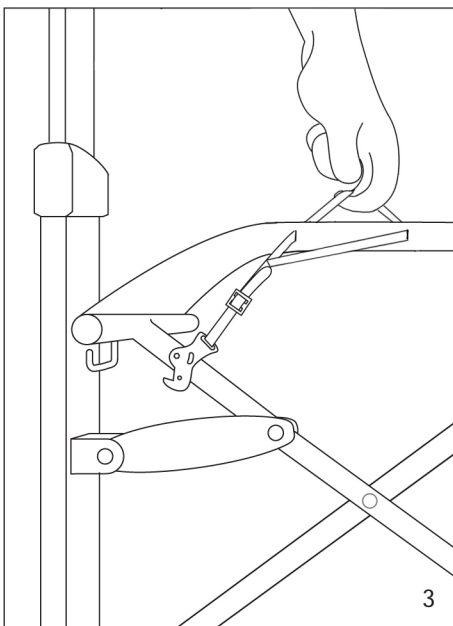
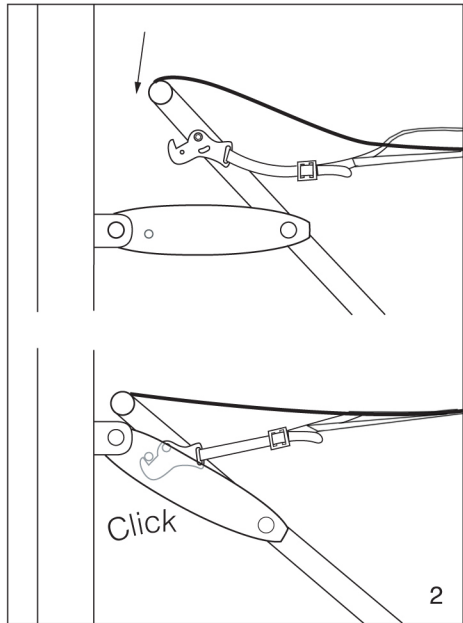
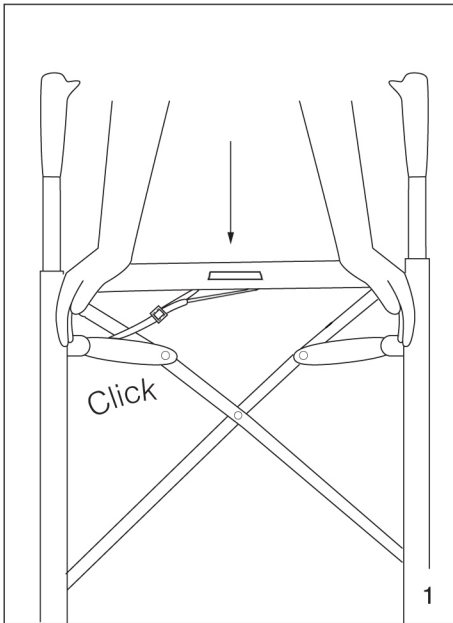

## ENGLISH

### Let's Fly Outdoor Walker.

Congratulations on the purchase of your outdoor rollator, that will make your life a little easier, more pleasant and more safe.

To make it easier for you to get familiar with your rollator it is important that you study this manual.

The rollator helps you to walk and move outdoors. You can also use it to sit on when you want to rest during a walk. If you do, always remember to activate the parking brake – position 3 on the picture to the right.

The large front wheels make it easier for you to cross curbs or other obstacles. Make sure you climb curbs in a right angle so the rollator will not be unsteady.

The seat is only designed to sit on, not for transporting children or objects. Do not put heavy objects like large boxes, pieces of furniture etc. on the seat.

The basket is available as an accessory, it can be taken off the rollator and can be used as a shopping bag. When fastened to the rollator it's suitable for bringing light objects, for example fruit, a thermos or a book.

#### Maintenance.

Clean the rollator with warm water and a small amount of detergent. Don't put the rollator in hot places or where it is very damp.

#### Warranty.

We provide a one year warranty. It does not cover wear parts like wires and wheels.

#### How to unfold.

(See pictures on page 2)

1. The rollator should be standing. Unfold the rollator by pushing the two sides apart from each other.
2. Make sure that the rollator is fully unfolded and the locking hook under the seat snaps in place.

#### How to fold.

3. Adjust both handles to the lowest position. Lift the seat in the middle and the rollator will be folded. Press the sides together if needed.

#### Handle height adjustment.

4. Pull on the two adjustment levers. Adjust the handle height and release the levers. You will hear a distinct click when the handle is locked in position.

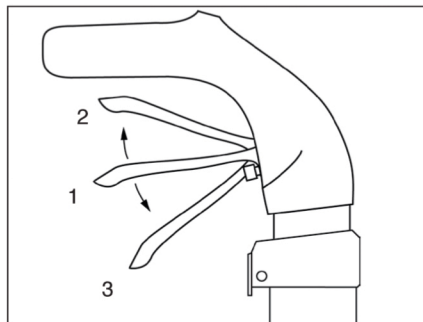

#### Brake functions.

1. In position 1 the rollator is rolling freely.
2. Position 2 is for regular braking.
3. In position 3 the parking brake is applied.

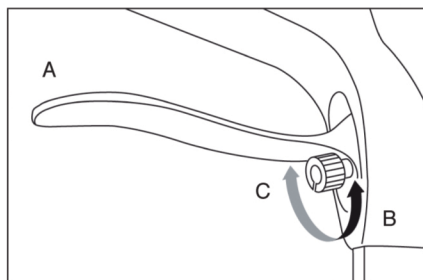

#### Brake adjustment.

1. The brakes are adjusted with the adjustment screw at the brake handle (A).
2. Adjustment of the wire tension is done by turning the adjustment screw (B-C). If the brake is too loose, turn in direction (B). If the brake is too hard turn in direction (C).

#### Technical data.

Tested according to ISO 11199-2 for a maximum user weight of 130 kg.	
Max. width	57 cm.
Length	65,5 cm.
Weight	6,8 kg.
Handle height adjustable from	78,5 - 92 cm.
Seat height	60 cm.
Front wheel diameter	245 mm.
Rear wheel diameter	200 mm.
Bag load max	12 kg.
Rear wheels with soft suspension.	



## LET'S FLY ACCESSORIES



Backrest, Art. nr 0123.



Foot Lever, Art. nr LF327



Lights, Art. nr 0162



Bag, Art. nr LF303.



Tray, Art. nr 0381



Travel bag, Art. nr 0155



Bag hook, Art. nr LF316



Crutch holder, Art. nr 0382.