

# iLevel® Retrofit Installation Instructions



These instructions explain how to retrofit a Q6 Edge 2.0 or Q6 Edge 3 power base, with or without seating, to include the iLevel® system. Instruction is limited to the specific iLevel® configuration. Some seating components from the previous seat, such as seatback components, leg rests and armrests, will be disassembled and reused. The following illustrations and parts may vary from your actual configuration. If you require any assistance with these instructions, please call **Quantum Technical Service** at **1-877-800-1248**.

**NOTE:** This unit requires an AAM. If the existing seating does not have an AAM, please contact technical service for replacement instructions.



**WARNING!** The retrofit kit should only be installed by an authorized service technician. It is strongly recommended that a second person assist with the installation.

## iLevel® Specific Components

**Anchor Brackets**

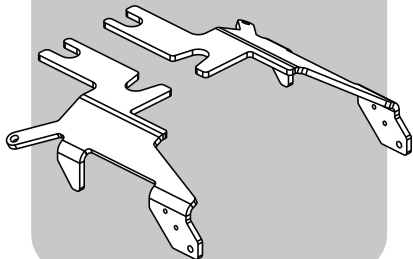

**iLevel® Base Harness**

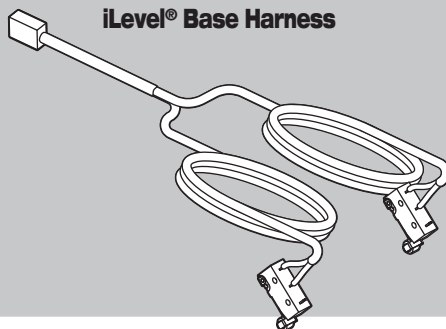

**Cable Guides & Retainers**

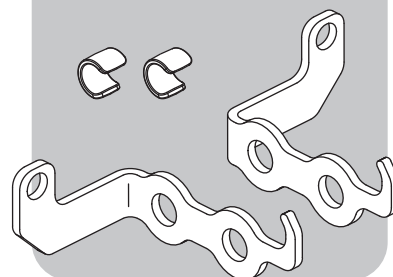

**Suspension Enhancers**

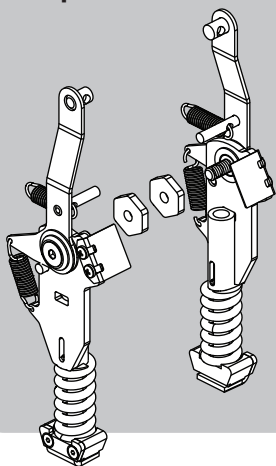

**Lift and Tilt Assembly with Hardware**

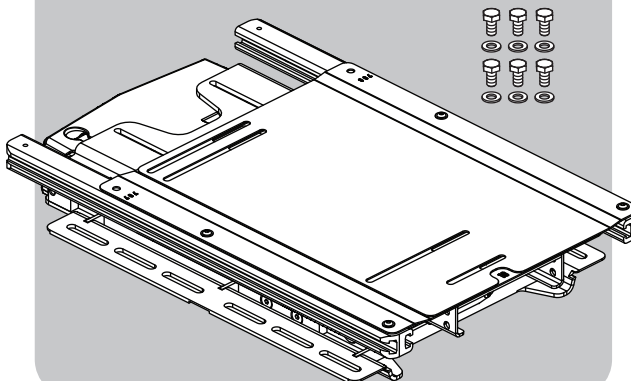

**Intermediate Harness**

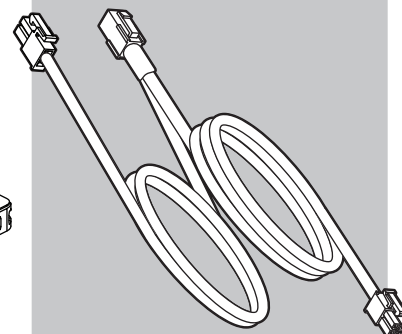

**Switch Cover Plates and Screws**

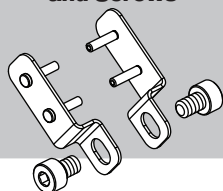

**TRU-Balance® 3 Spine Back Hardware**

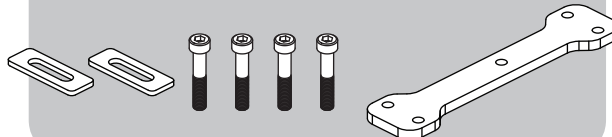

**Back Drive Board**

Not used when equipped with Q-Logic 3 electronics.

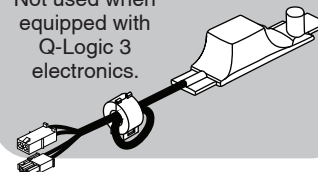

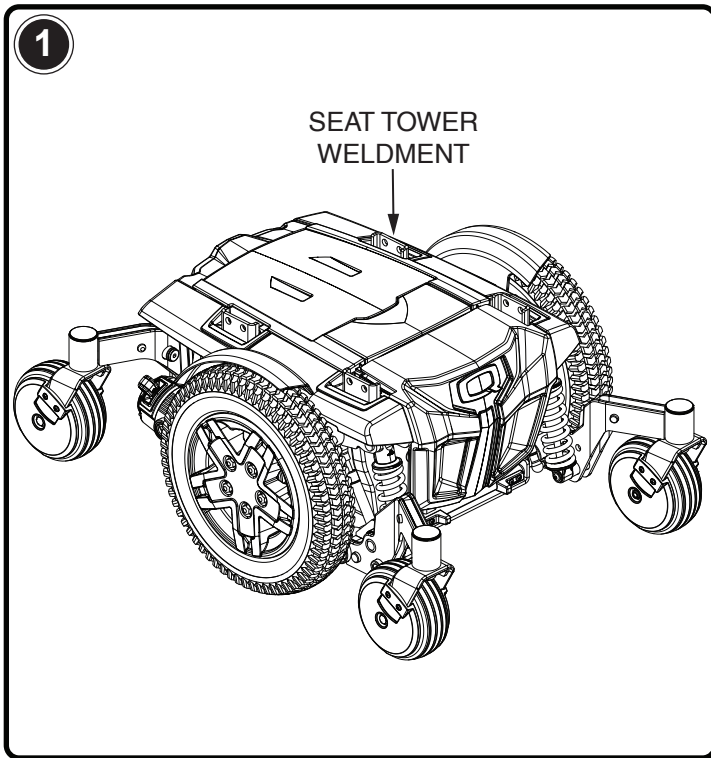

Ensure the controller is off and the power chair is in drive mode. Remove the current seat and the seat towers. Disassemble components of the seat that will be reused in the retrofit.

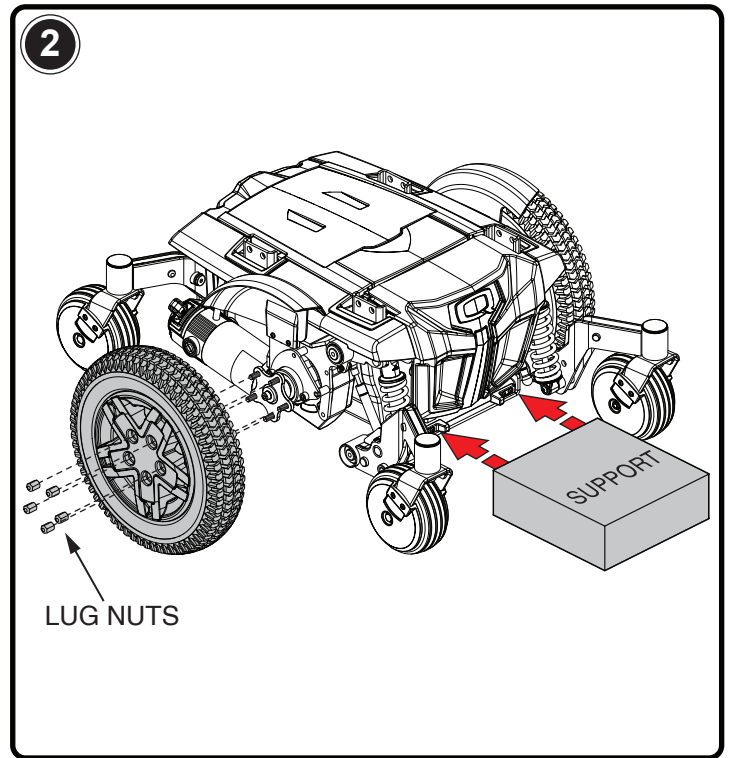

Place supports under the power base frame to elevate the drive wheels and remove the left and right drive wheels.

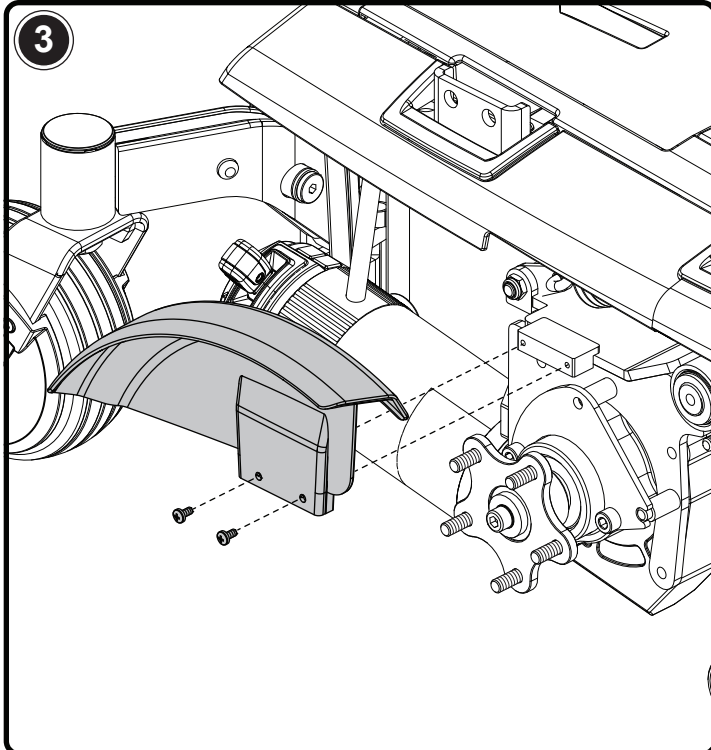

Remove the left and right fenders by removing the two screws.

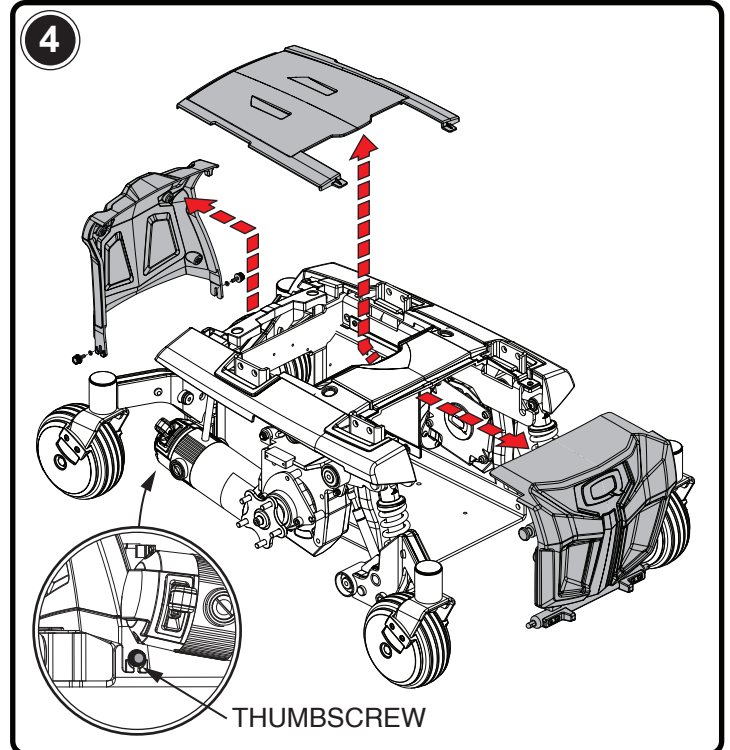

Remove the rear access door by loosening the thumbscrews, then remove the top shroud and front access door.

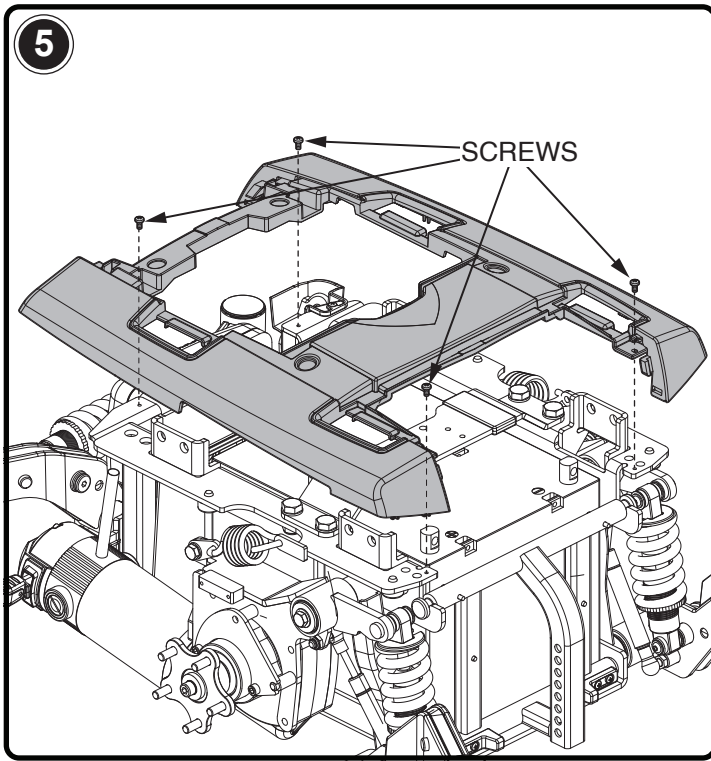

Remove the remaining shroud by removing the four (4) screws.

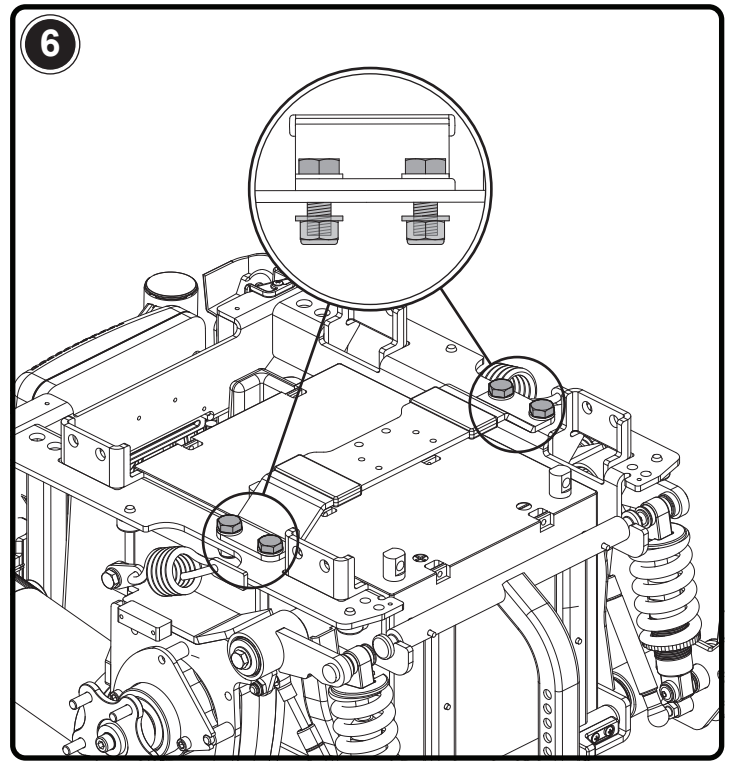

Loosen the four (4) crossbar bolts. Do not remove the nut at the bottom of the bolt.

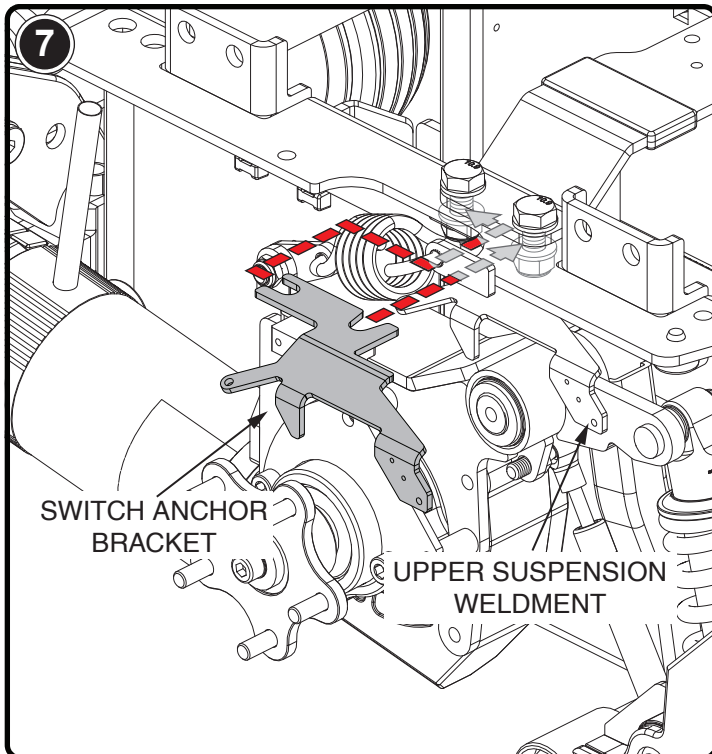

Mount the left and right switch anchor brackets to the cross bar bolts under the frame. Ensure the bracket is parallel to and does not touch the upper suspension weldment. Tighten the crossbar bolts to 35 N • m (25 ft • lbs)  $\pm$  10%.

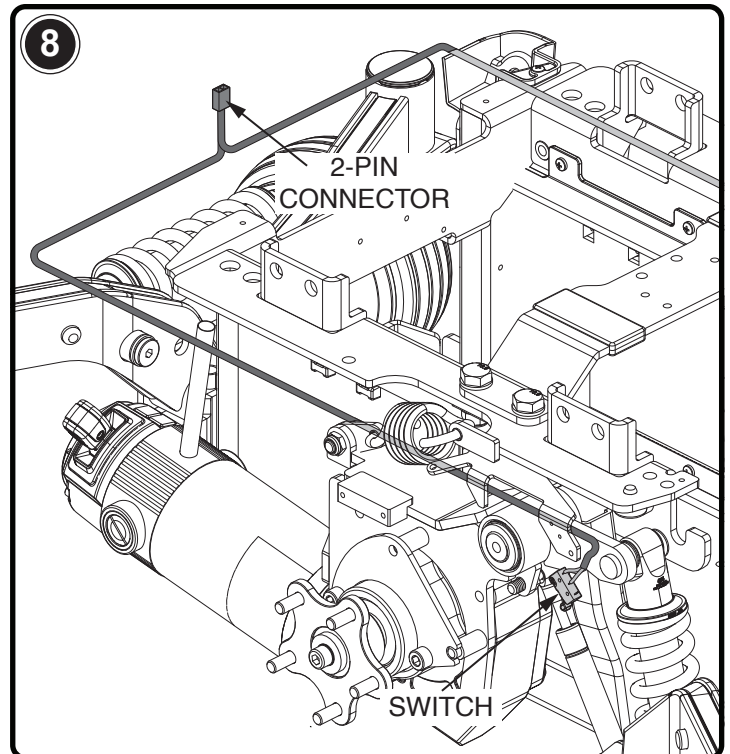

While keeping the 2-pin connector at the rear of unit, route switches of the iLevel® harness from rear of base, over and behind the motor suspension spring, under and to the front of the switch anchor brackets. One switch on left and one on right.



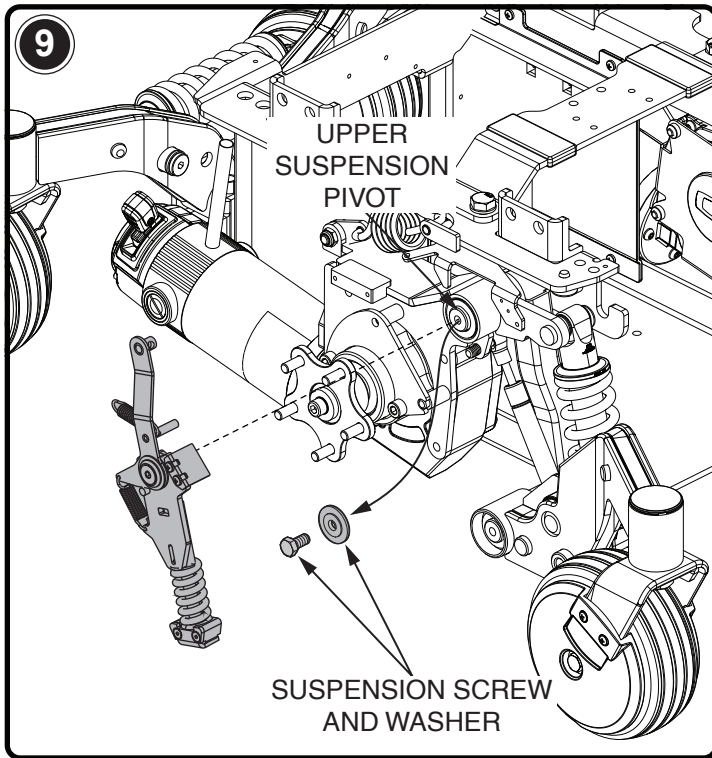

Remove the hex head bolts and washers from the left and right upper suspension pivots. Mount the left and right suspension enhancer assemblies to the upper suspension pivots. Torque the bolt to 25 - 30 N • m (18.4 - 22 ft • lbs). The parts should be snug against the head of the bolt and should have free movement.

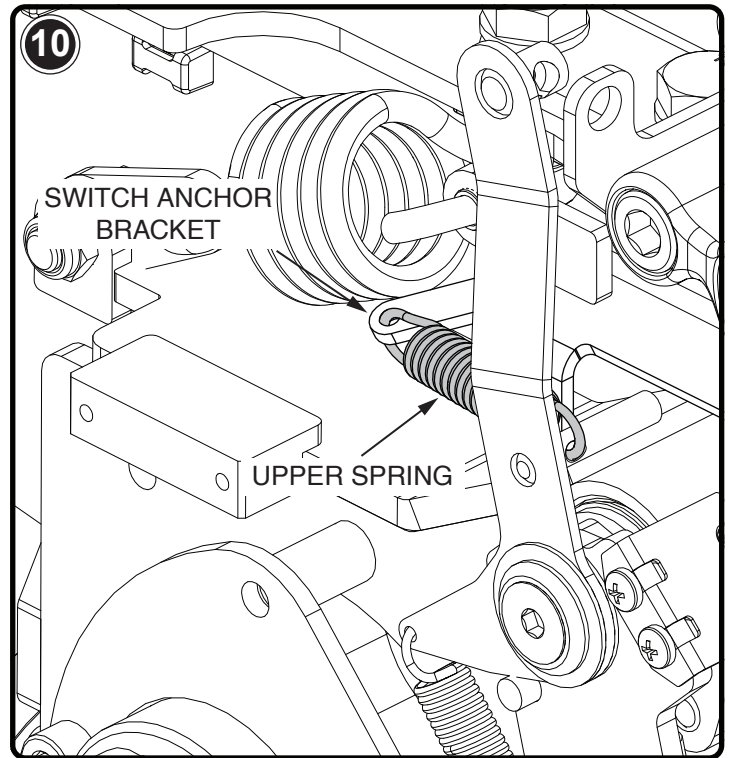

Attach the left and right upper springs to the switch anchor brackets.

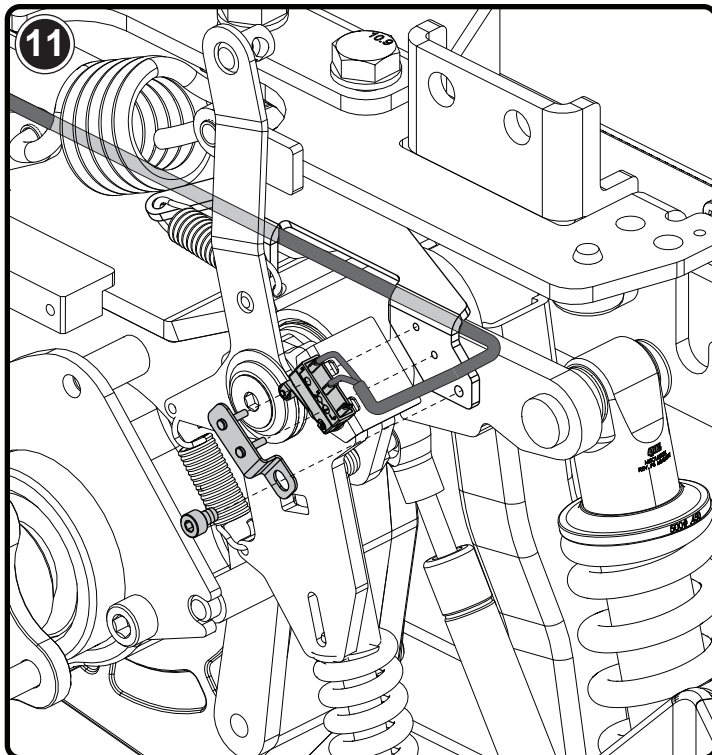

Secure the switches with the switch cover plate and screw. Use wire ties to secure the loose wire of the iLevel® harness to the motor harnesses.

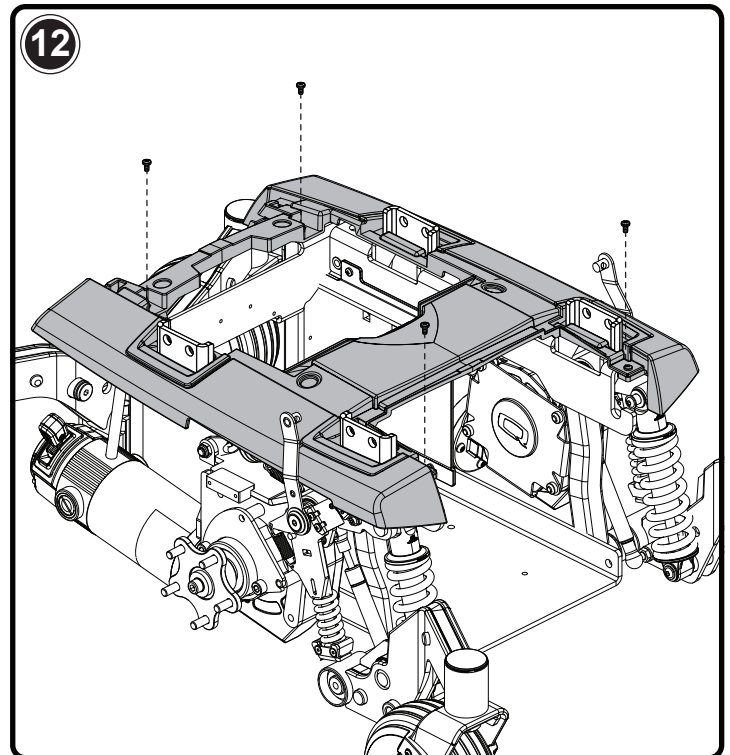

Reassemble the top shroud with the four (4) screws.

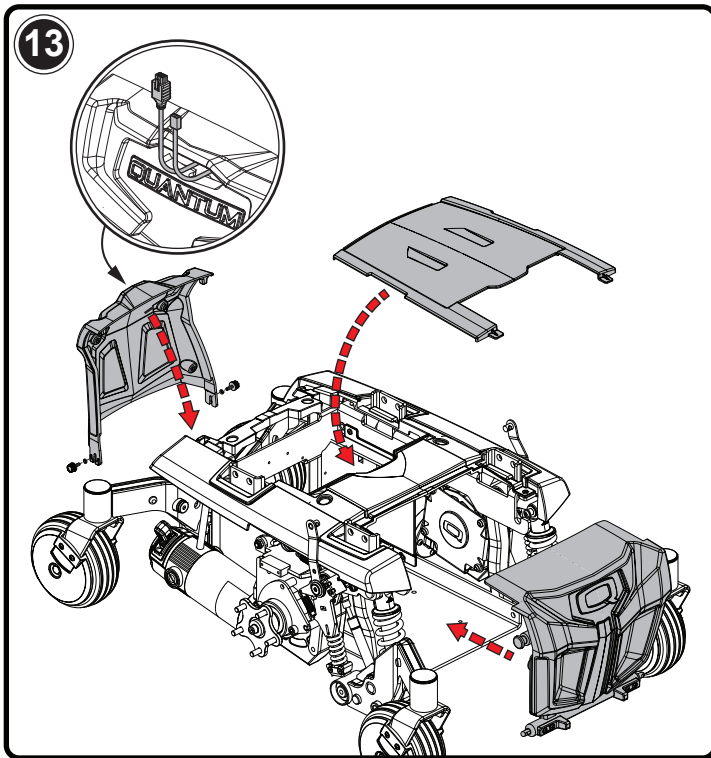

Reassemble the front, rear, and top shrouds. Ensure that the bus cable and iLevel® harness are routed through the opening of the rear shroud.

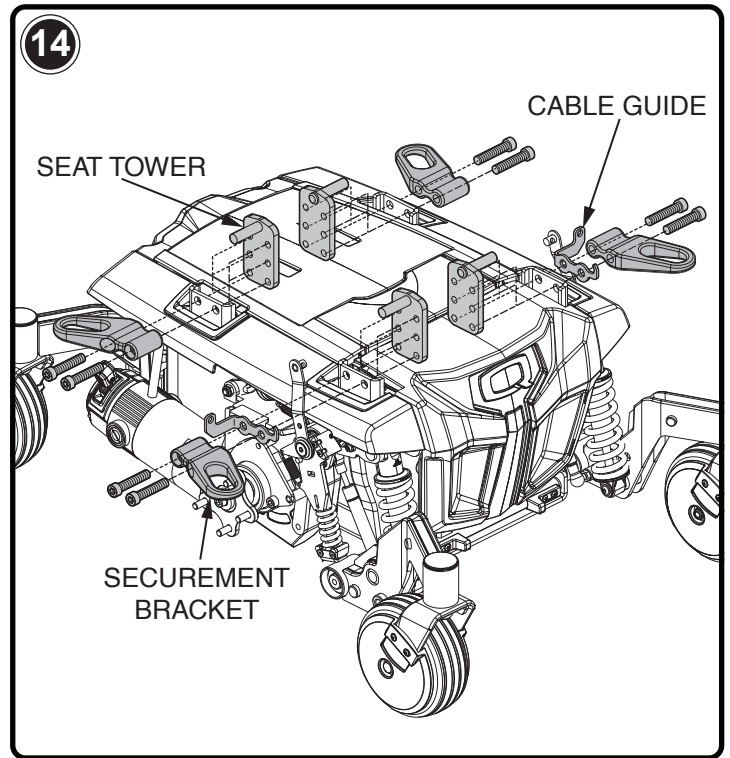

Mount the seat towers, securement brackets, and the left and right cable guides to the power base. Please note their proper orientation. Torque to  $35 \text{ N} \cdot \text{m}$  ( $26 \text{ ft} \cdot \text{lb}$ )  $\pm 10\%$ .

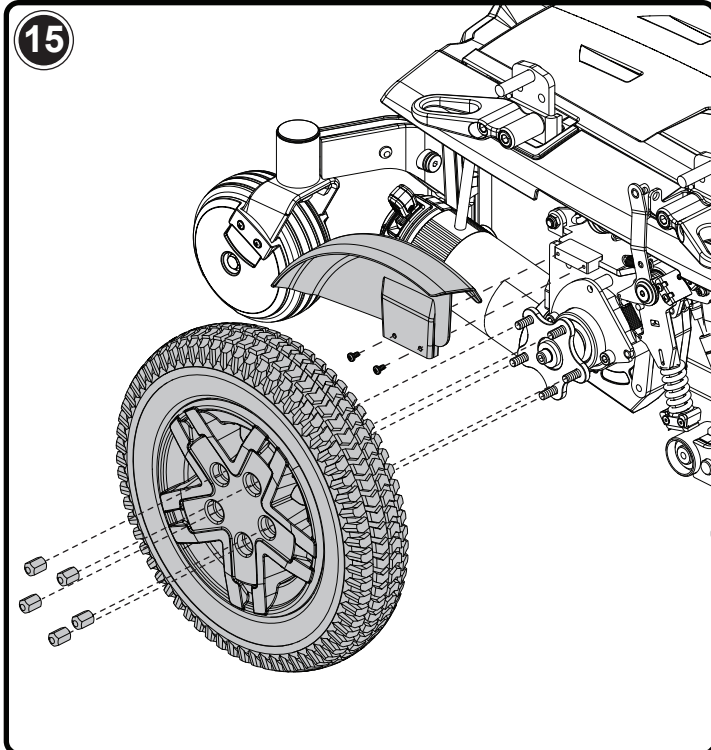

Reassemble the left and right fenders and then the left and right wheels. Torque the lug nuts to  $27 \text{ N} \cdot \text{m}$  ( $20 \text{ ft} \cdot \text{lb}$ )  $\pm 10\%$ .

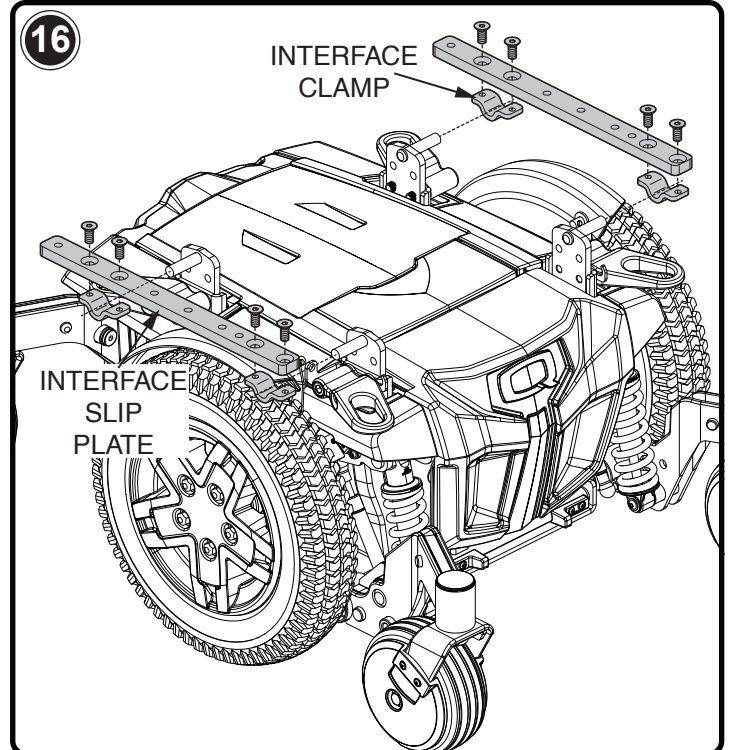

Mount the slip plate interface to the seat towers. Leave slightly loose to allow the lift and tilt assembly to be lined up. Fully tighten at end of Step 17.



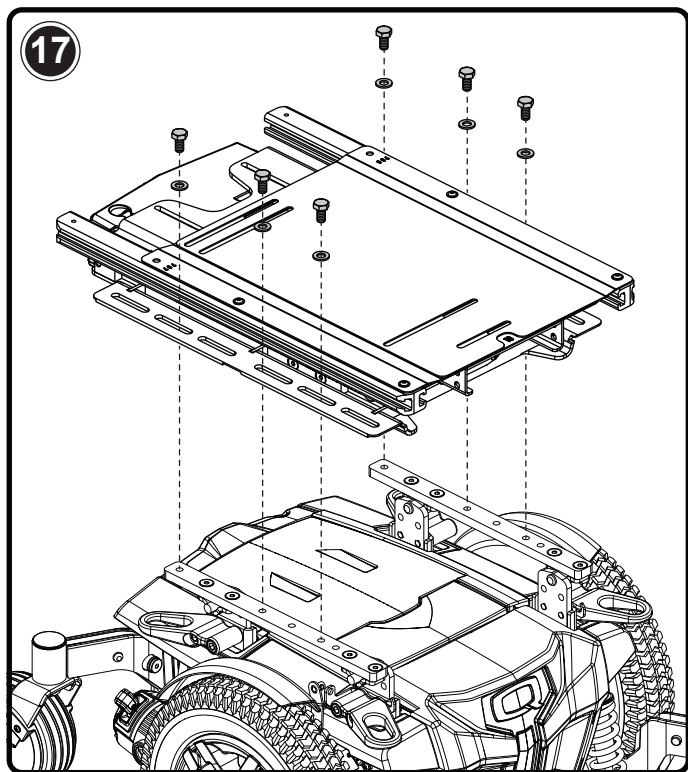

Place the lift and tilt interface onto the slip plate interface. Hand thread hex head bolts and washers through the lift and tilt assembly and into the slip plate interface. Torque the flat head screws on the slip plate interface to  $17.6 \text{ N} \cdot \text{m}$  ( $13 \text{ ft} \cdot \text{lb}$ )  $\pm 10\%$ .

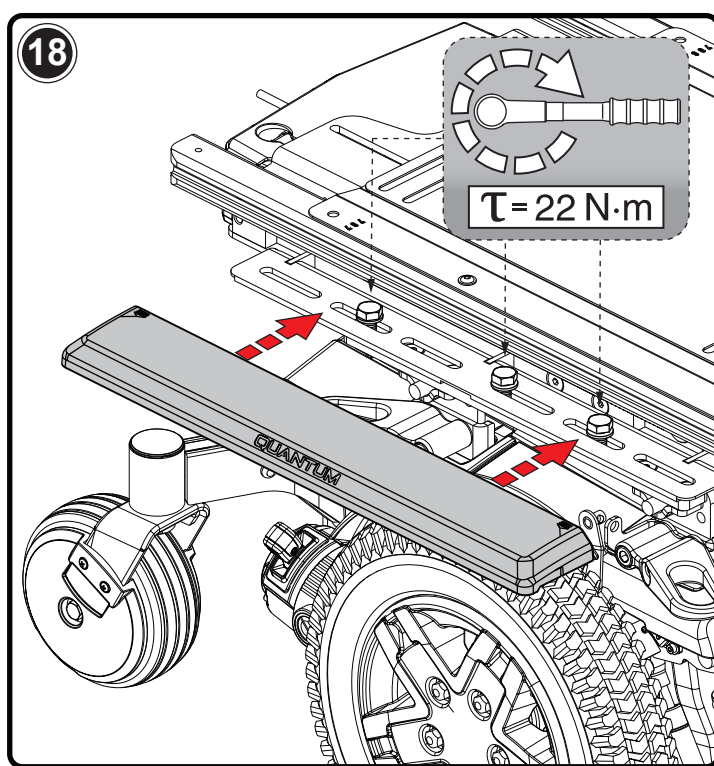

Make center of gravity adjustments. Torque the hex bolts to  $22 \text{ N} \cdot \text{m}$  ( $16 \text{ ft} \cdot \text{lbs}$ )  $\pm 10\%$ . Place the lift interface covers on the left and right sides of the lift base.

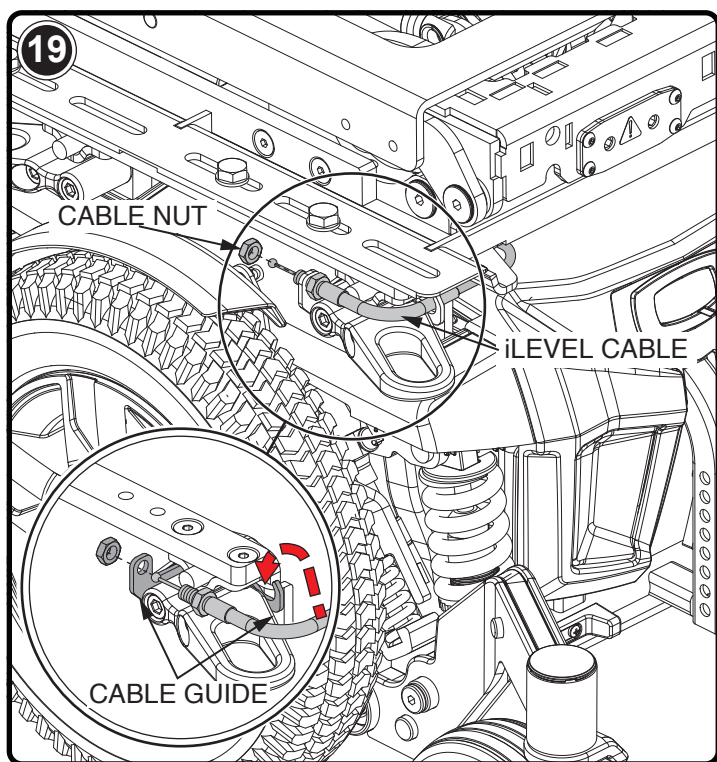

Remove the nut from the end of the iLevel® cable. Remove any slack from the cable. Route the left and right cables through the front of the left and right cable guides and into the hole of the cable guide. Secure the cable with the initially removed nut.

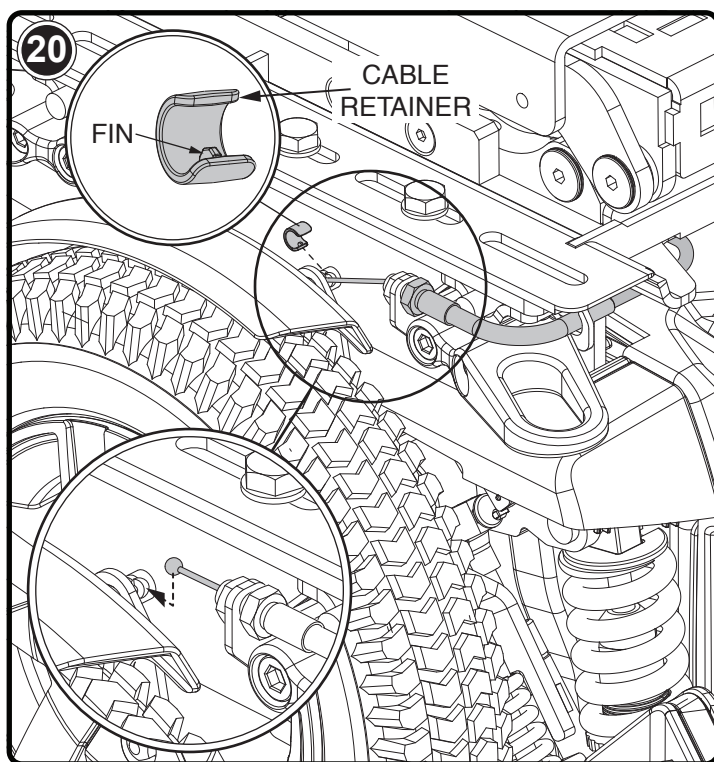

Put the ball end of the iLevel® cable into the receiver of the suspension enhancer. Place the cable retainer over the cable. The fin of the retainer should fit into the slot of the suspension enhancer.

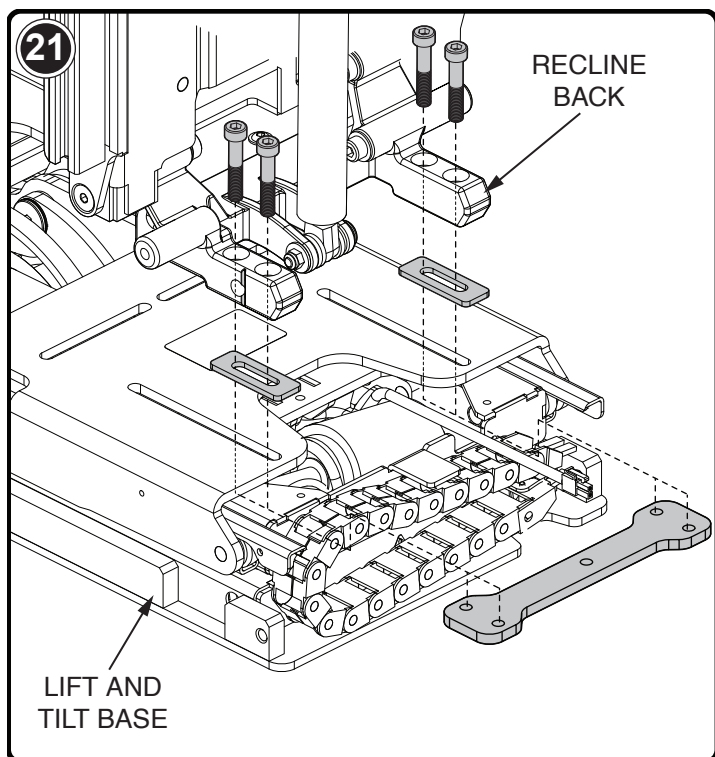

Reassemble all back hardware. If the back assembly is siderail mounted, attach to the siderails. If the back is center mounted, new hardware may be used to secure the back to the lift frame. Torque to 22 - 26 N • m (16 - 19 ft • lb).

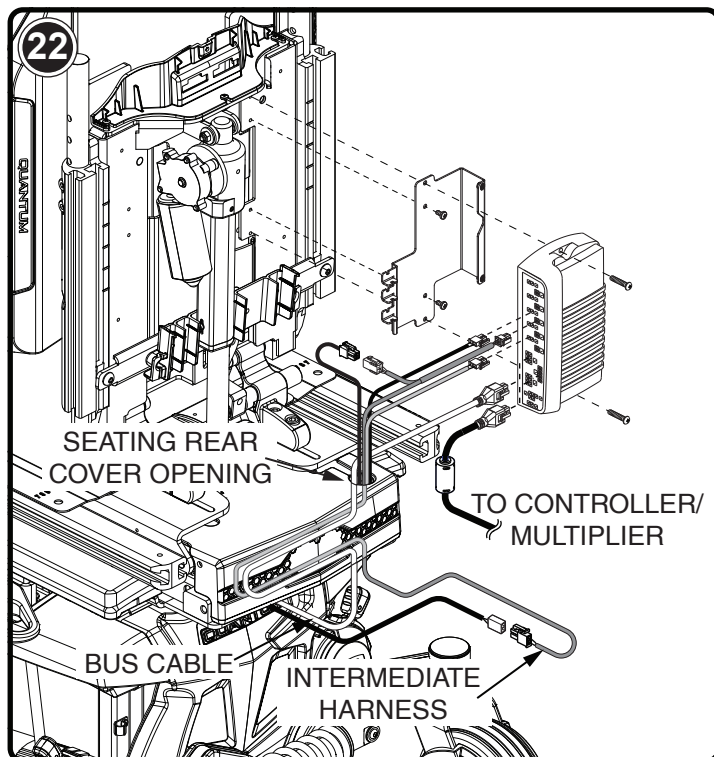

Route the 2-pin connector of the iLevel® intermediate harness, ELE145770, and the bus cable through the cable track and through seating rear cover openings. Elevating the seat gives easier access to the cable track. Connect the bus cable to the AAM.

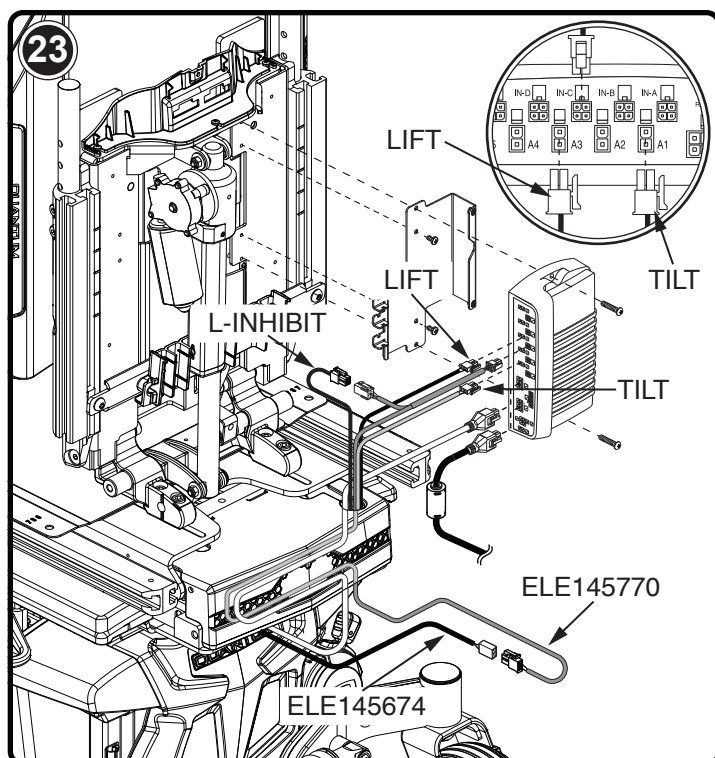

Connect the iLevel® base harness, ELE145674, into intermediate harness, ELE145770. Connect the intermediate harness into the IN-C port on the AAM. Connect the lift harness, labeled L-Inhibit, into ELE145770.

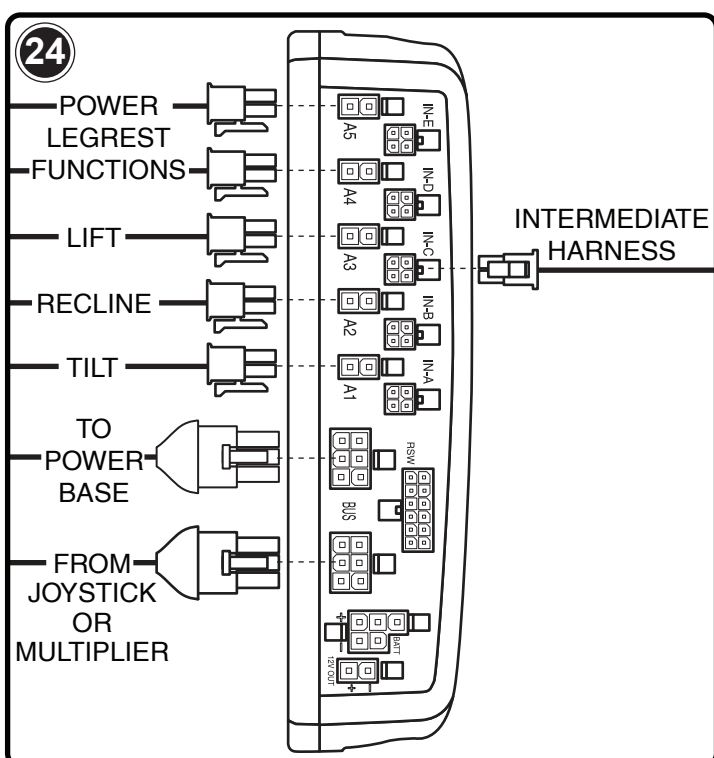

The AAM is shown with possible harnesses for reference. Ensure all wires are free from pinch points.

25

Reassemble all components and ensure all connections and hardware are secure. Verify all harnesses are reconnected.

The chair will need to be programmed with the latest power base and iLevel® seat programs located at [www.prideprovider.com](http://www.prideprovider.com).

Perform a complete function check before using the power base and seating. Ensure all hardware is fully secure.

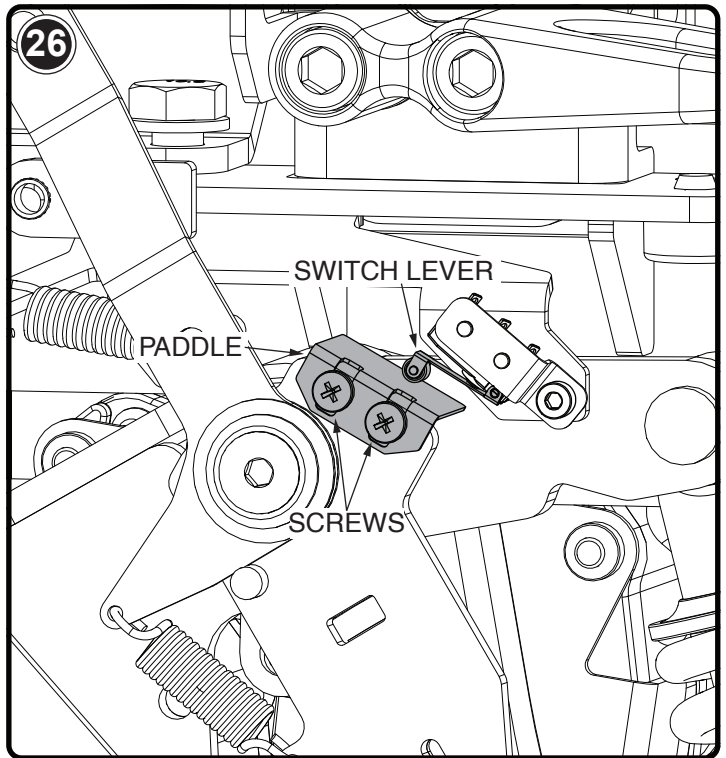

Verify that the switch makes full contact with suspension enhanced paddle when the seat is elevated. If adjustment is needed, loosen the screws and adjust the paddle. Retighten the screws.