

Icon™ Back System / JUNIOR Back Support

WITH VARILOCK™ HARDWARE

Instruction Manual

Important Note for Dealers:

Please provide the User or Caregiver with this manual.

Supplier:

Please ensure the user of this wheelchair cushion receives and understands this important product information.

Product Covered in this Manual

Icon™ Back Low, Icon™ Back Mid, Icon™ Back Tall, Icon™ Back Deep, JUNIOR Mid Back Support and JUNIOR Deep Back Support

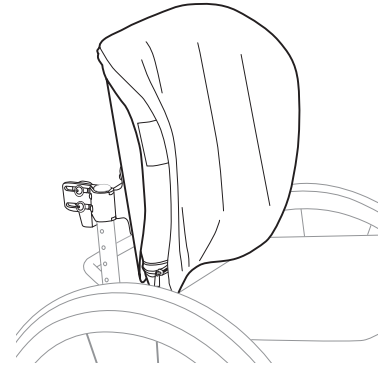

Intended Use and Contraindications

The Icon and JUNIOR back supports are designed for wheelchair users and are intended to be fitted to wheelchairs. These back supports provide support and positioning to the trunk and pelvis and reduce pressure on the spine.

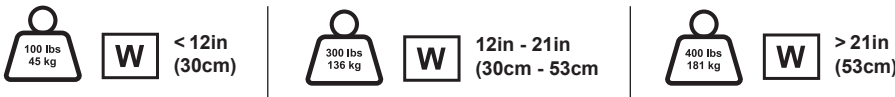

For use with round canes 1 inch (25 mm), 7/8 inch (22 mm) or 3/4 inch (19 mm) in diameter.

Important Warning and Safety Information

VARILITE products should be selected, configured and prescribed by a seating professional who is experienced in seating and positioning, and is capable of determining if the product is suitable for an individual's specific needs. The intended use statement alone is not sufficient to make this determination.













TO AVOID INJURY, read, understand and follow all instructions and warnings in this manual before using your VARILITE product.

There are hazards associated with the use of wheelchairs and adaptive equipment. If you misuse your wheelchair or your back support you can be seriously injured.

⚠ WARNINGS

- Installation, adjustment and any modification of your VARILITE back support should be performed only by a qualified seating professional.
- Ensure the cushion and cover are free of foreign objects that could damage the cushion or cause increased localized pressure.
- Never use your VARILITE back support if any hardware is missing, malfunctioning, or broken. Seek qualified assistance with any repairs or adjustments.
- Never exceed the weight capacity of the wheelchair as specified by the manufacturer.
- Never exceed the weight capacity of the back support.
- Never perform weight training or other activities of daily living that cause you to exceed the weight capacity of the wheelchair.
- Never lift the wheelchair by the back support.
- Never store your back support in conditions of extreme heat or expose to direct sunlight for long periods of time. Back support surfaces may become extremely hot if left in the sunlight or in a hot car.
- Never use the back support without its cover. Using the back support without its cover increases the risk of flammability. When the cushion and cover are used together, VARILITE back supports have met the flammability requirements of ISO 7176-16 and ISO 8191-1.
- Never leave Slide Caps in the open position. Doing so may allow the Slide Brackets to disengage from the Holsters, causing the back support to fall off of the wheelchair. This can result in serious injury. causing the back support to fall off of the wheelchair. This can result in serious injury. *Fig. A*

Symbol Glossary

	Weight Limit
	Warning / Caution
	Authorised Representative in the European Union
	Width of product
	Depth of product
	Bottom or inferior orientation of product
	Front or anterior of product
	Back or posterior of product
	Manufacturer
	Date of Manufacture
	Consult Electronic Instructions for Use
	Solution consisting of minimum 70% Isopropyl Alcohol.

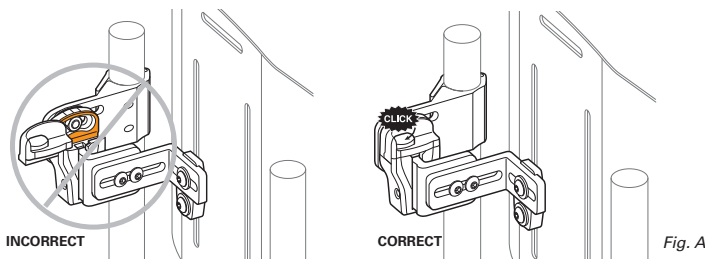

MOTOR VEHICLE TRANSPORTATION SAFETY WARNING:

- ⚠ It is safest to transfer out of your wheelchair and into a manufacturer-installed vehicle seat, and use the vehicle's crash-tested occupant restraint system. Failure to use the appropriate equipment for restraint in a vehicle can result in serious injury or death.
- The ANSI RESNA WC-20 and ISO 16840-4 standards are not considered applicable to individual seating system components. These standards address complete seating systems consisting of a seating surface and a back support used together in a specific configuration.
- An 18" wide Icon Tall back support and an 18" wide by 18" deep Evolution™ seating system were configured onto a surrogate wheelchair frame and successfully crash tested according to the test specified in ANSI RESNA WC-20.
- A risk assessment should be performed by competent seating professionals in the case that a provider wishes to configure VARILITE products for use during transportation in a motor vehicle.

⚠ CAUTIONS

- The Icon Back Mid and Icon Back Tall are compatible with the VARILITE PAL and Fixed Lateral Supports. If your back support was configured with lateral thoracic supports (Laterals), see the instructions for use that came with the laterals for specific safety and operation information.
- To ensure optimal cushion performance and foam integrity, VARILITE recommends that you leave the valve open and allow your VARILITE back cushion to fully inflate overnight at least once a week. Repeat the "Cushion Setup and Adjustment" procedure when you are ready to use it again.

Product Detail and Specifications

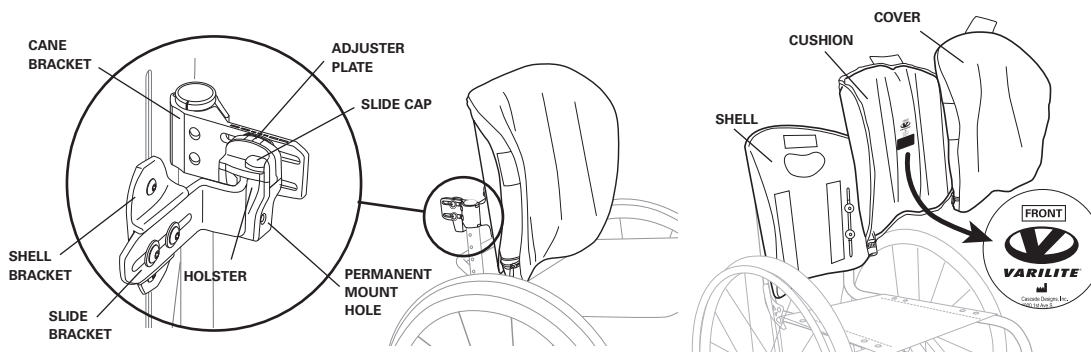

Materials used in the construction of VARILITE back support:

VARILITE does not use latex or phthalates anywhere in the construction of our products.

Back Support Operation

REMOVAL

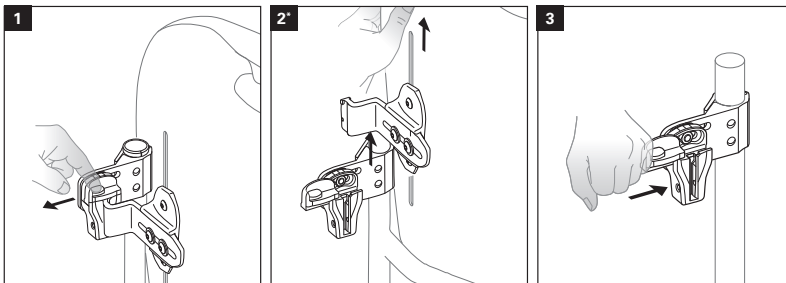

*NOTE: When Permanent Mount Screws are engaged, Slide Brackets cannot be removed from the Holster

INSERTION

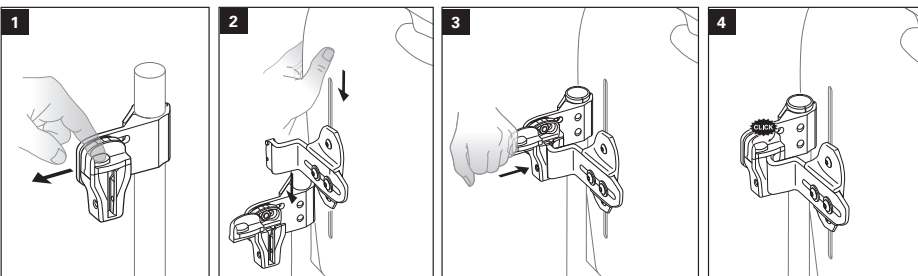



CUSHION SETUP AND ADJUSTMENT:

Inflating Cushion:

1. To inflate cushion, remove load from cushion.
2. Open air valve by turning valve counterclockwise.
3. When cushion is fully inflated, close air valve by turning valve clockwise.

Adjusting Cushion:

1. To adjust the air level of the VARILITE back support cushion, begin with the cushion fully inflated and the valve closed.
2. Position yourself securely in your wheelchair.
3. Turn the valve counterclockwise to open the valve and release air.
4. Close the valve when the most comfortable and supportive position is achieved.

Removing Cushion:

1. Pull the cushion up to detach the cover from the shell.
2. Detach the handle flap from the handle patch inside the shell and pull the flap through the slot in the shell.
3. Remove the back cushion from the attached flap on the inside of the cover.

Note: Installation is the reverse of removal.

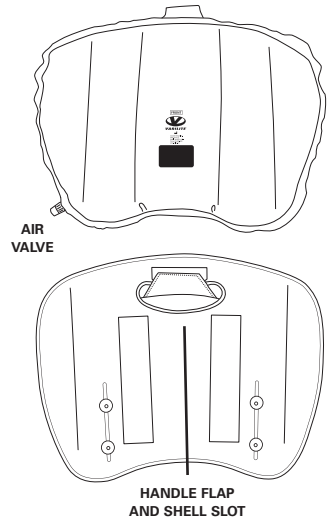

TROUBLESHOOTING



For additional assistance, please see the Icon Back System and JUNIOR Back Support Installation Guide or contact VARILITE customer service.

CLEANING AND DISINFECTION



Warning: Do not use quaternary ammonium-, chlorine- or hydrogen peroxide-based products to disinfect your back support. These products can damage your back support.



Disinfectants are NOT effective on porous surfaces such as foam or wood. If necessary, they may be cleaned by hand wiping with a damp cloth. They cannot be effectively disinfected and must NOT be used by different individuals.



VARILITE recommends a minimum 70% solution of isopropyl alcohol for use as a disinfectant.

When cleaning and disinfecting the shell, avoid getting liquid underneath the edge trim.

Cover Cleaning and Disinfection Procedure:

See laundering symbols in this document and on care and use tag.

Cushion Cleaning and Disinfection Procedure:

1. Hand wash cushion under hot tap water (40C) until all visible soil is removed from the cushion. Use mild liquid dish soap if needed. Repeat if necessary.
2. Rinse the cushion thoroughly, so that the soap is completely removed from the cushion.
3. Let cushion dry for at least 30 minutes.
4. Spray entire cushion with 70% Isopropyl alcohol (IPA) ensuring that the entire pad is saturated.
5. Let cushion dwell with 70% IPA for 10 minutes.
6. Repeat steps four and five once more.

Ensure cushion is fully dry before resuming normal use.

Shell Cleaning and Disinfection Procedure:

1. Hand wash shell with hot tap water (40C) until all visible soil is removed. Use mild liquid dish soap if needed. Repeat if necessary.



2. To disinfect, spray with 70% Isopropyl Alcohol, ensuring all surfaces are saturated. Maintain a 10-minute wet time. Ensure shell is fully dry before resuming normal use.

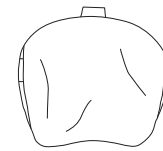

Cover Cleaning and Disinfecting Instructions



Cushion and Shell Cleaning Instructions

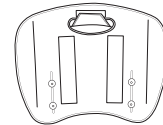

Cushion and Shell Disinfecting Instructions



TRANSPORTATION, DISPOSAL, AND RECYCLING

Should you need to ship your VARILITE product, place in a plastic bag to keep dirt and debris off the back support, and place into a cardboard shipping box.

At the end of its useful life, treat your VARILITE product as general waste and dispose of in accordance with all applicable local regulations. Contact your local recycling authority to determine if recycling options exist for the product.

MANUFACTURER AND WARRANTY INFORMATION

For VARILITE product warranty information, please refer to the dealer or distributor you purchased your product from.

Products may be covered by one or more US and international patents and trademarks, including Icon™ Back System and JUNIOR Back Support products.

In the event of a serious issue or injury, please report the incident to VARILITE customer service. Additionally, if you reside in the European Union, please notify the manufacturer or distributor, and the competent authority of the Member State in which you are established.



Information printed in this manual may have changed since this document was printed. Current information is available on our website at www.VARILITE.com.

Product Registration is available on our website at www.VARILITE.com.



Cascade Designs, Inc.
4000 1st Ave South
Seattle, WA 98134 US
Phone: (800) 827-4548
Fax: (206) 343-5795
www.VARILITE.com



MDSS GmbH
Schiffgraben 41
30175 Hannover, Germany

